

FLAT WHITE

FLAT RED (BETWEEN RIBS)

FLAT WHITE (4 SQUARES)

FLAT RED (BOTH SIDES)

FLAT RED (3 SQUARES)

FLAT RED (2 UNITS)

FLAT RED (ALL SMALL RAISED SQUARES FRONT, SIDES AND BACK)

FLAT WHITE (3 SMALL SQUARES)

FLAT RED

FLAT RED (BOTH SIDES)

DECAL 8

DECAL 4

DECAL 2

FLAT RED

FLAT WHITE (10 PANELS)

FLAT WHITE (3 PANELS)

FLAT WHITE (3 PANELS)

FLAT RED

FLAT WHITE (4 PANELS)

FLAT RED (BOTH SIDES)

FLAT YELLOW (BOTH SIDES)

DECAL 9

DECAL 3

DECAL 5

120 B
 FOR SHIP COLOR MIX EQUAL PARTS OF FS - 34227 PALE GREEN AND FS - 35622 DUCK EGG BLUE

 FLAT YELLOW = FS - 33538 INSIGNIA YELLOW
 FLAT RED = FS - 31136 INSIGNIA RED
 154 C

The ERTL COMPANY, Inc.
Highways 136 & 20
P.O. Box 500
Dyersville, Iowa 52040 - 0500
Printed in the U.S.A.

FLAT WHITE (BOTH SIDES)

FLAT WHITE (BOTH SIDES)

FLAT WHITE (BOTH SIDES)

FLAT RED (BOTH SIDES)

FLAT RED (BOTH SIDES)

FLAT RED (BOTH SIDES)

FLAT WHITE (13 PER SIDE)

FLAT RED (BOTH SIDES)

FLAT RED (BOTH SIDES)

FLAT WHITE (ALL RAISED DETAILS IN PANELS, 10 PANELS PER SIDE)

FLAT RED (BOTH SIDES)

FLAT WHITE (BOTH SIDES)

FLAT RED (BOTH SIDES)

FLAT WHITE (BOTH SIDES)

FLAT RED BETWEEN RIBS

FLAT RED (BOTH SIDES)

FLAT YELLOW (6 PER SIDE)

FLAT WHITE (BOTH SIDES)

FLAT YELLOW (BOTH SIDES)

FLAT WHITE (BOTH SIDES)

1 / 1400 Scale

TM, ® and © 1991 Paramount Pictures. All Rights Reserved. STAR TREK: THE NEXT GENERATION and KLINGON are Trademarks of Paramount Pictures. Ertl Authorized User.

When in the Midwest, please visit the ERTL Company for a tour of the AMT production facilities, 10am & 1pm weekdays. Reservations suggested.

1: BATTLE MODULE ASSEMBLY

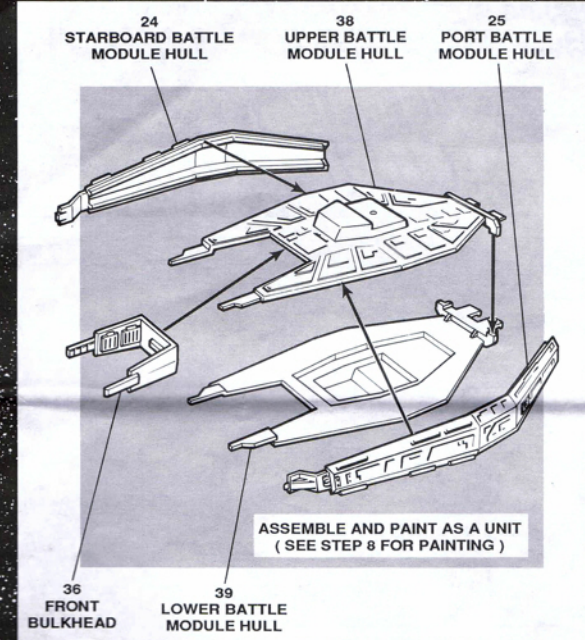

2: BRIDGE / DISRUPTER ASSEMBLY

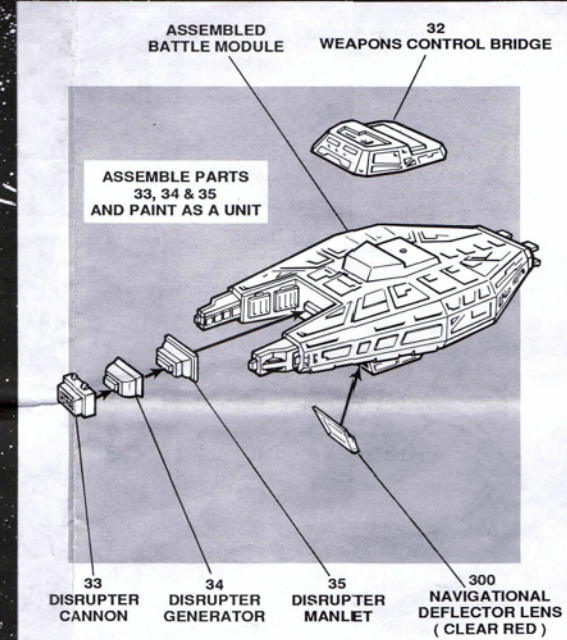

3: IMPULSE WEDGE ASSEMBLY

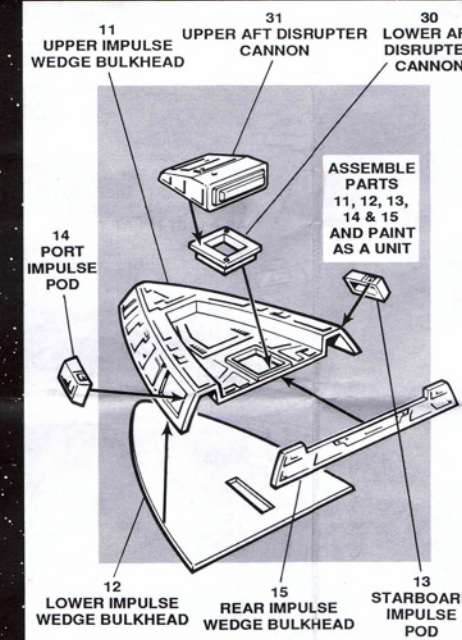

4: BRIDGE ASSEMBLY

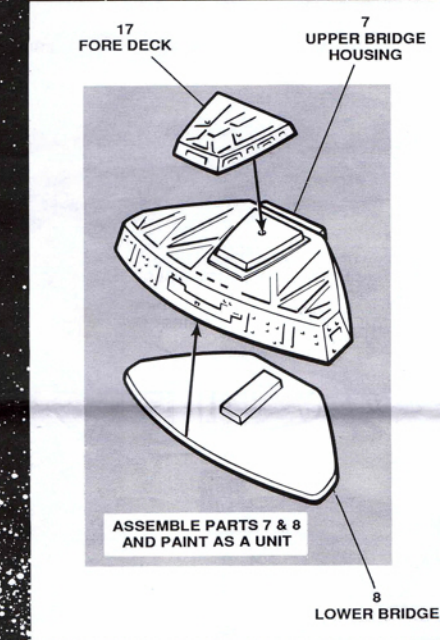

5: WARP DRIVE NACELLE ASSEMBLY

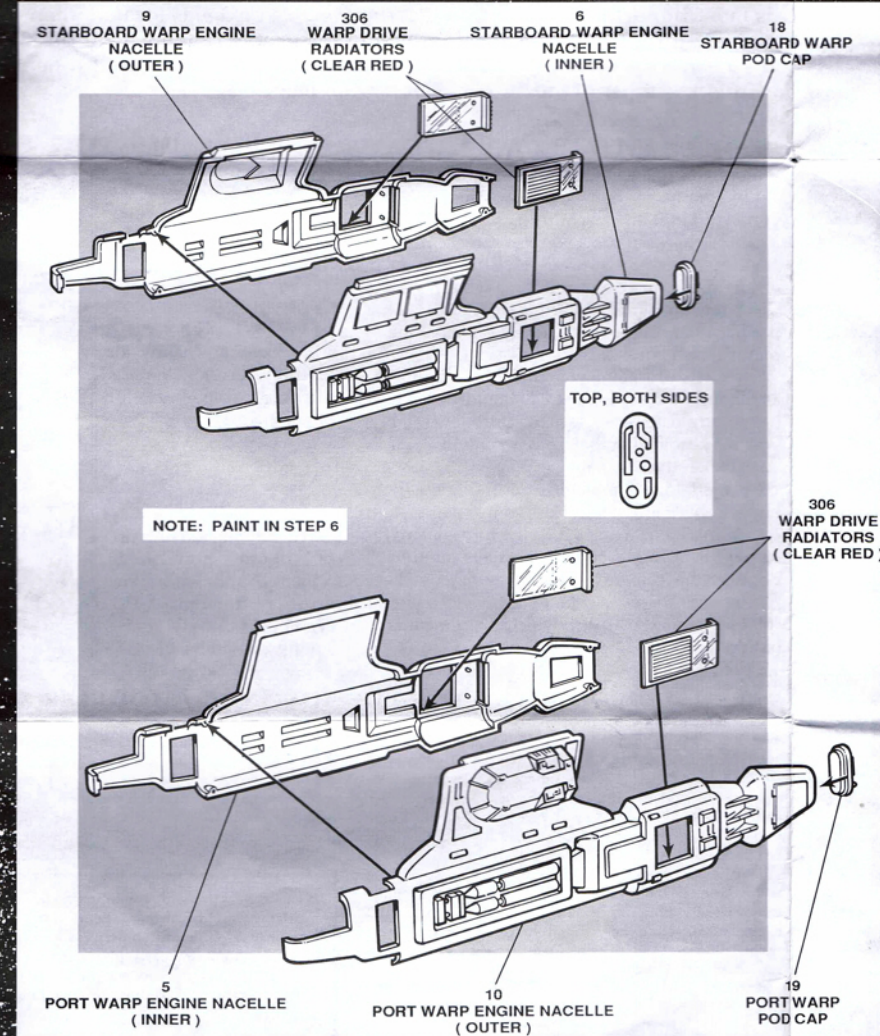

6: HULL ASSEMBLY

