

INSTRUCTION MANUAL



GAT-X105 STRIKE FIGHTER

強 襲 戦 士

DABAN
MODEL

STRIKE FIGHTER

O.M.N.I. ENFORCER MOBILE SUIT GAT-X105

ASSEMBLE INDEX

17 ARMOR-SCHNEIDER (アーマーシュナイダー)

11 SHOULDER ARMOR (ショルダーアーマー)

12+13 RIGHT ARM UNIT (右腕)

6 BODY (ボディ)

7 HEAD UNIT (頭部)

12+14 LEFT ARM UNIT (左腕)

10 GRAND SLAM (グランドスラム)

8 BEAM RIFLE (ビームライフル)

1+2+3 RIGHT LEG UNIT (右脚)

5 WAIST UNIT (腰部)

1+2+4 LEFT LEG UNIT (左脚)

17 ARMOR-SCHNEIDER (アーマーシュナイダー)

9 SHIELD (シールド)

1+2+3 RIGHT LEG UNIT (右脚) P.02~P.06

1+2+4 LEFT LEG UNIT (左脚) P.02~P.06

5 WAIST UNIT (腰部) P.06~P.07

6 BODY (ボディ) P.08~P.11

7 HEAD UNIT (頭部) P.11~P.12

8 BEAM RIFLE (ビームライフル) P.12

9 SHIELD (シールド) P.13

10 GRAND SLAM (グランドスラム) P.14

11 SHOULDER ARMOR (ショルダーアーマー) P.14

12+13 RIGHT ARM UNIT (右腕) P.15~P.16

12+14 LEFT ARM UNIT (左腕) P.15~P.16

17 ARMOR-SCHNEIDER (アーマーシュナイダー) P.17

《組裝時的注意》

- 組裝前請詳細閱讀說明書。
- 請將零件按編號整齊組裝，組裝後把邊角料丟棄。
- 零配件當中有帶尖銳或刺手的，在組裝時請小心。
- 建議在塗裝粘貼時使用安全的“水性塗料”。

NOTICE WHILE ASSEMBLING

- Please read the instruction carefully before assembly.
- Please assemble the parts as per the serial numbers and discard the leftover material after assembly.
- While assembling, please pay attention that some of the parts may be sharp-pointed or aciculate.
- Please use the safe “aqueous coating” while painting.



・粘緊 Cling



・貼紙的編號
numbers on the seals



・粘貼編號
Decal number



・反面安裝之配件
Parts installed on reverse side



・兩側安裝同樣配件
Same parts installed on both sides



・組裝時需注意方向
Pay attention to the directions when install



・注意旋緊螺絲
Attention to revolve the screw



・剪切 Cut off



・配件數量的個數
Quantity of the part



・先組裝
Earlier install



・後組裝
Later install



・結合數值旋轉
Screw base on the mark number



・選擇任一方進行組裝
Choose one side to install



・反面也是同樣轉動
Screw the same on reverse

パーツリスト

Aパーツ

(スチロール樹脂: PS)

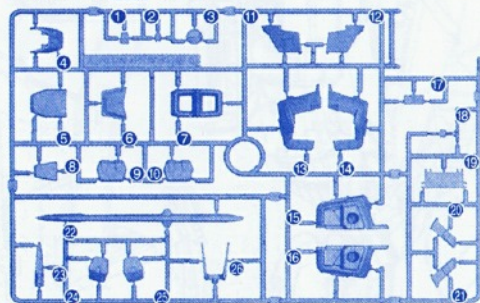

Bパーツ

(スチロール樹脂: PS)

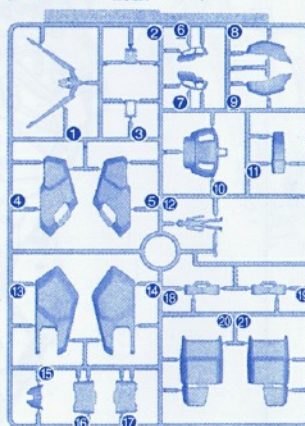

Cパーツ (×2)

(スチロール樹脂: PS)

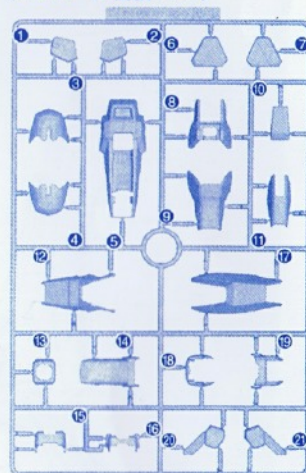

Dパーツ (×2)

(スチロール樹脂: PS)

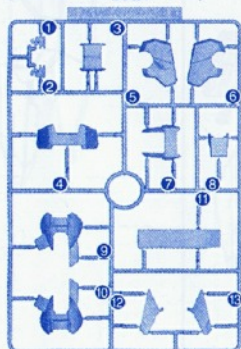

Eパーツ

(スチロール樹脂: PS)

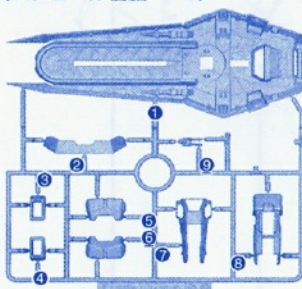

Fパーツ

(スチロール樹脂: PS)

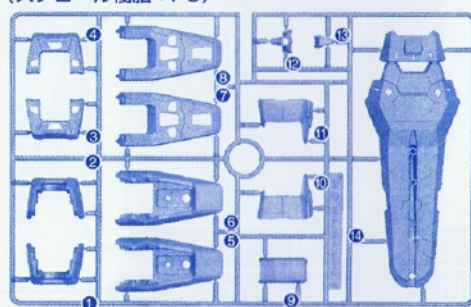

Gパーツ

(スチロール樹脂: PS)

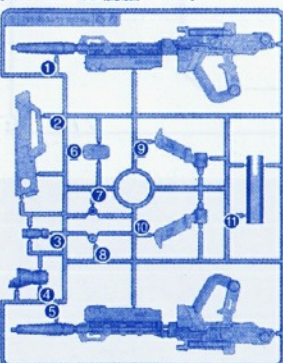

Hパーツ

(ABS樹脂: ABS)

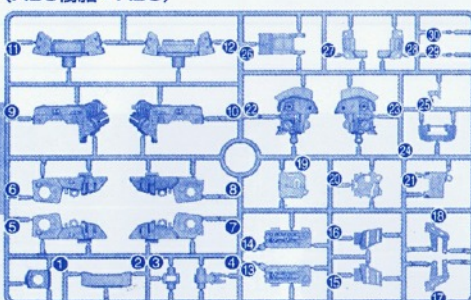

Iパーツ

(ABS樹脂: ABS)

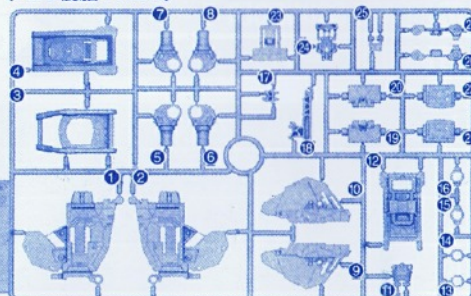

Jパーツ

(ABS樹脂: ABS)

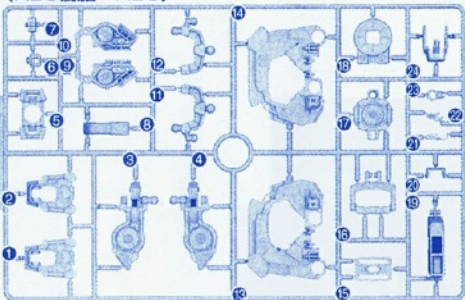

Kパーツ (×2)

(ABS樹脂: ABS)

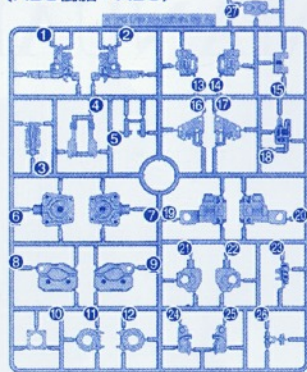

Lパーツ (×2)

(ABS樹脂: ABS)

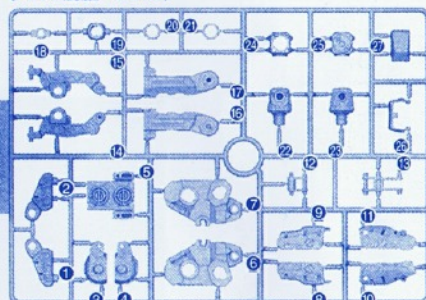

Mパーツ (×2)

(ABS樹脂: ABS)

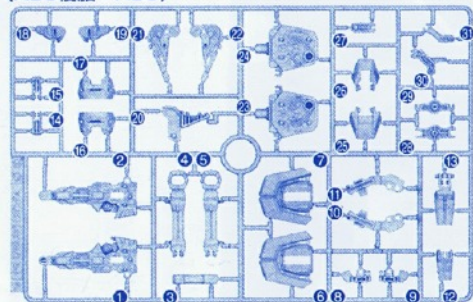

Nパーツ (×2)

(ABS樹脂: ABS)

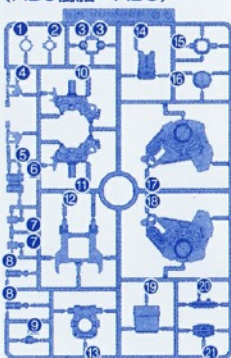

Oパーツ

(ABS樹脂: ABS)

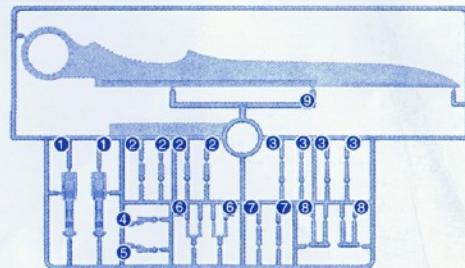

Pパーツ

(スチロール樹脂: PS)

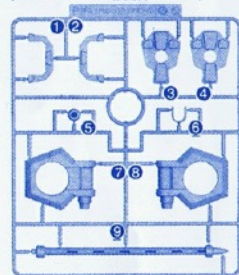

Rパーツ

(ABS樹脂: ABS)

(ポリプロピレン: PP)

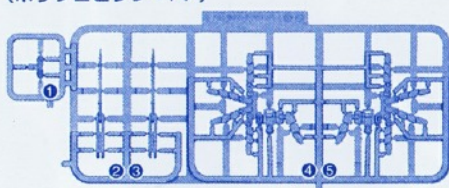

Sパーツ

(ポリエチレン: PE)

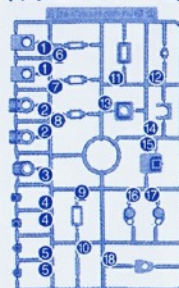

Tパーツ (×2)

(ポリエチレン: PE)

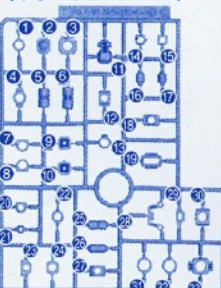

電池金具パーツ

電池金具・A

電池金具・B



発光ダイオード(YELLOW)



ダイカストA (×2)

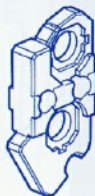

ダイカストB

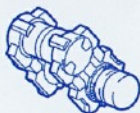

- ビスTP2×6...1
- マーキングシール...1

※発光ダイオード(YELLOW)を点灯させたい方はボタン電池(CR1220 (1個)・別売り)をご使用ください。

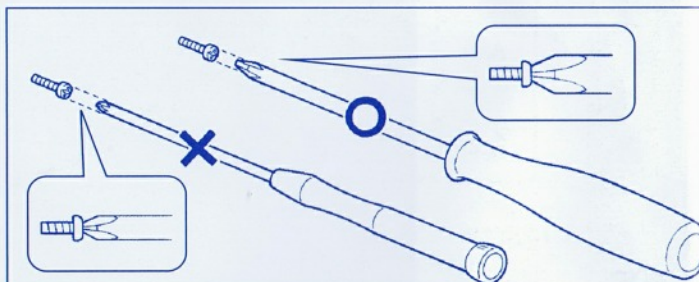

適用年齢:十五岁以上



WARNING:

CHOKING HAZARD-Small parts.
Not for children under 15 years.

中国制造



警告

- ・ 不适合六岁以下儿童使用
- ・ 含有小零件, 请勿吞食, 以免造成窒息危险;
- ・ 内有尖端物小心使用请勿刺人, 以免造成伤害;
- ・ 请在成人指导下正确使用;

1

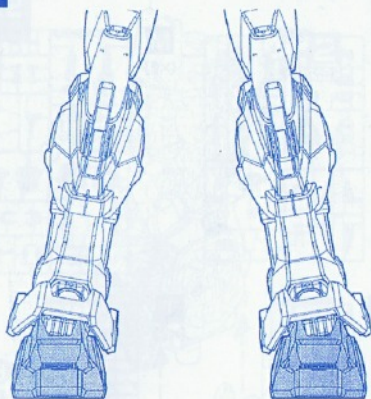

・組立 1 で使用するパーツ

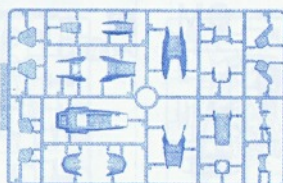
C
(x2)

F

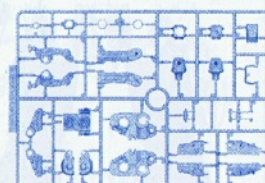
L
(x2)

O

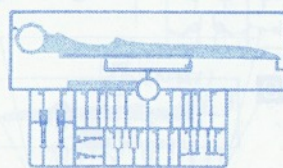

P

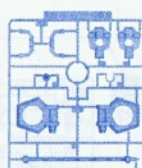
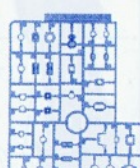
T
(x2)1
(1) x2

(向きに注意)

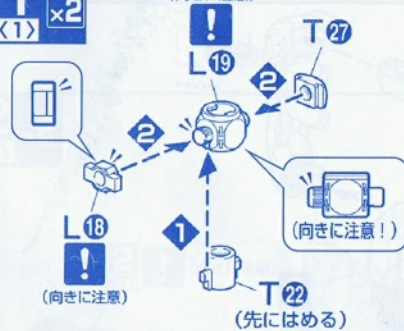
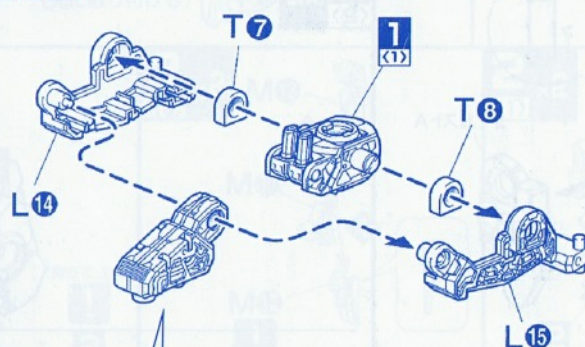
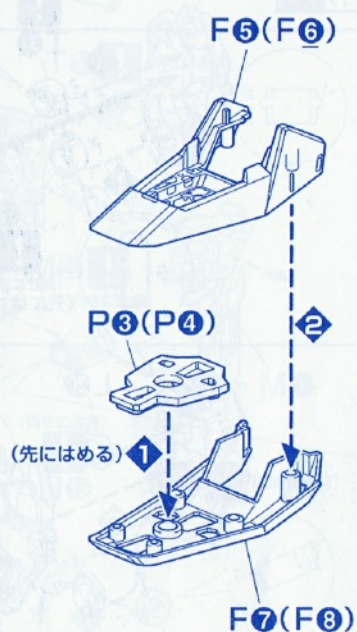
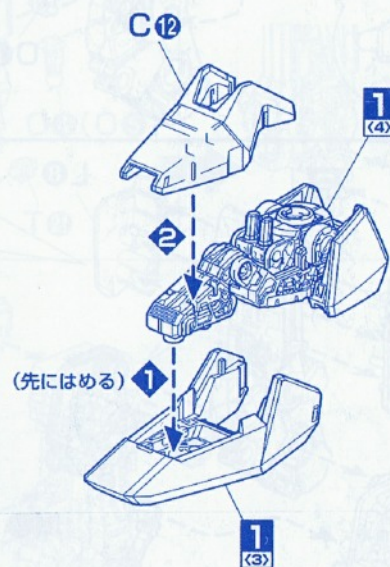
1
(2) x21
(3) x21
(4) x21
(5) x2

2~4

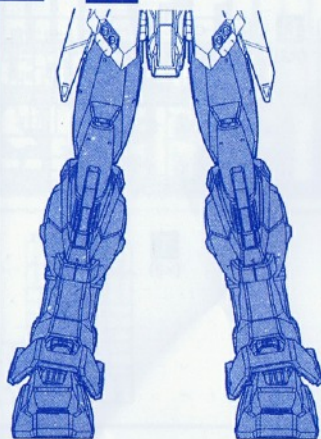

・組立2~4で使用するパーツ

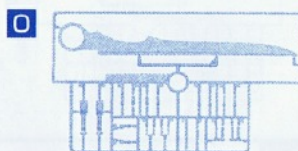
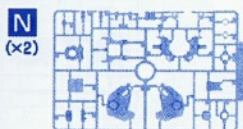
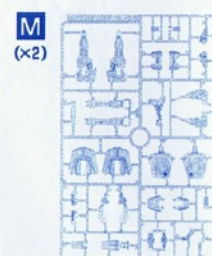
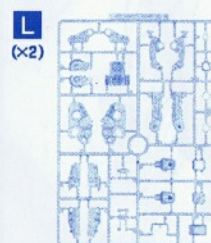
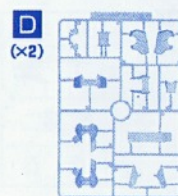
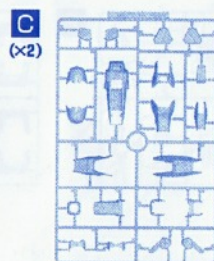
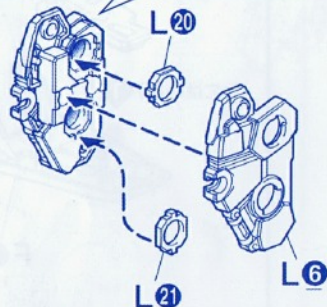
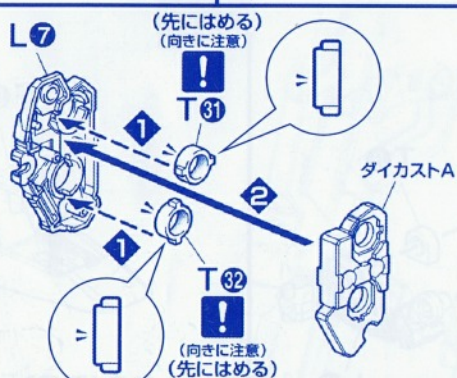
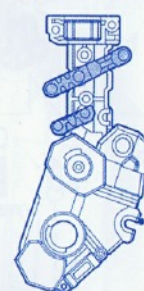
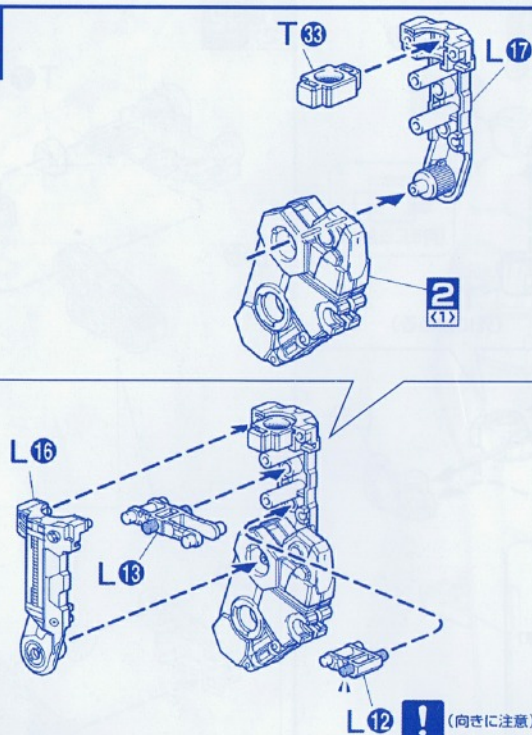
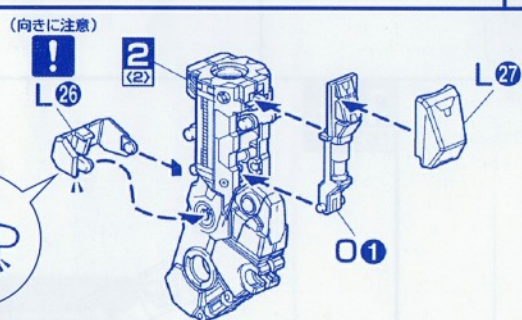
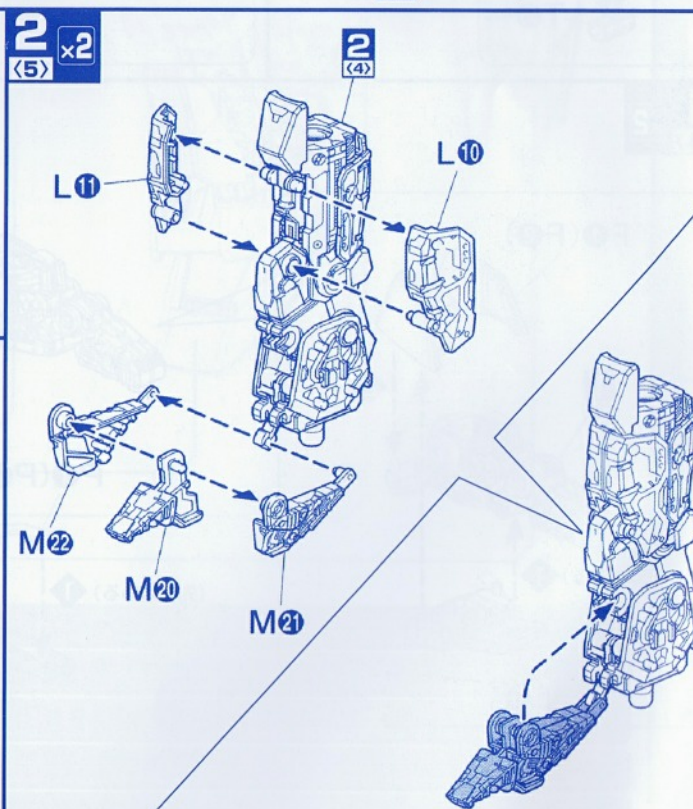
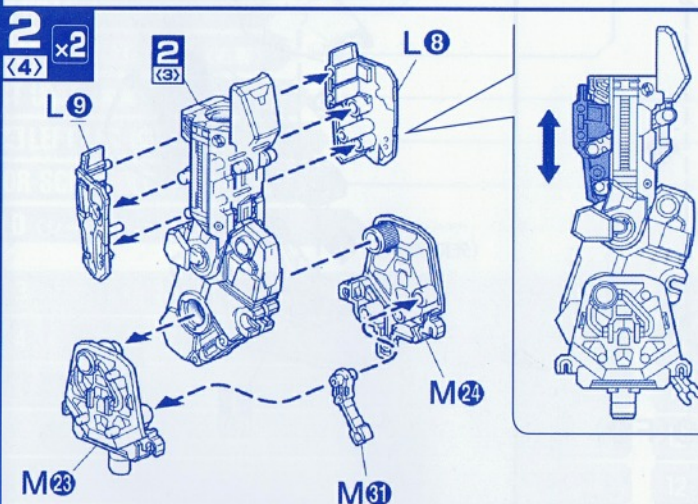
2
(1) x22
(2) x22
(3) x22
(5) x22
(4) x2

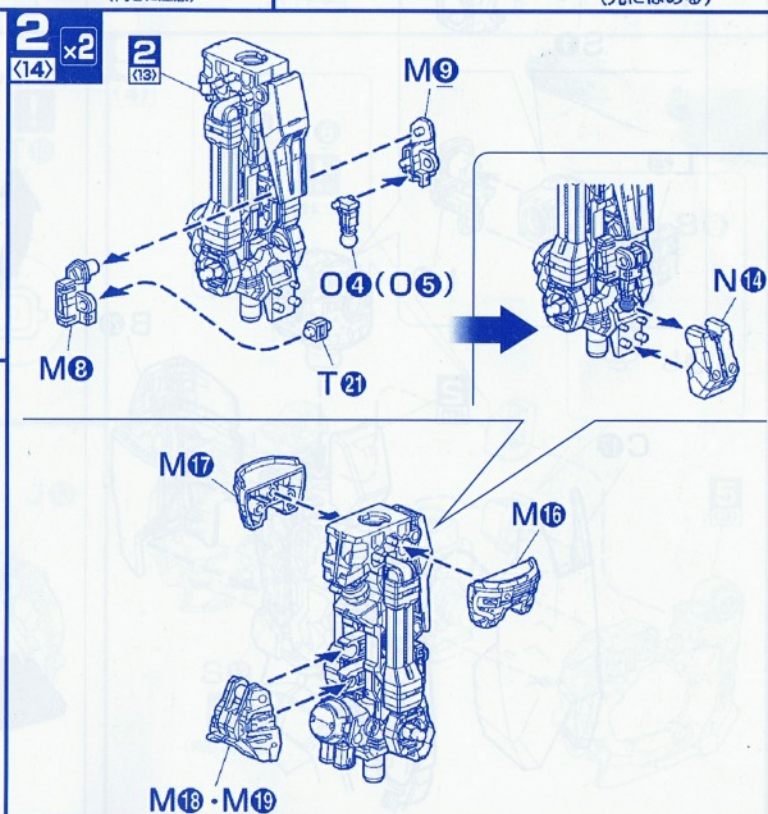
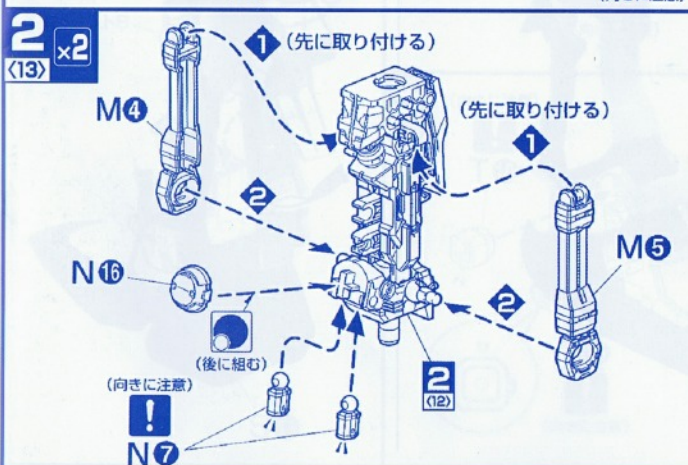
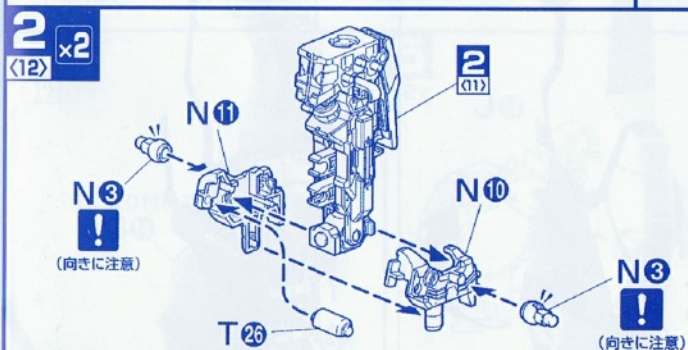
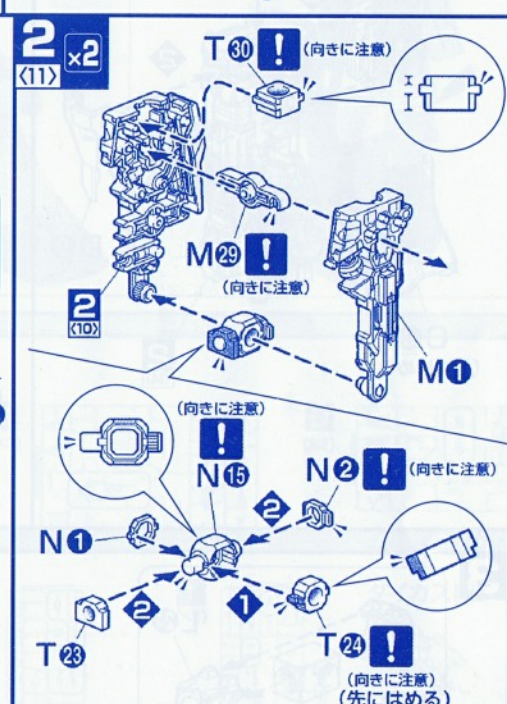
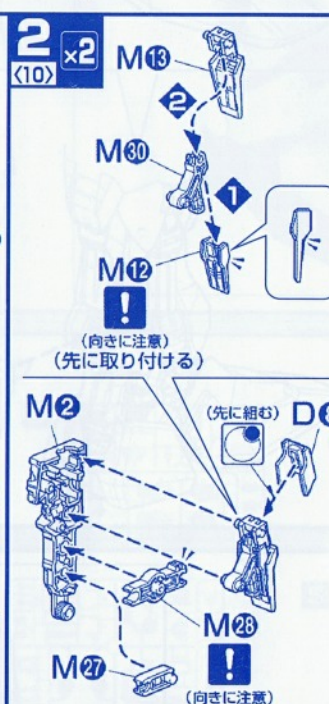
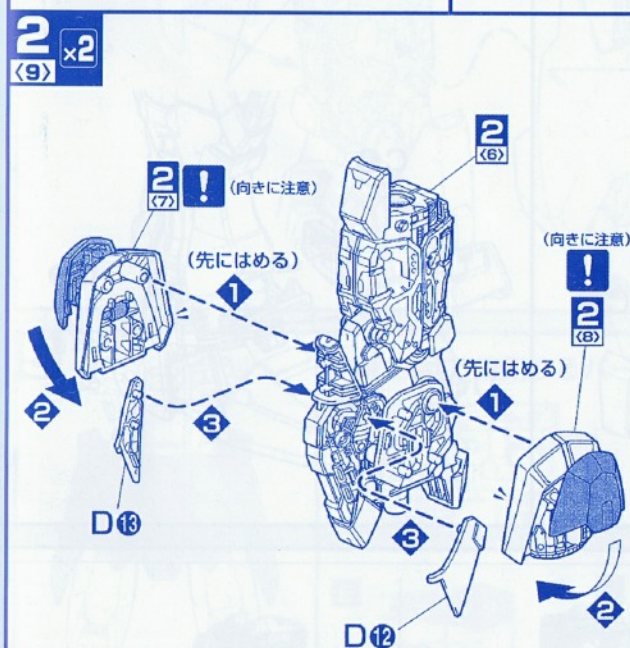
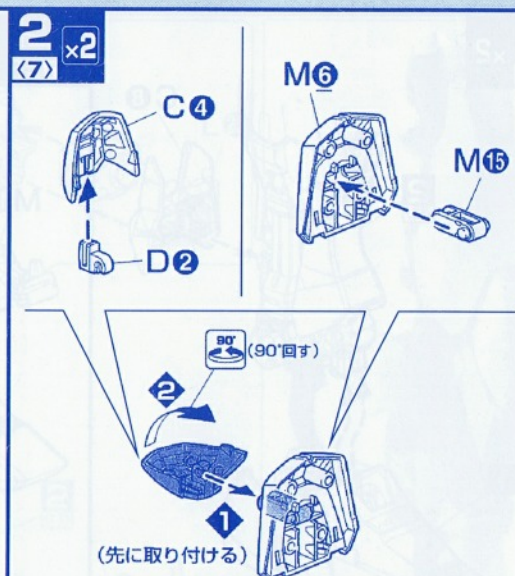
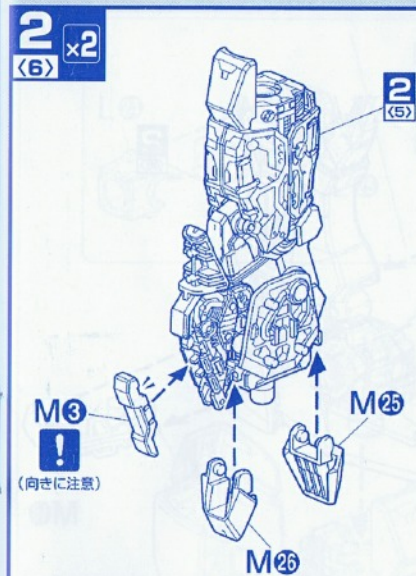

2
(15) x2

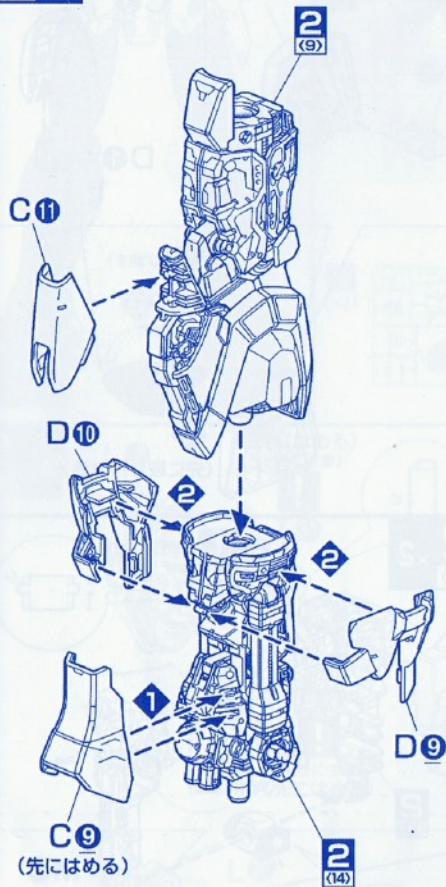

2
(16) x2

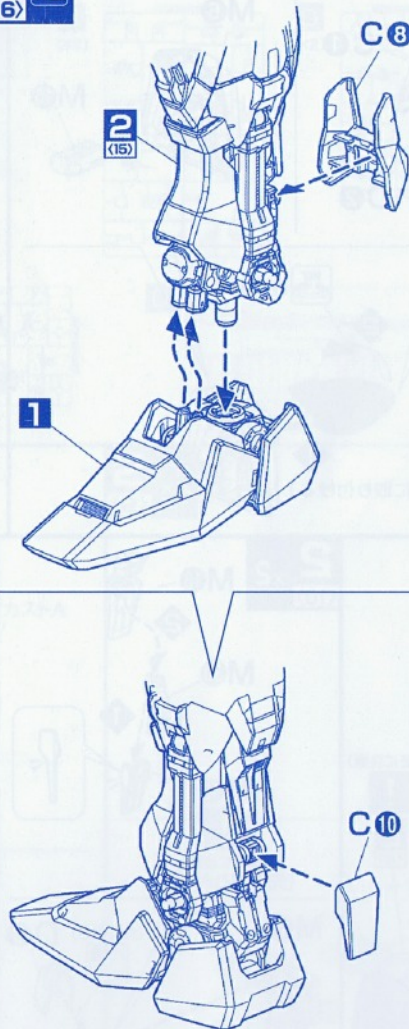

2
(17) x2

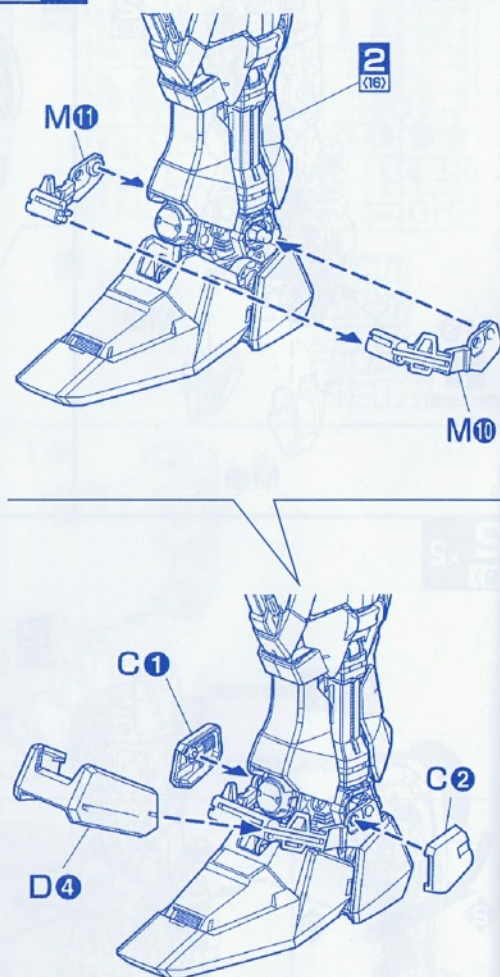

3

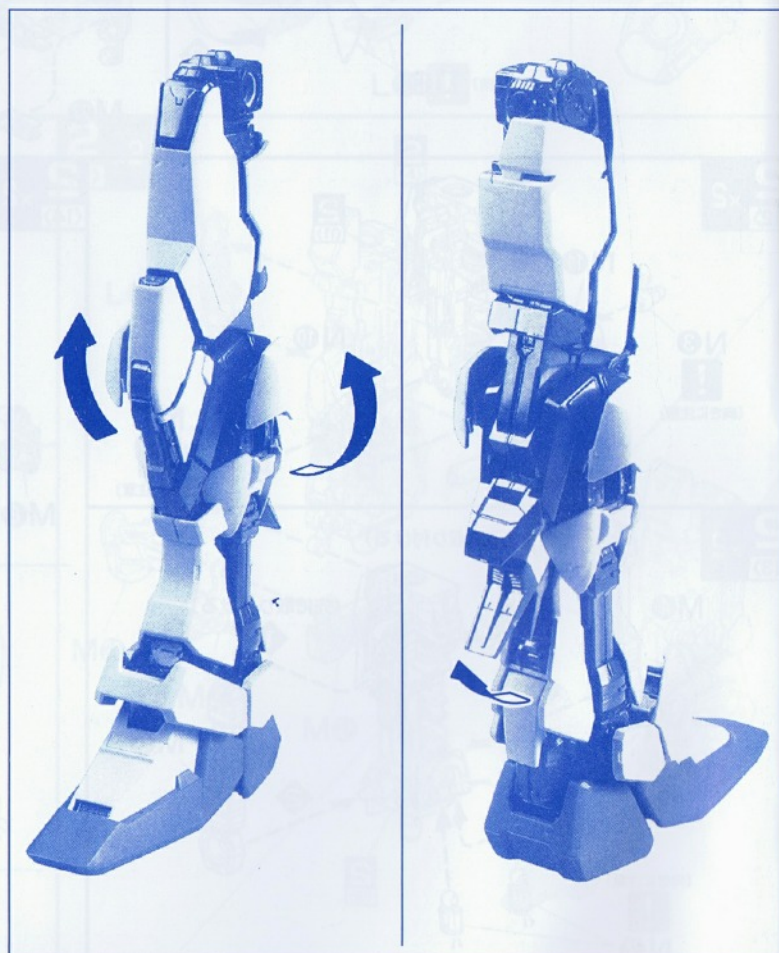
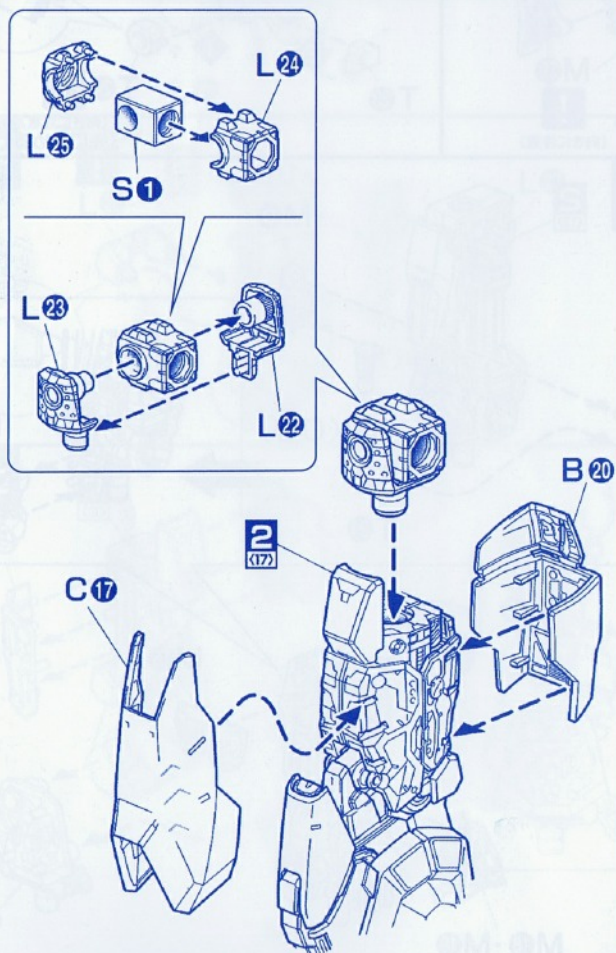

4

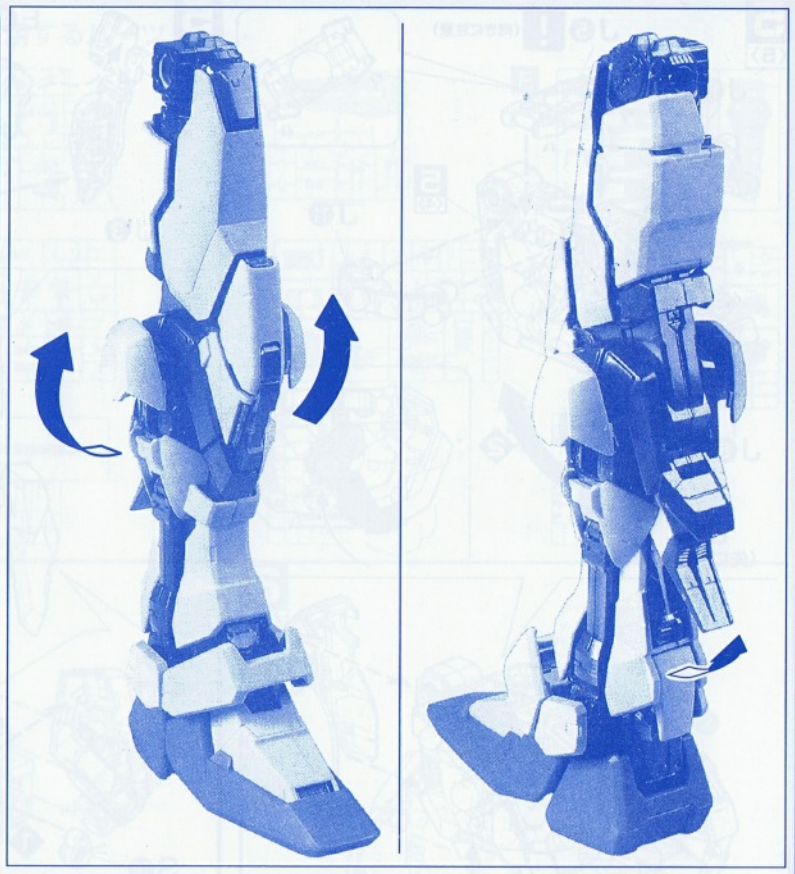
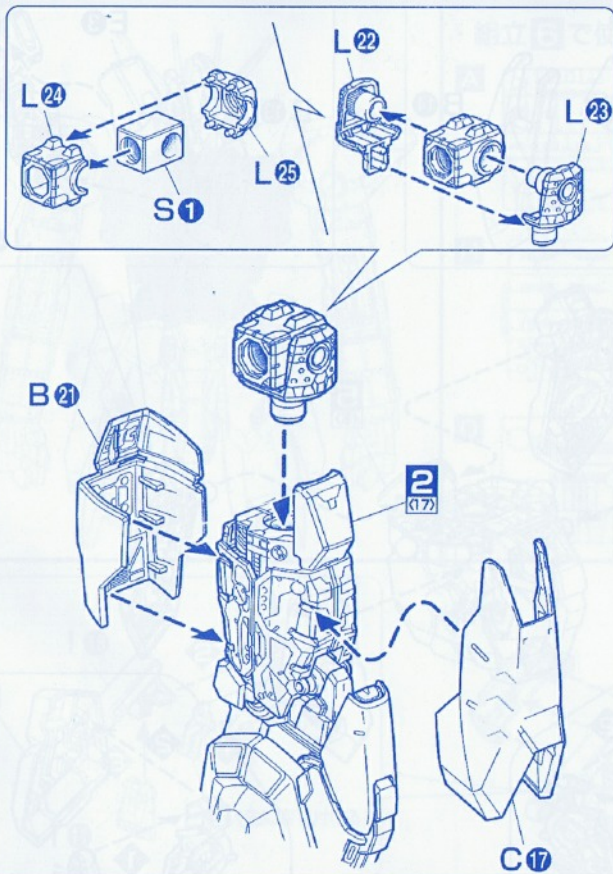

5

・組立5で使用するパーツ

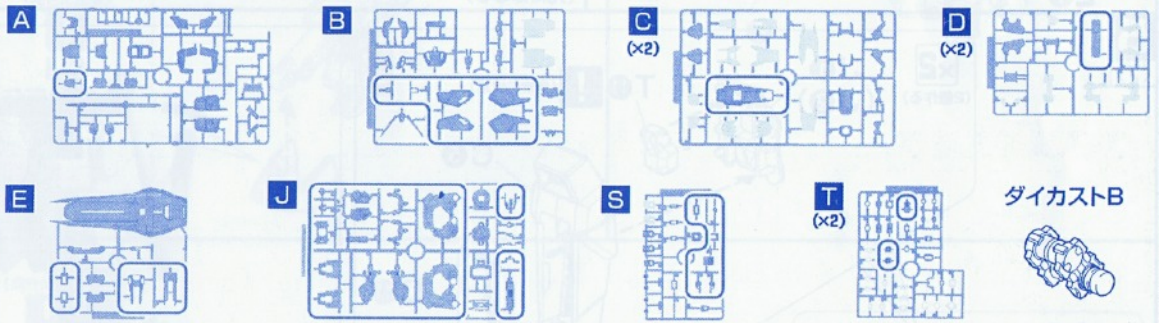
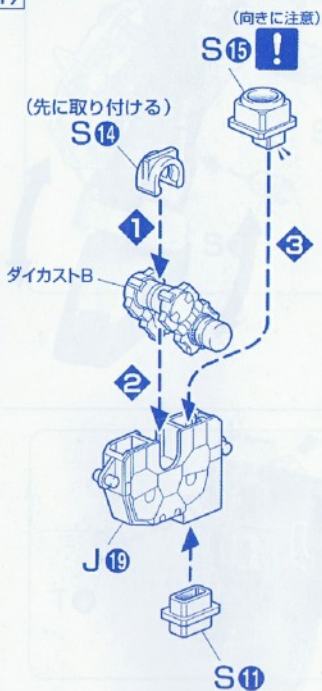
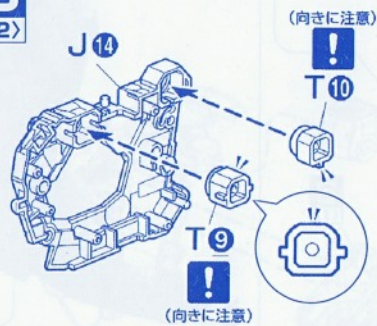
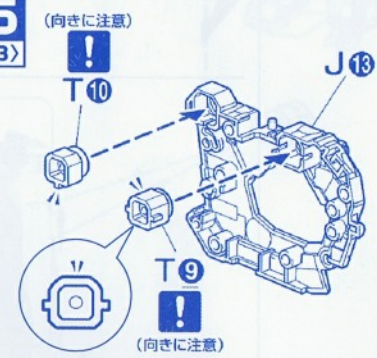
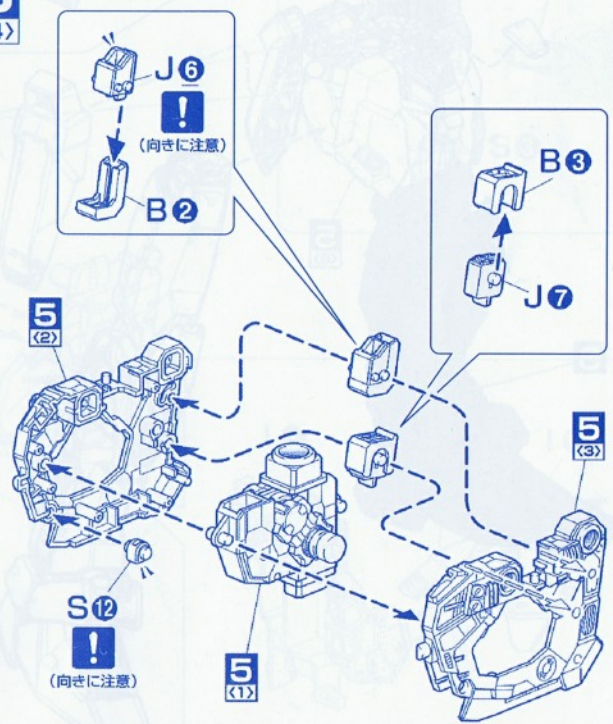
5
(1)5
(2)5
(3)5
(4)

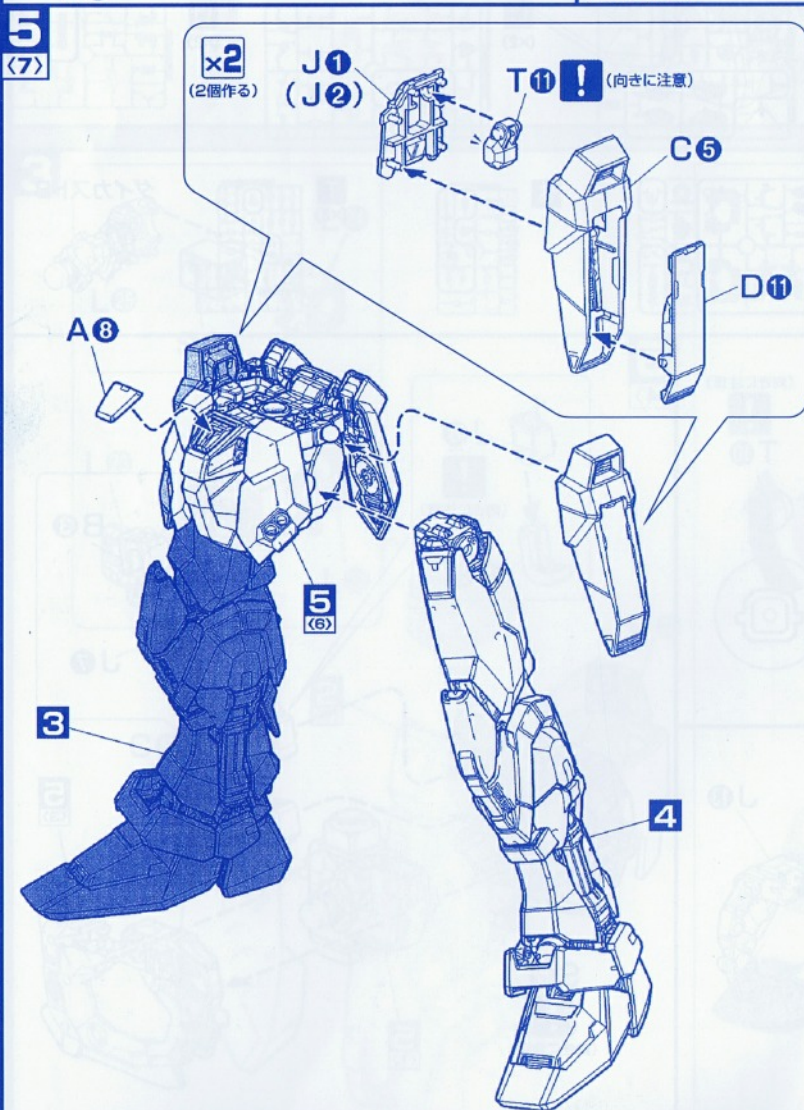
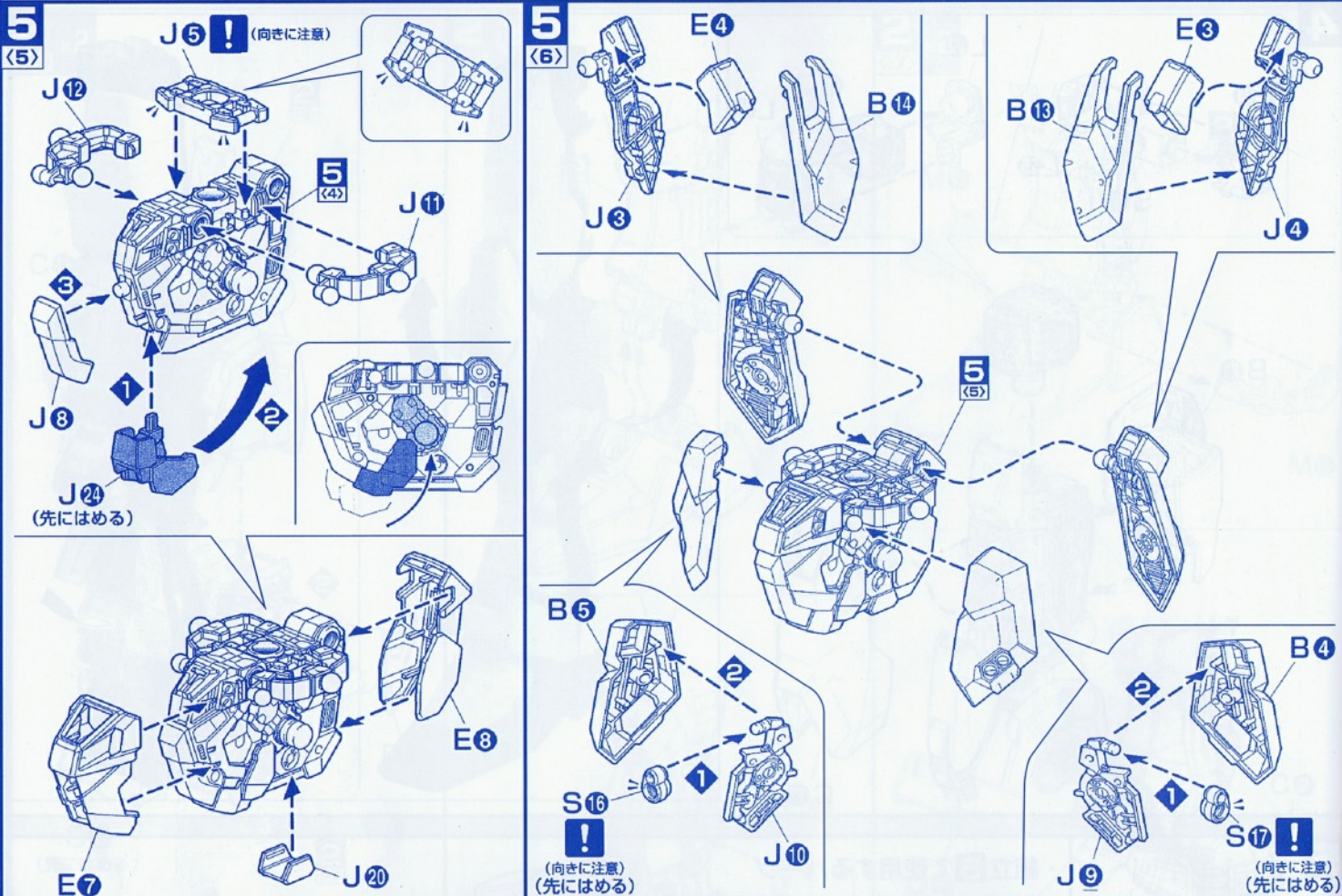

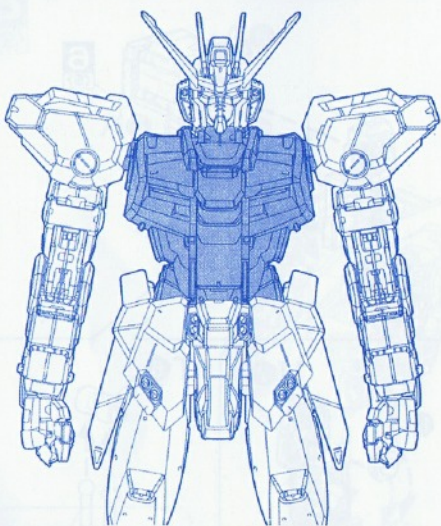

・組立6で使用するパーツ

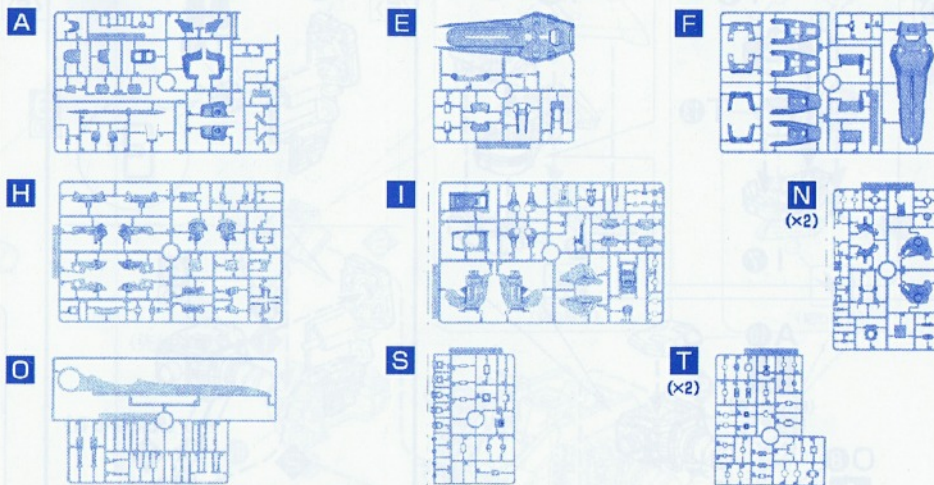

6
(1)

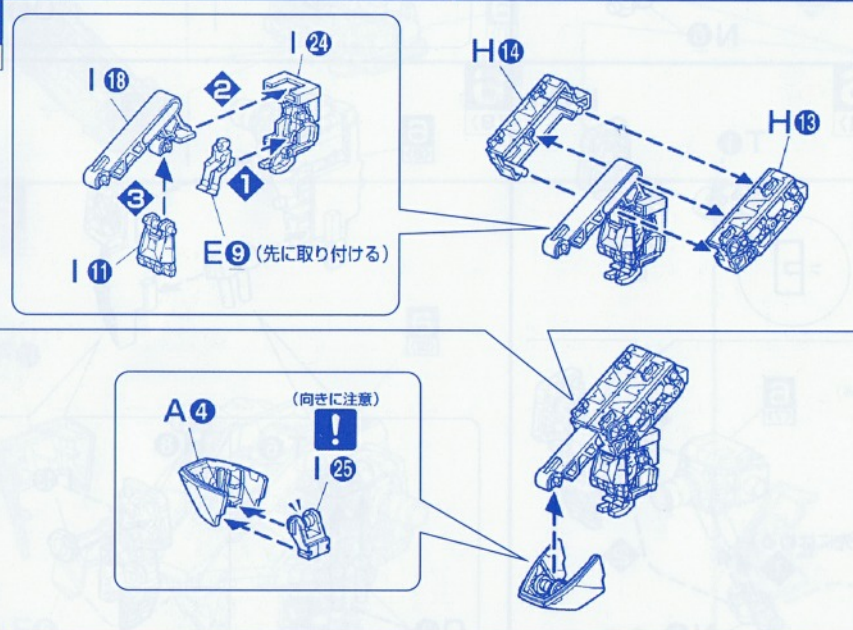

6
(2)

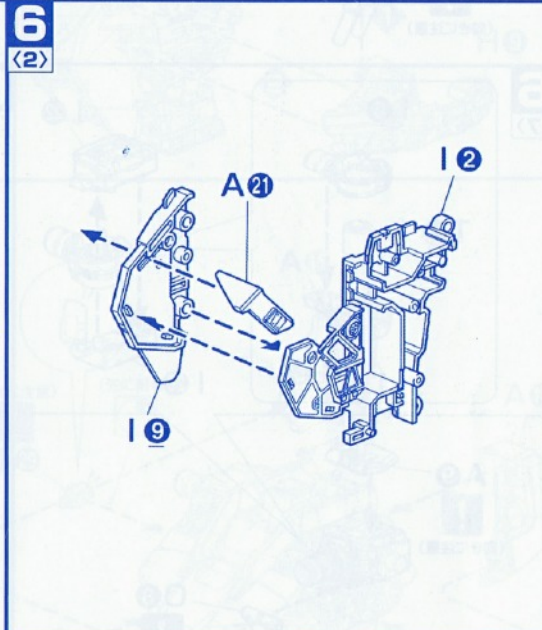

6
(3)

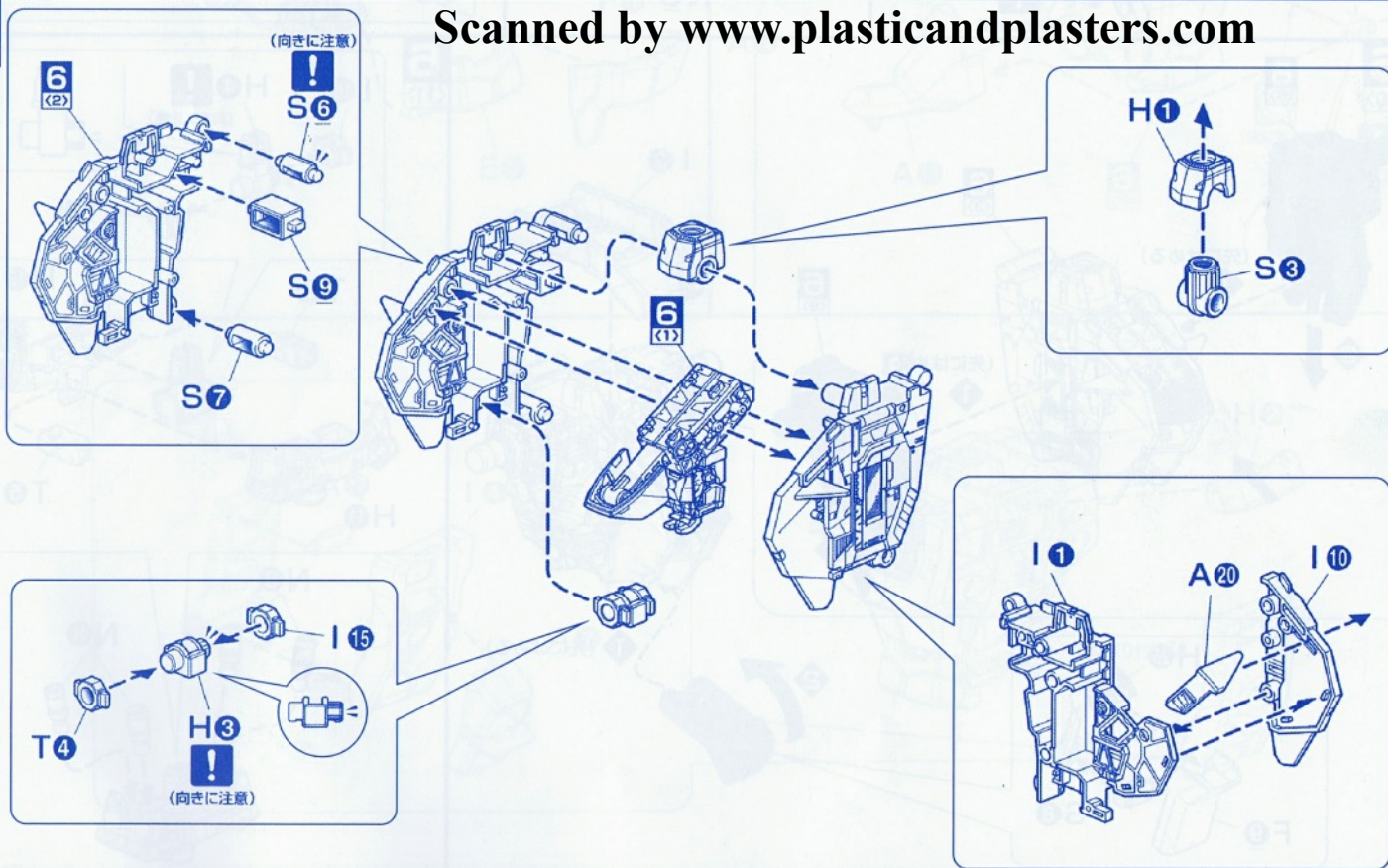

Scanned by www.plasticandplasters.com

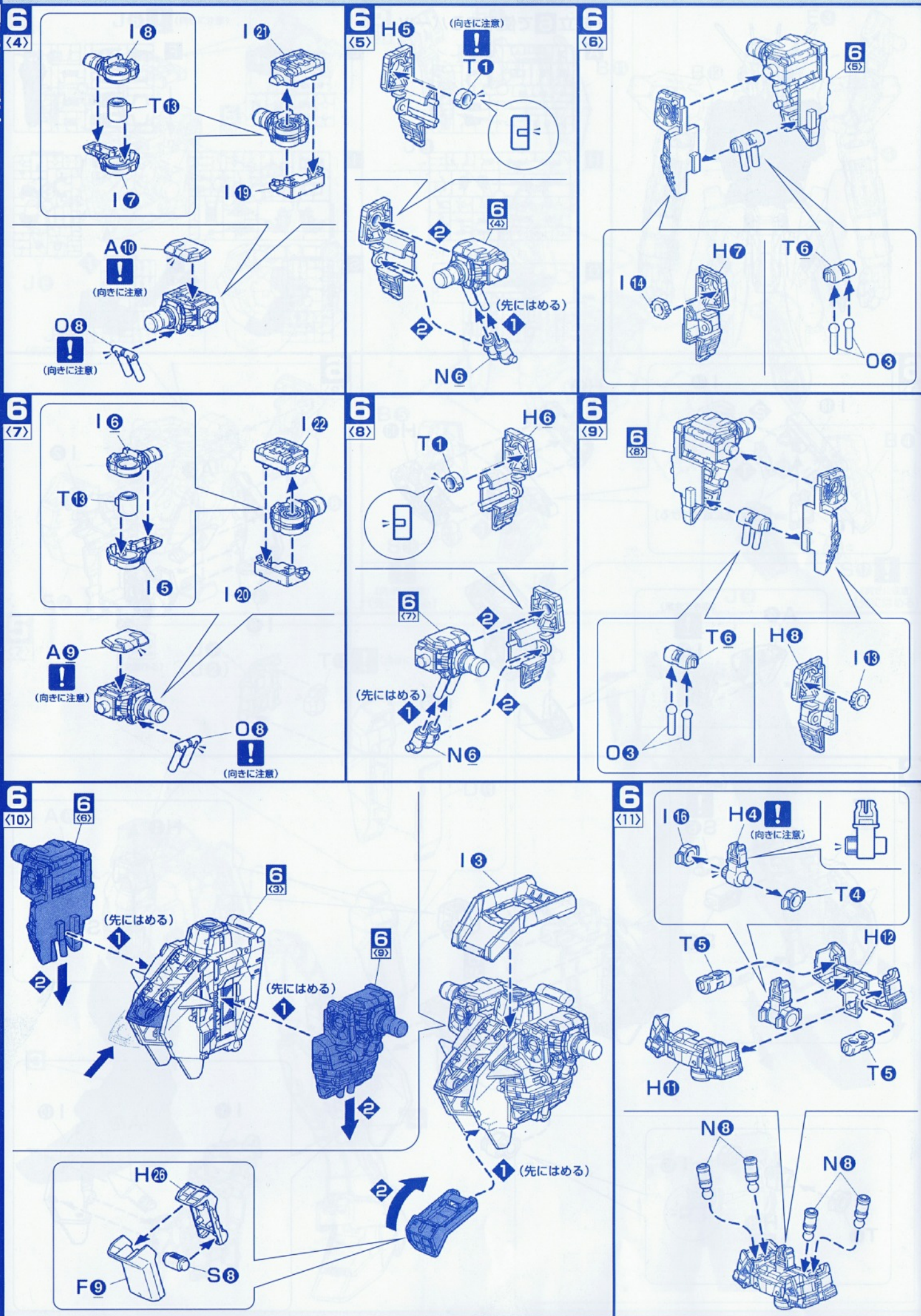

〈12〉

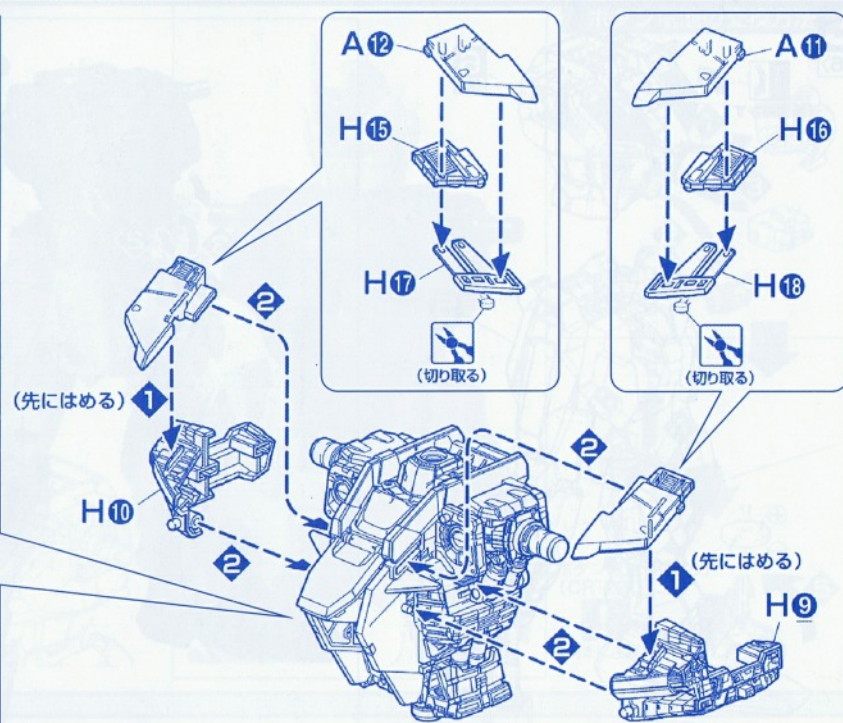

<13>

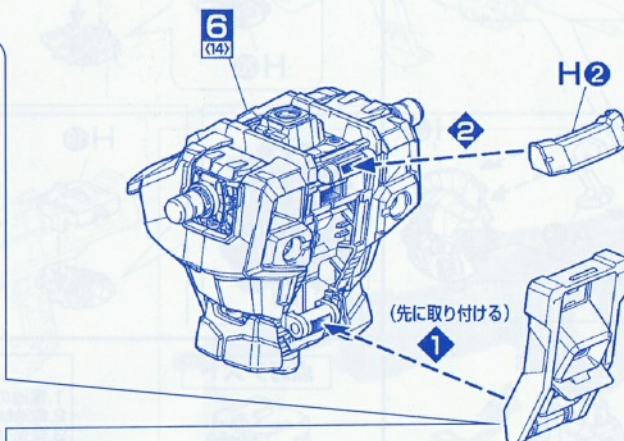

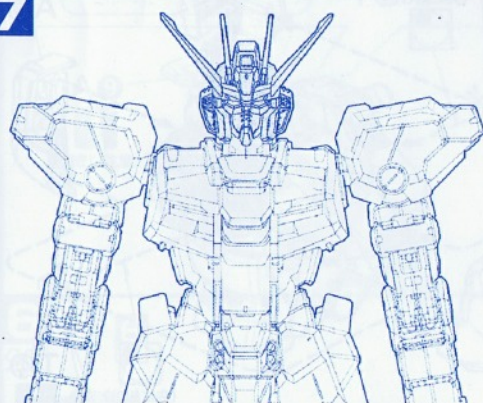
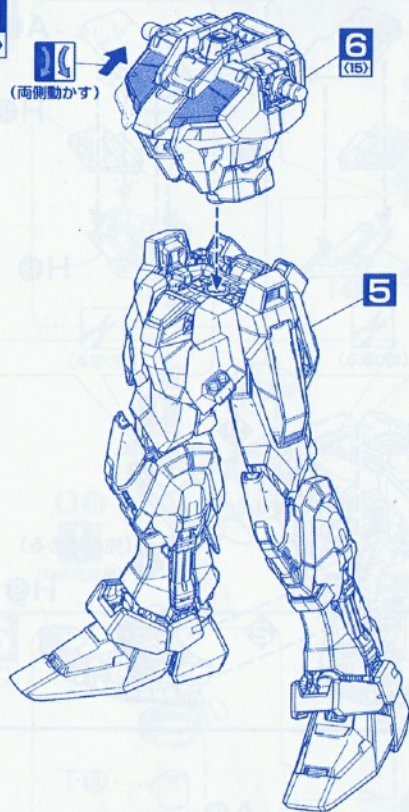

・組立7で使用するパーツ

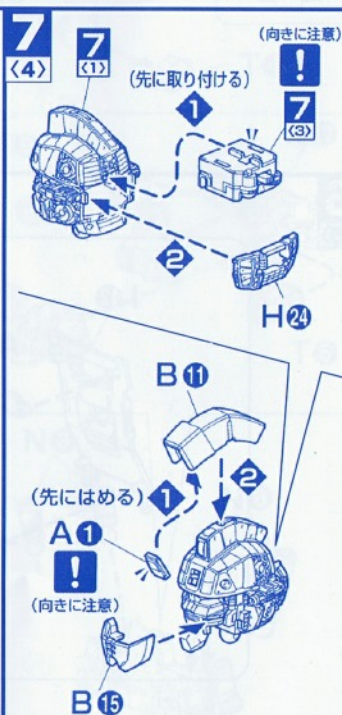
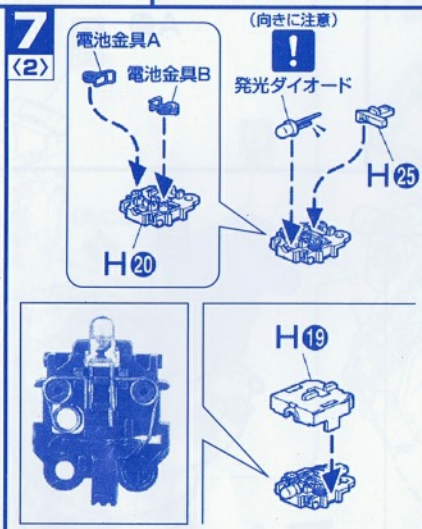
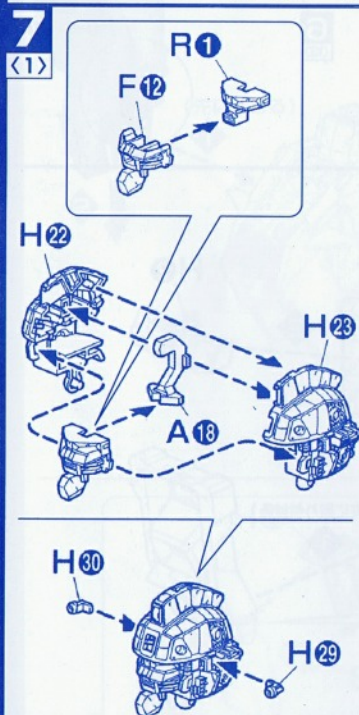
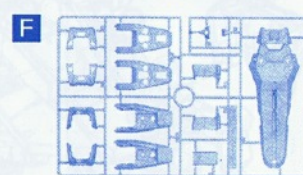
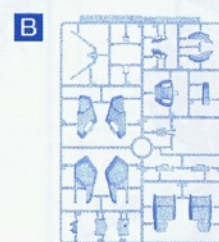
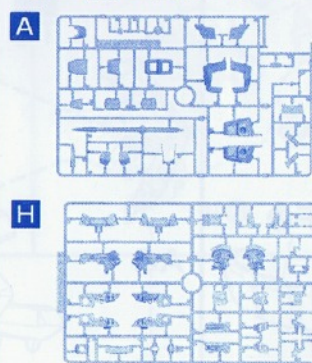

点灯テスト



※点灯させない時は、電池をはずします。

点灯しない場合

1. 電池の＋（プラスマイナス）は合っていますか。
2. 電池は古くありませんか。
3. 発光ダイオードの向きは合っていますか。
4. 接点が離れている場合、接点がつくように、発光ダイオードの足や電池金具を微調整して点灯するようにします。

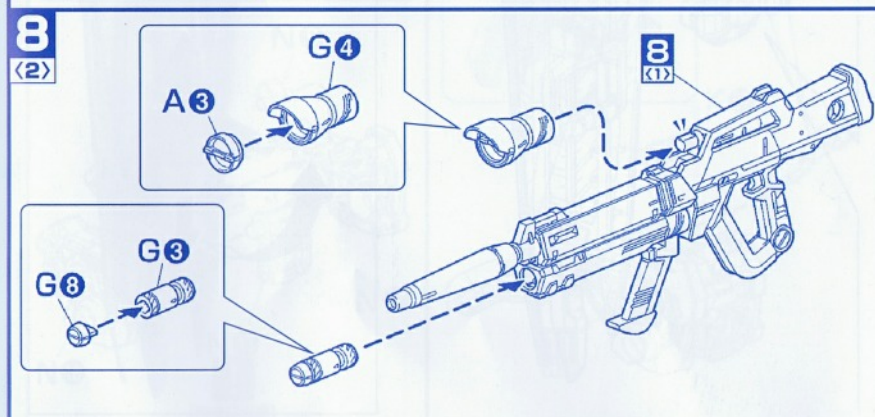
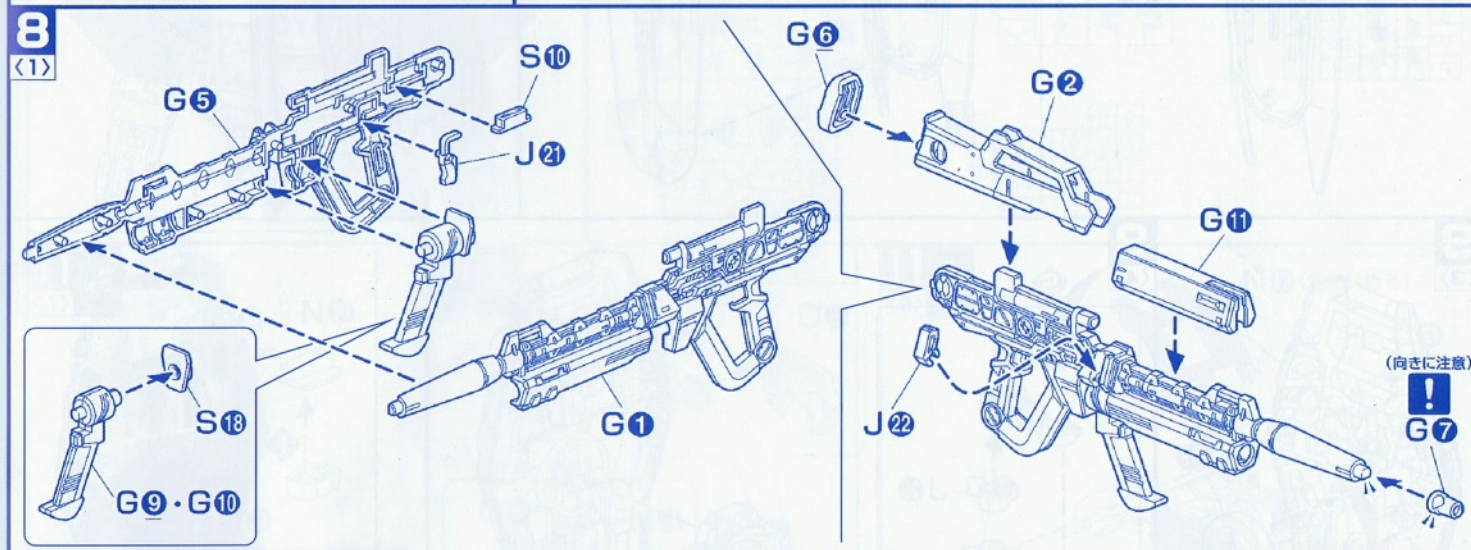
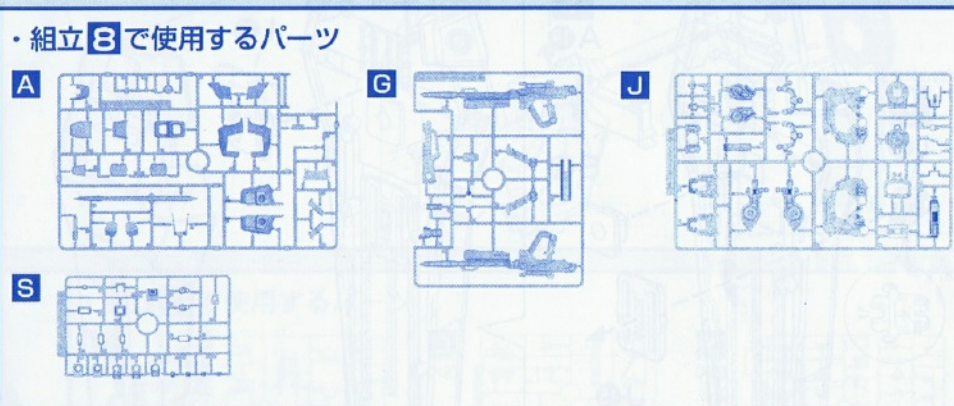
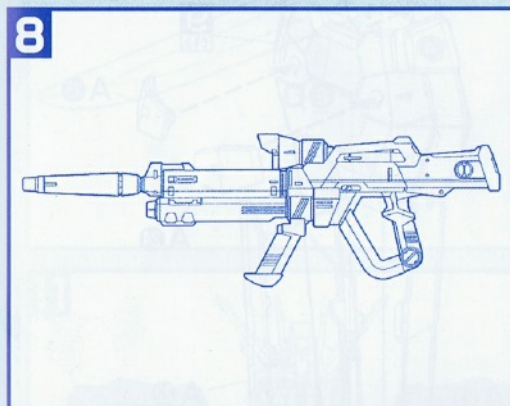
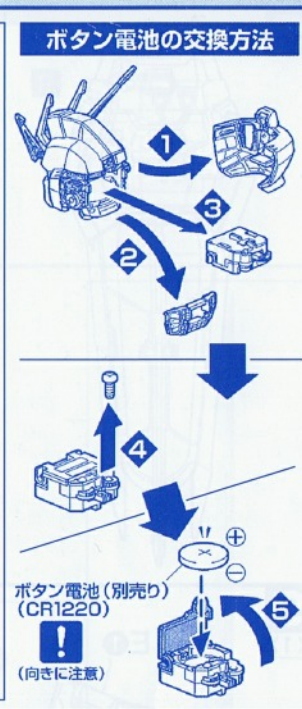
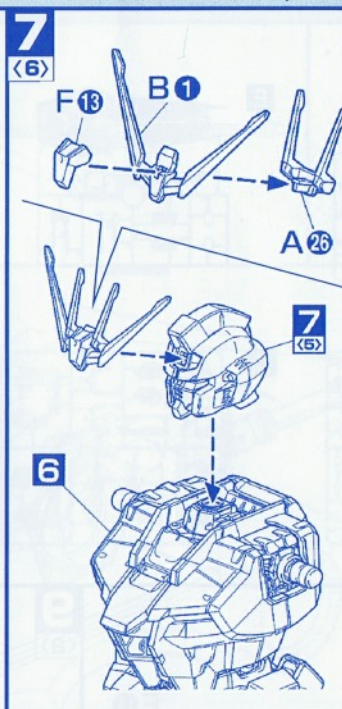
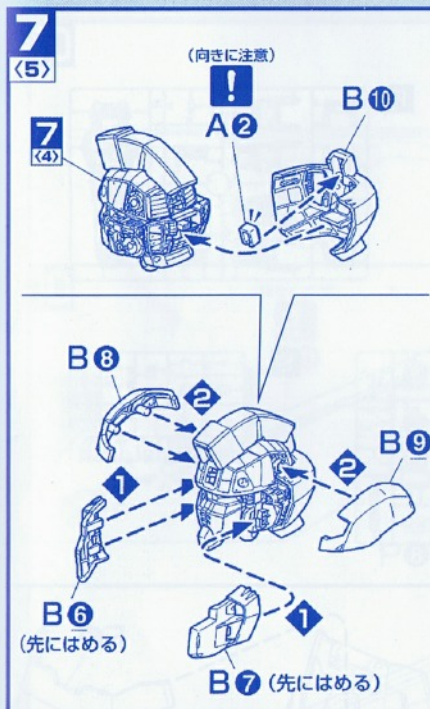

9

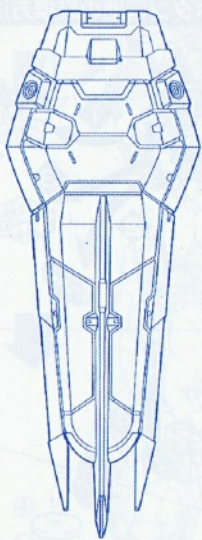

・組立9で使用するパーツ

A

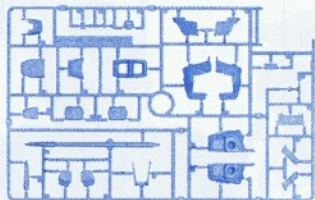

E

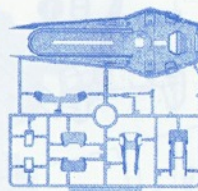

F

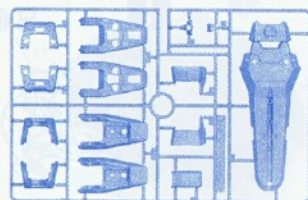

I

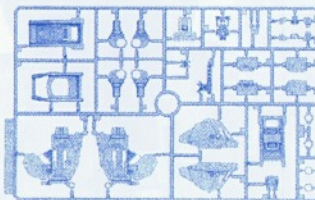

J

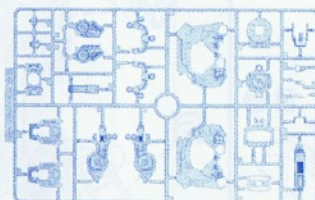

S

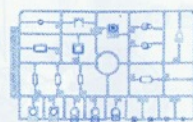

9

(1)

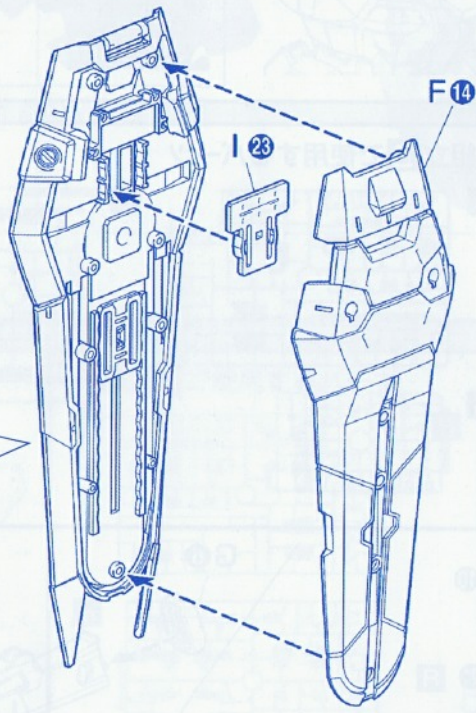
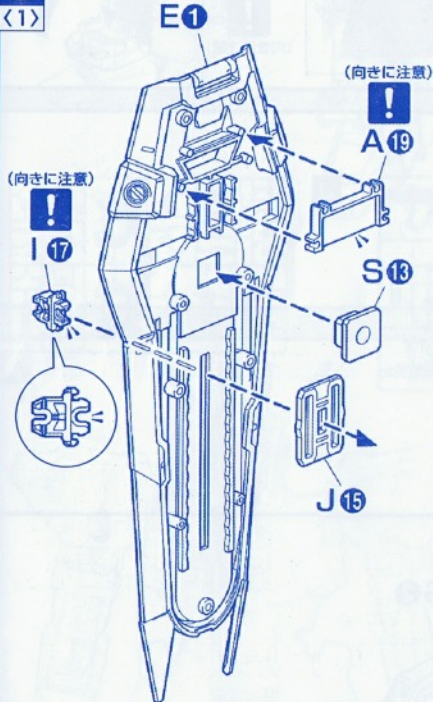

9

(2)

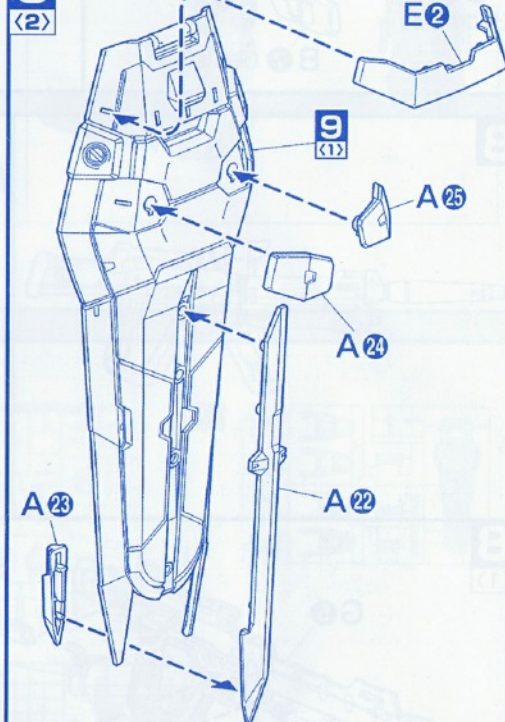

9

(3)

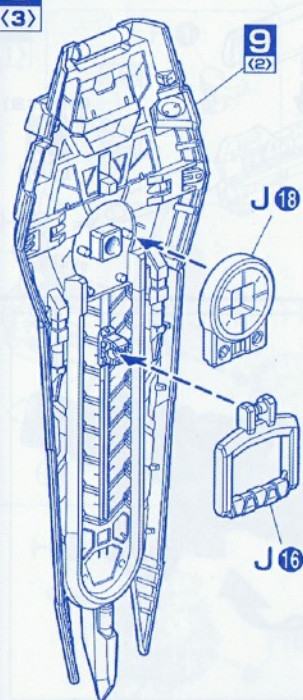

9

(4)



9

(5)

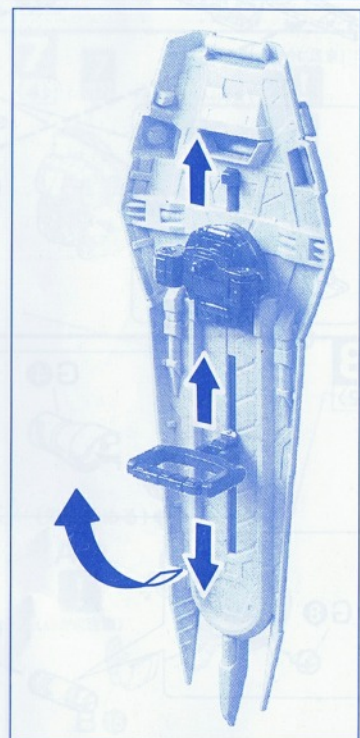
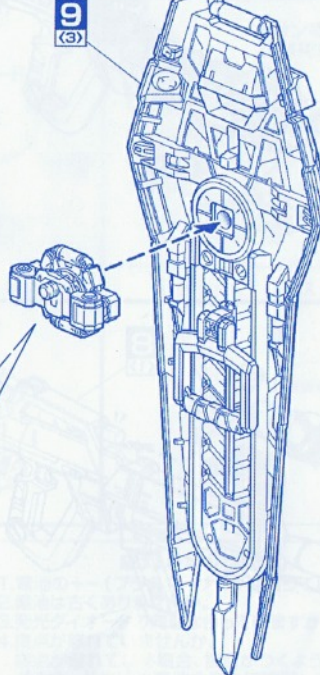

10

・組立10で使用するパーツ

O

P

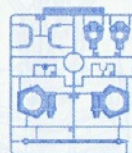
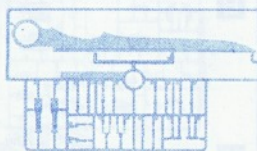
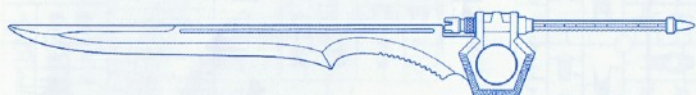

10

(向きに注意)

P9

(向きに注意)

P5

P8

P7

P6

O9

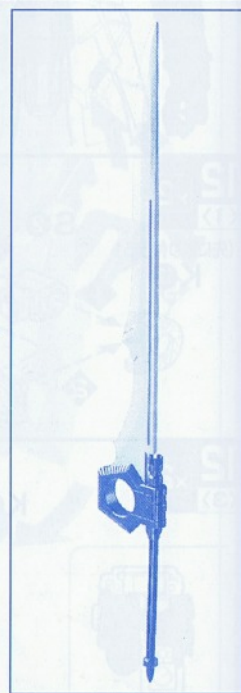
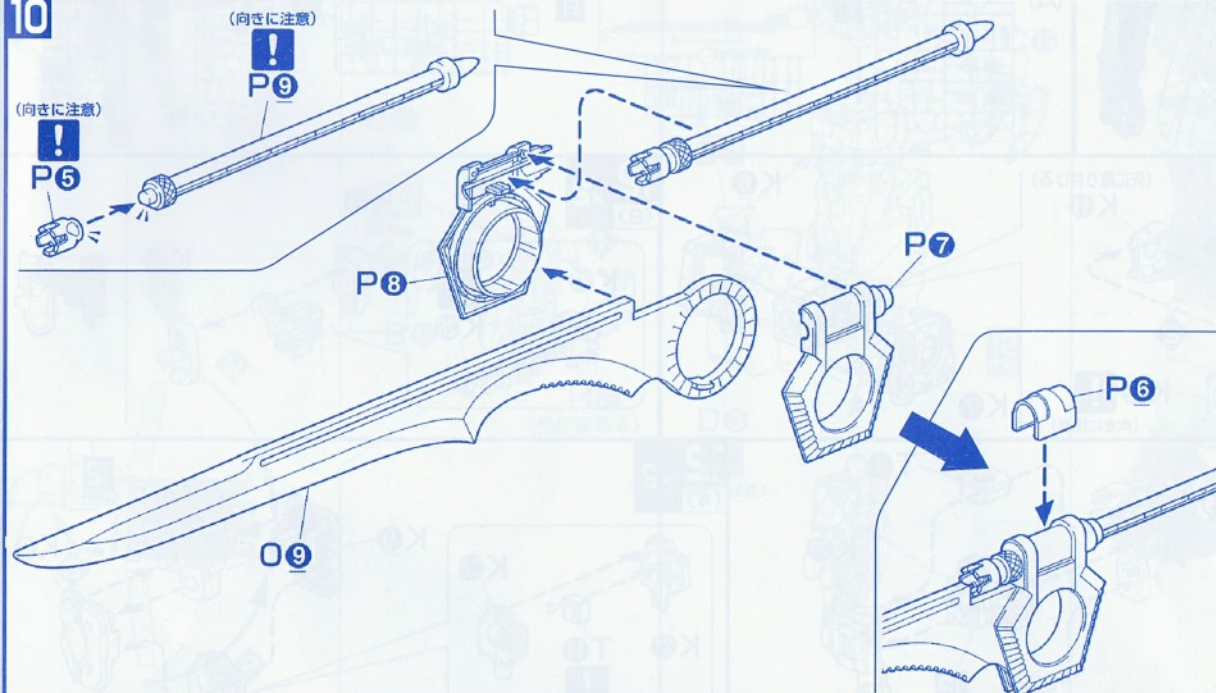

11

・組立11で使用するパーツ

C

(x2)

D

(x2)

K

(x2)

N

(x2)

T

(x2)

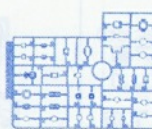
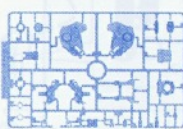
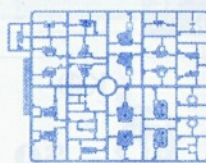
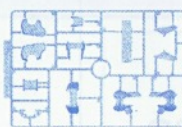
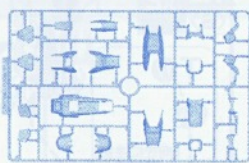
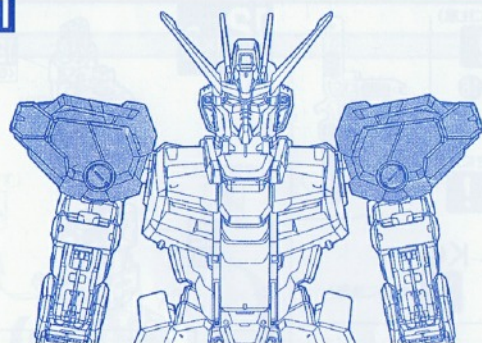

11

<1>

N19

N20

(先にはめる)

N21

(向きに注意)

T19

N9

N17

N18

(向きに注意)

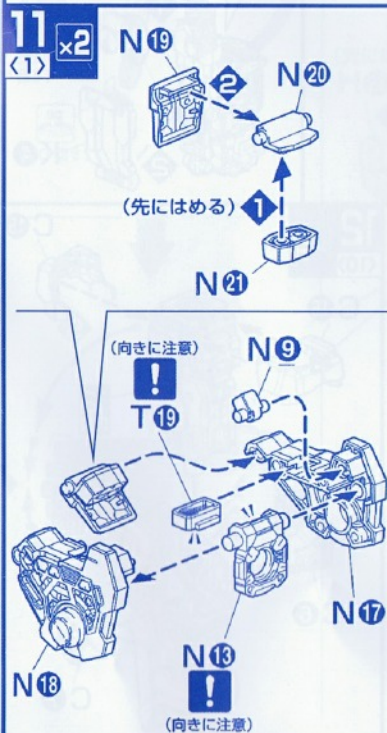

11

<2>

N4

D5

D6

N5

K27

11

<12>

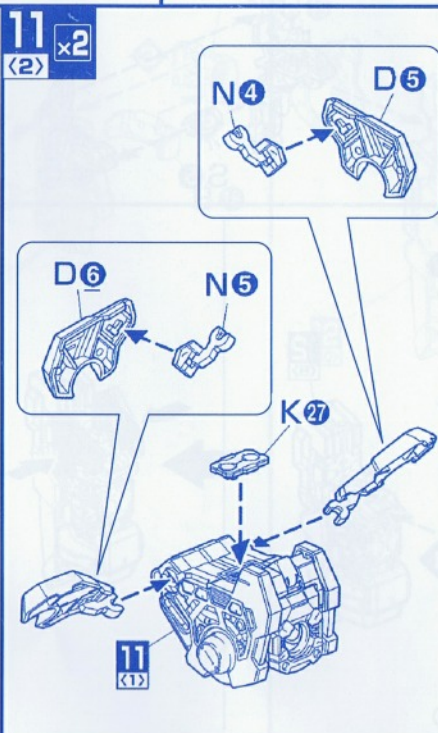

11

<3>

2

N12 (先にはめる)

C21

C20

1

4

4

3

3

3

3

3

3

3

3

3

3

3

3

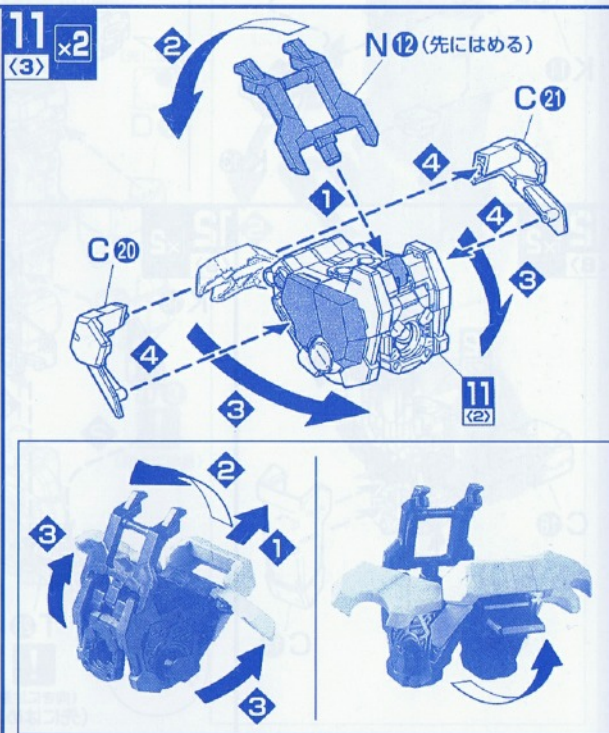

12~14

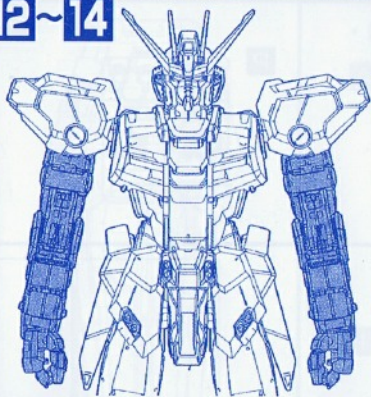

・組立12~14で使用するパーツ

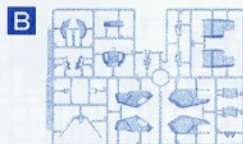
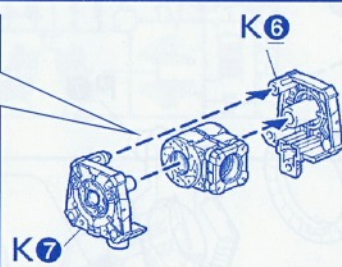
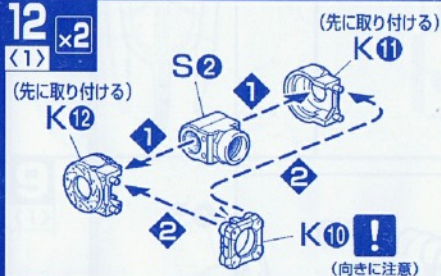
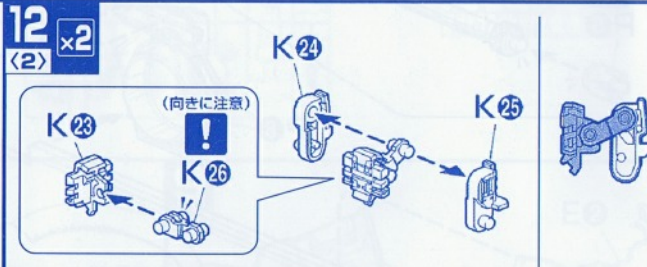
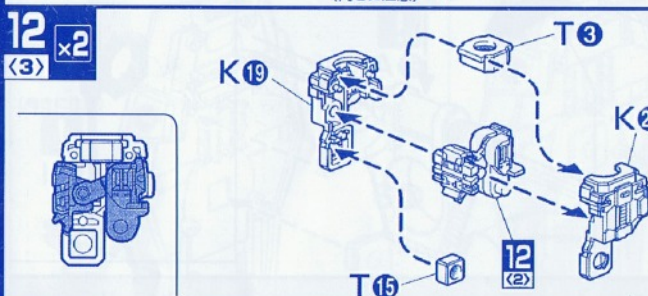
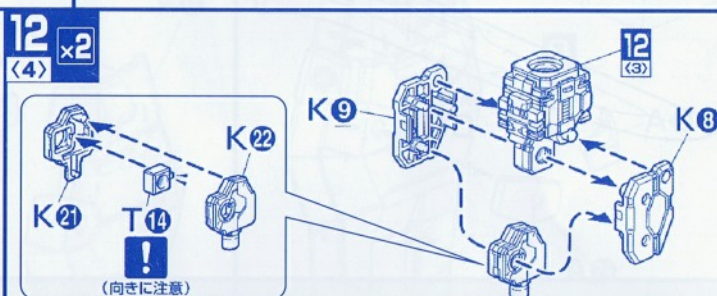
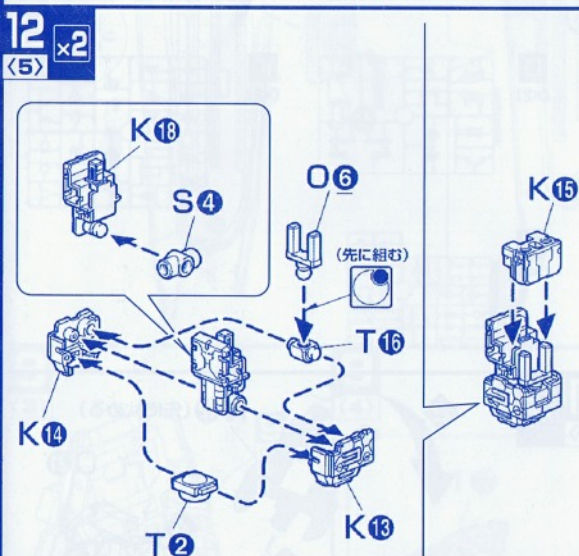
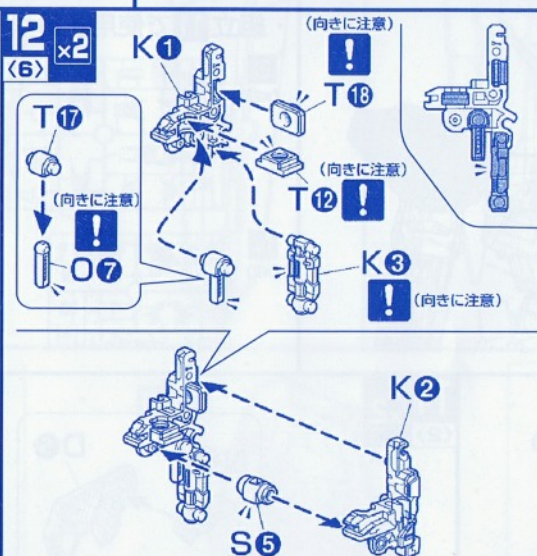
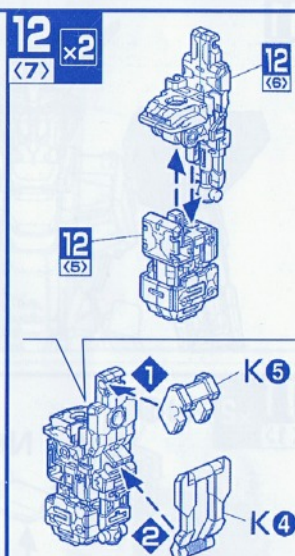
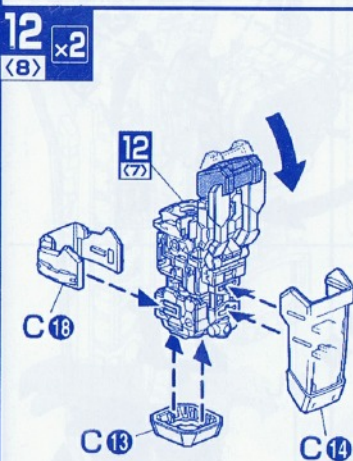
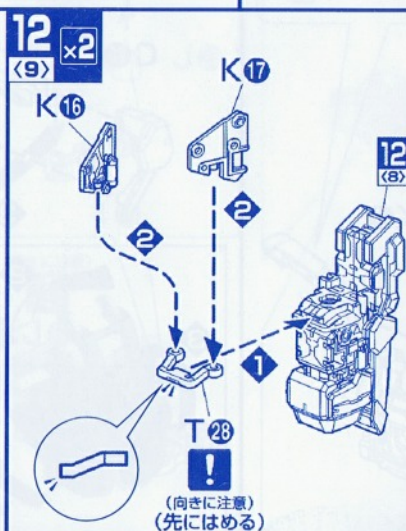
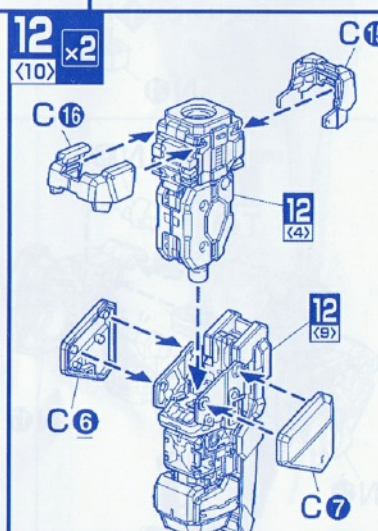
12 x2
<1>12 x2
<2>12 x2
<3>12 x2
<4>12 x2
<5>12 x2
<6>12 x2
<7>12 x2
<8>12 x2
<9>12 x2
<10>

13

(1)

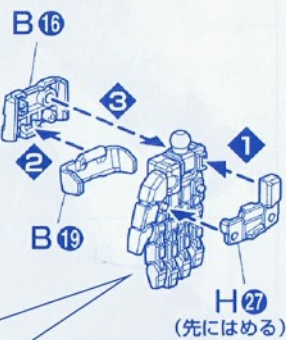
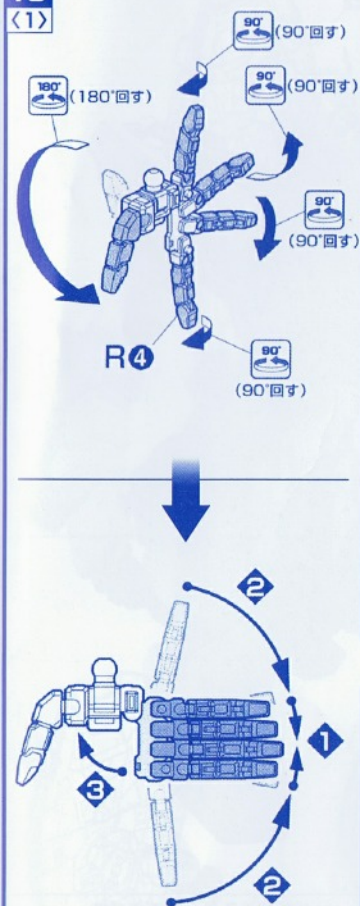

13

(2)

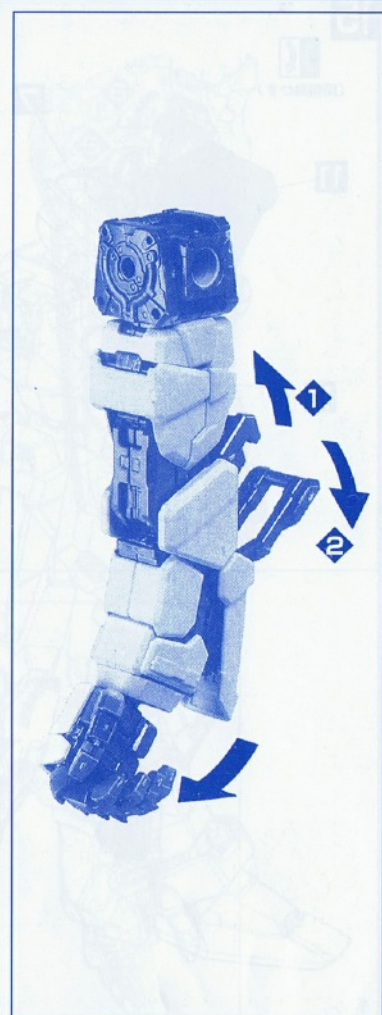
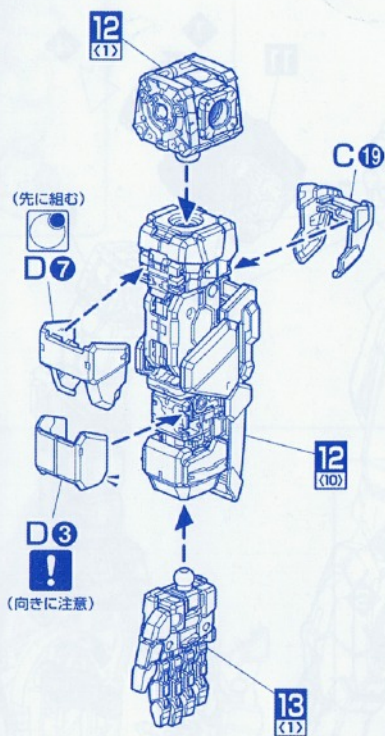

14

(1)

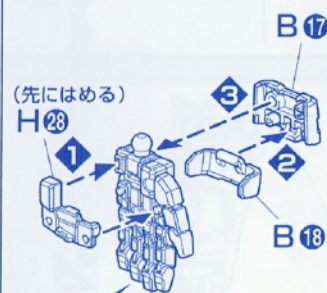
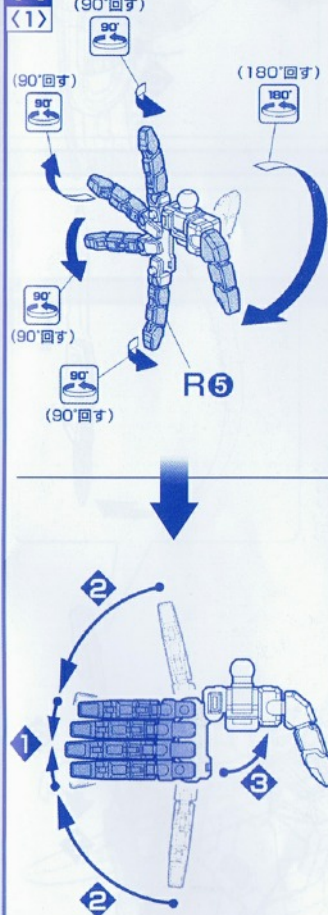

14

(2)

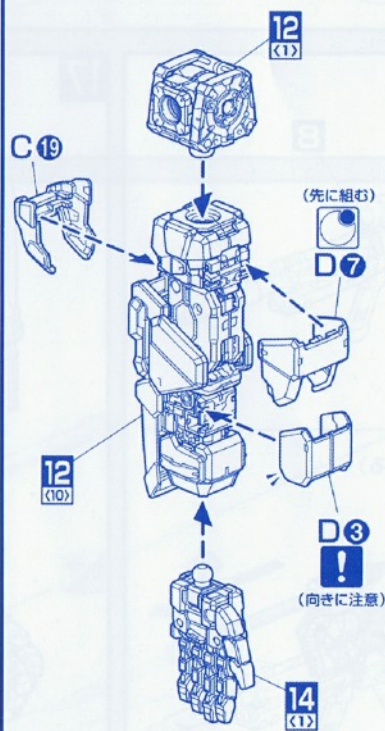



(両側動かす)

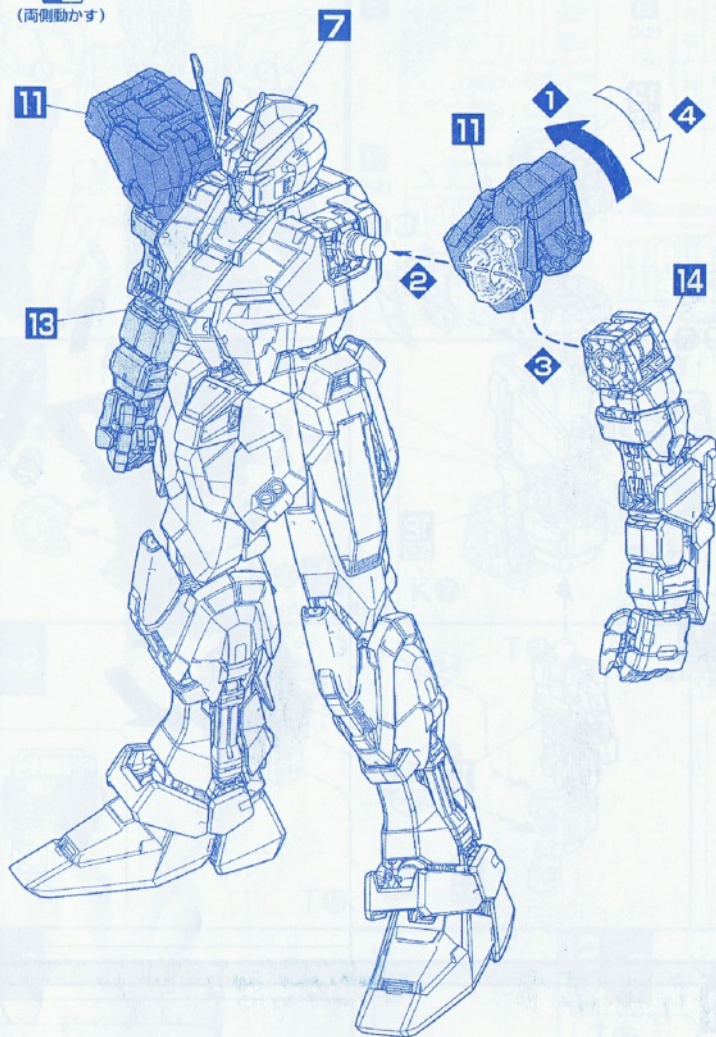

※B 10は好みの場所に飾ってください。



※ポーズによって股関節のセッティングを変えることができます。

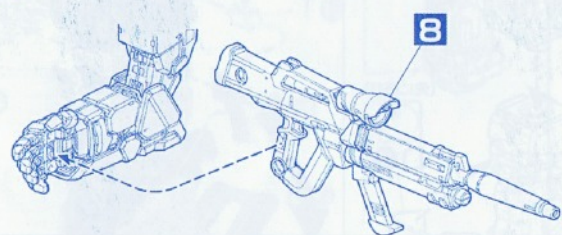
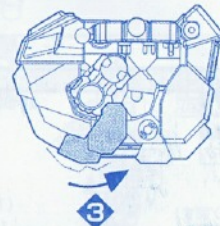
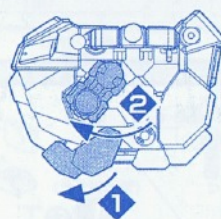

(選んで取り付ける)

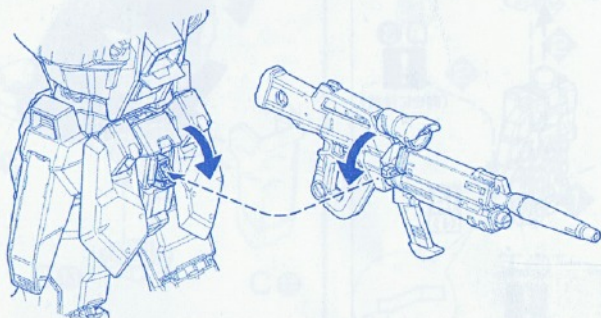

R2 (R3)



(選んで取り付ける)

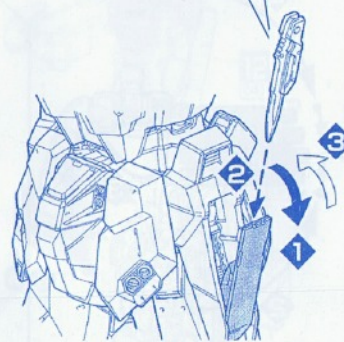
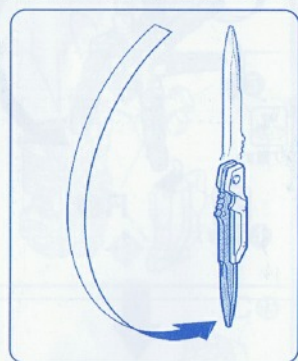
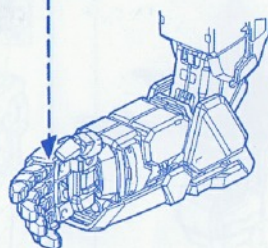

※アーマーシュナイダーは、
どちらにも持たせられます。

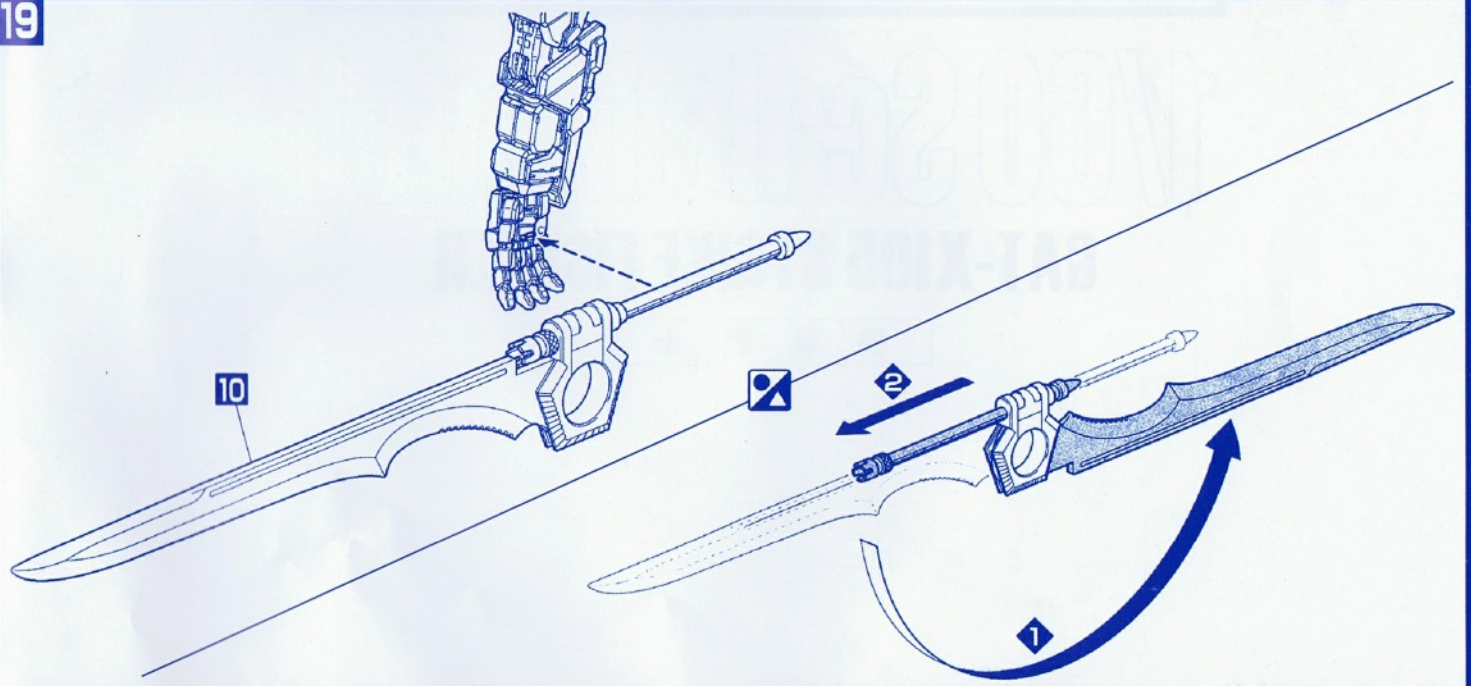
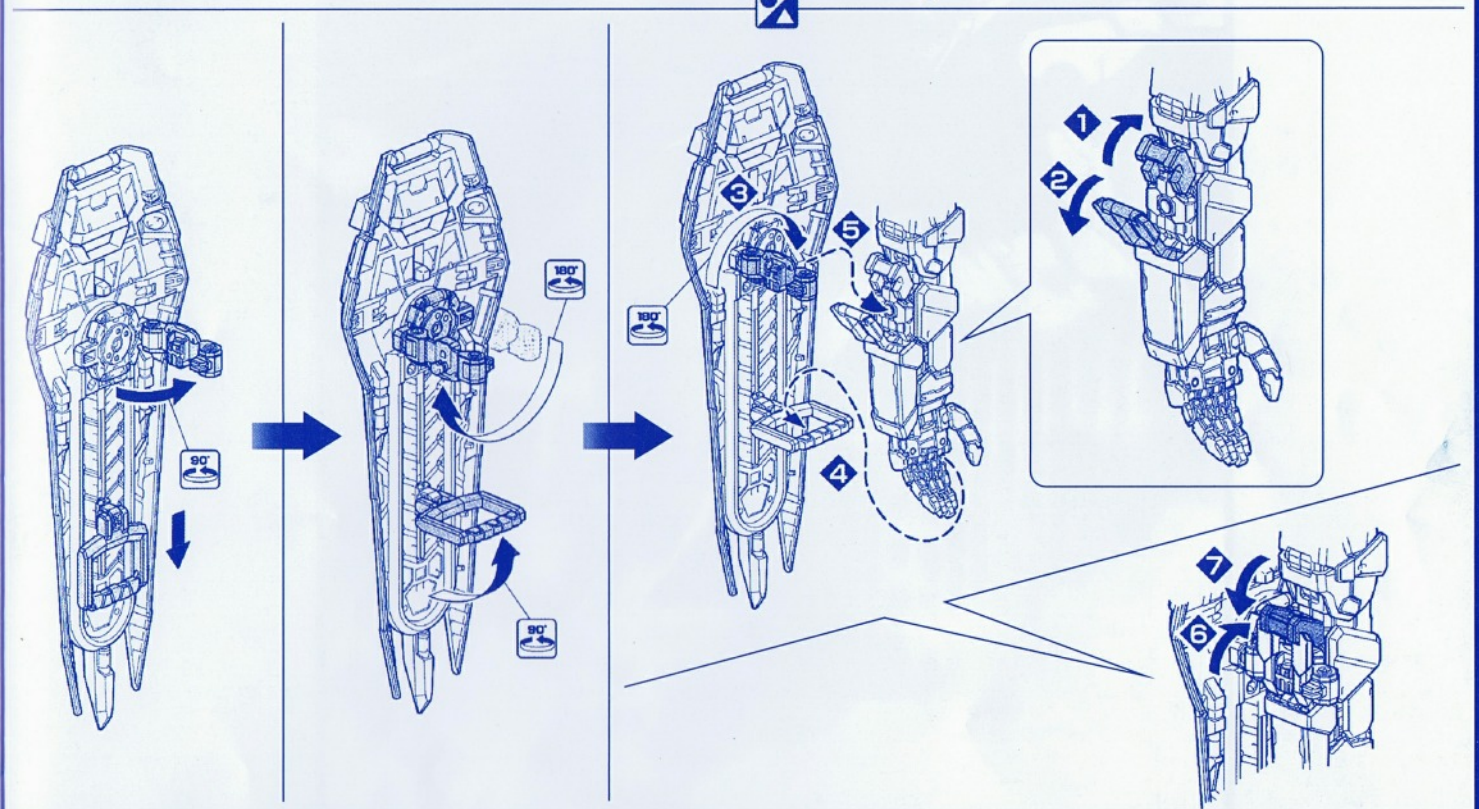
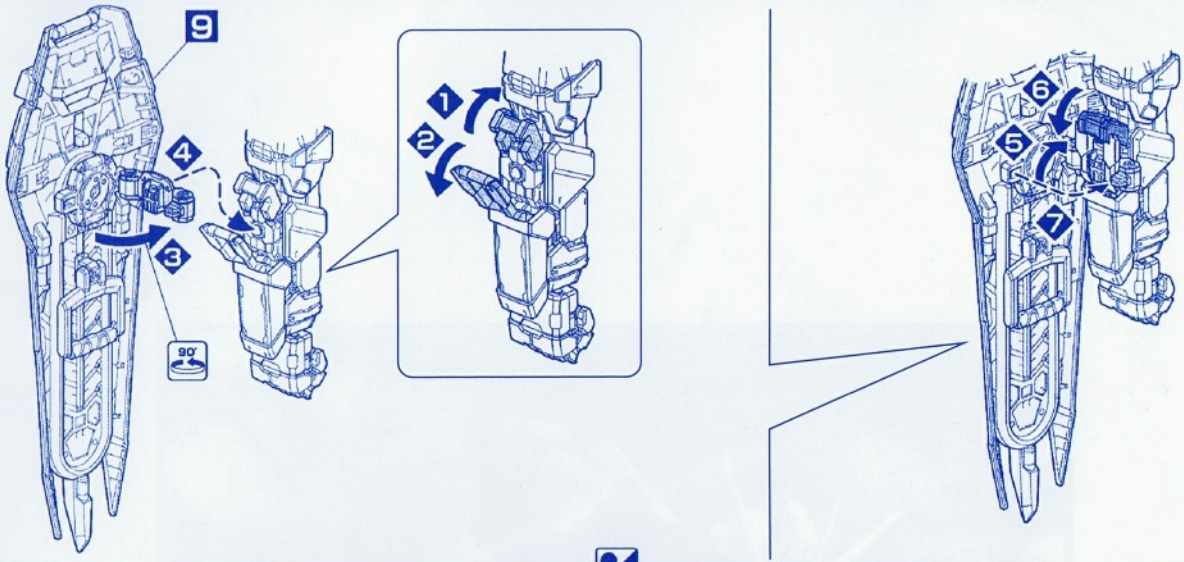



GAT-X105 STRIKE FIGHTER