

※ This commodity does NOT contain the 1/100 Scale MG "Sazabi" Plastic Kit



COMPATIBLE WITH
MG "SAZABI" VER.1.0A

1/100 SCALE | 4x"LED" GATLING GUN

HIGH SPEC. PLASTIC INJECTION
MODEL KIT OPTIONAL ACCESSORIES

SPECIFICATION

☆GATLING GUN LENGTH : 196MM ☆BACK-BINDER WIDTH : 125MM - 150MM ☆BACK-BINDER DEPTH : 73MM ☆PRINCIPLE PARTS : ABS (108PCS) / TPU (16 PCS) / CLEAR ACRYLIC (10 PCS) ☆COLOR LED : 2 PCS. (ORANGE) ☆WELDED WIRES : 2 PCS. ☆CONTACT PLATE : 6 PCS. ☆METAL CHAIN : 2 PCS. ☆METAL HOLLOW TUBES : 8 PCS. ☆CUP-SCREWS & NUTS: 17 PCS & 12 PCS ☆GROSS WEIGHT : 390G (SINGLE SET) ; 890G (DUAL SET).

1/100 SCALE | HIGH SPEC. PLASTIC INJECTION
MODEL KIT OPTIONAL ACCESSORIES

30MM "LED" GATLING GUN

MATERIALS

ABS / TPU / SCREWS
LED / CONNECTOR
PHOTO ETCH

NO BATTERY IS PROVIDED

智樂玩具 hobby collections

2/FLL, BLOCK A, JI XIA INDUSTRIAL ESTATE, JI XIA VILLAGE, DA PANG DE,
DONGGUAN CITY, GUANGDONG PROVINCE, CHINA.

WARNING ☆This product is designed for ages 15 and up. Please read these instructions herebelow and also the "Assembly Manual" carefully as well before use. ☆The packing materials serve as a media of protection for the product only, please make appropriate handling when disposed. ☆There are relatively tiny and sharp components in this package. Please handle it with care to avoid getting injured or swallowed by children accordingly. Strongly recommended to place the package at a safe location where it is not easily reachable by children younger than 15. **INSTRUCTION** ☆Please take special care when opening the package, avoiding it from being made upside down or arrogant handling which may lead to a loss of components due to a unconscious leakage of them from the package. ☆Please well-count all the components and accessories according to the Parts List shown on the "Assembly Manual", before the use of the product. ☆There may be some slight difference between the physical product and the pictures shown on the printing materials or other official media. ☆To ensure a long lasting adhesion, we suggest user to apply a little instant glue to certain tiny parts during assembly. ☆Please don't place the package under a high temperature environment to avoid deformation of components and the packaging materials. ☆The product is accompanied with many electronic accessories in pursuit of the LED system. Please follow the instructions of "Assembly Manual" about the relative priority of each step of assembly, and avoid unnecessary mistakes caused.



AGES 15 &
UP ONLY



APPLIED
WITH LED



CHOKING
HAZARD



RECYCLE
OF PAPER



ASSEMBLING
MODEL KIT



RECYCLE OF
PLASTIC BAG

PART LIST

PART A ABS (X1)

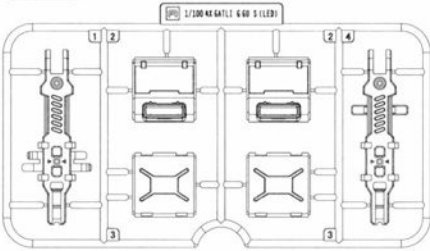

PART B ABS (X1)

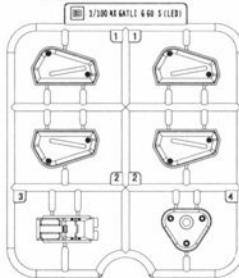

PART C ABS (X2)

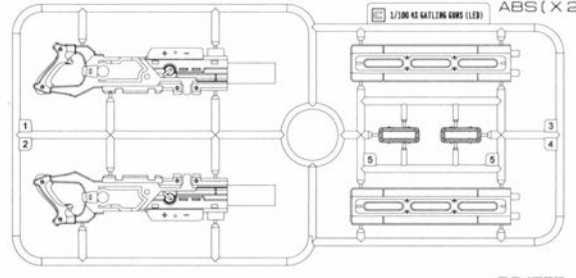

PART D ABS (X2)

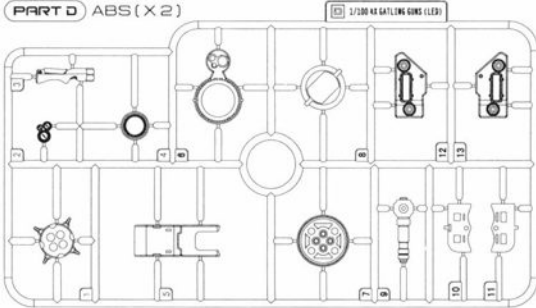

PART E ABS (X2)

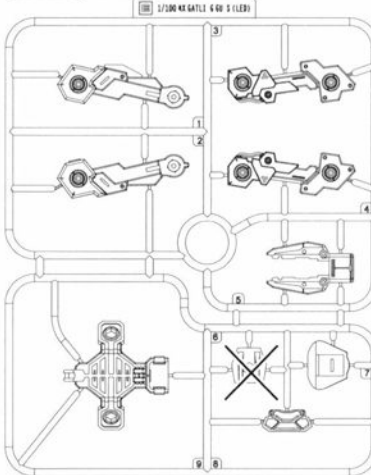

PART F

COATED ABS (X1)

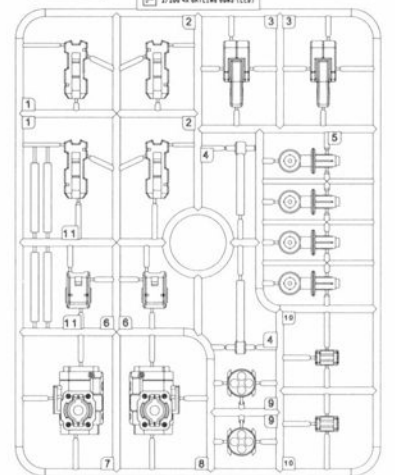

PART G ABS (X2)

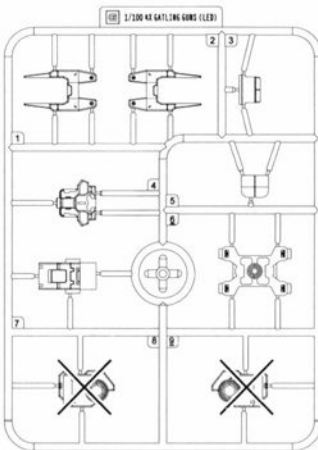

PART I TPU (X1)

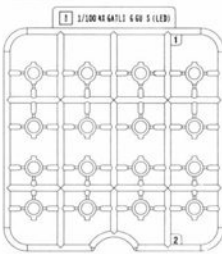

PART J ABS (X1)

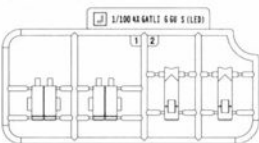

PART K ABS (X1)

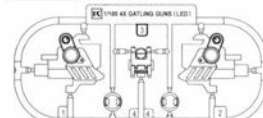

M-1 (X4)



M-3 ETCH (X1)



LED (X2)



M-2 (X2)



M-5 (X8)

METAL TUBE

M-4 (X2)



METAL CHAIN

PART H CLEAR PS (X1)

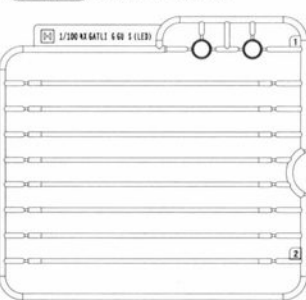

S-1 (X4)



S-2 (X1)



S-3 (X6)



S-4 (X4)



S-5 (X2)



S-6 (X12)



CONNECTOR & POWER SWITCH



M-6 (X2)

ASSEMBLY STEPS

2

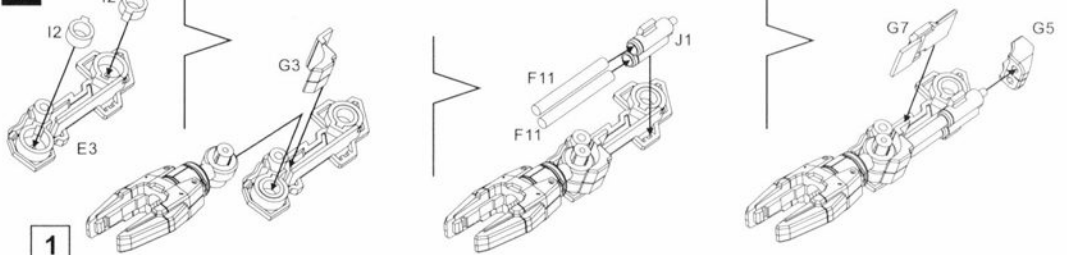

1

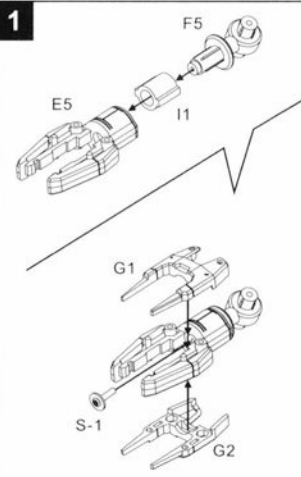

3

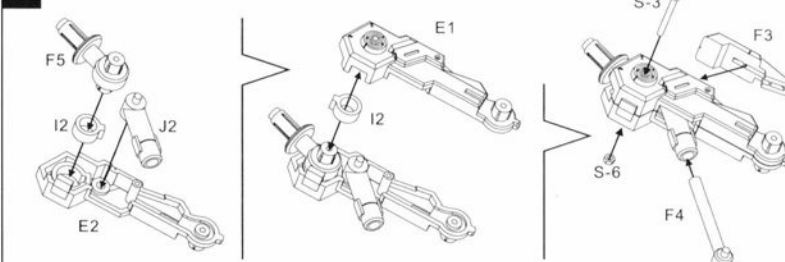

4

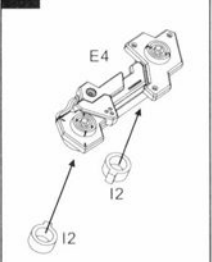

ASSEMBLY STEPS

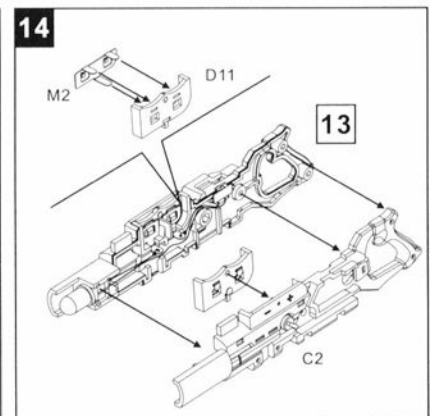
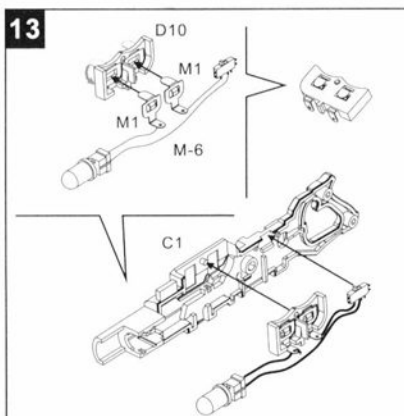
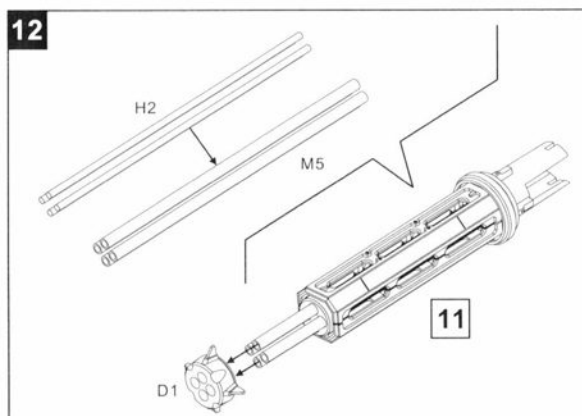
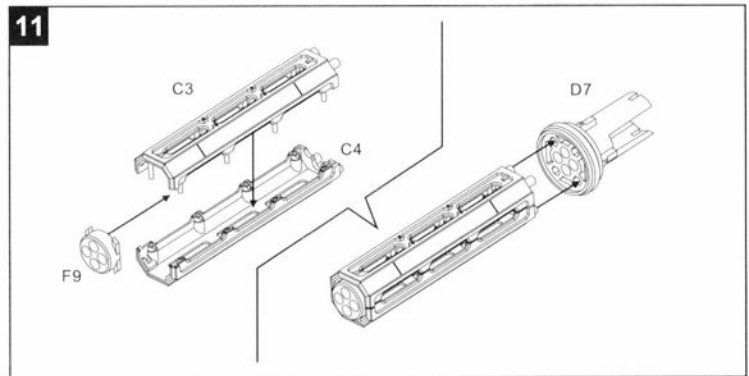
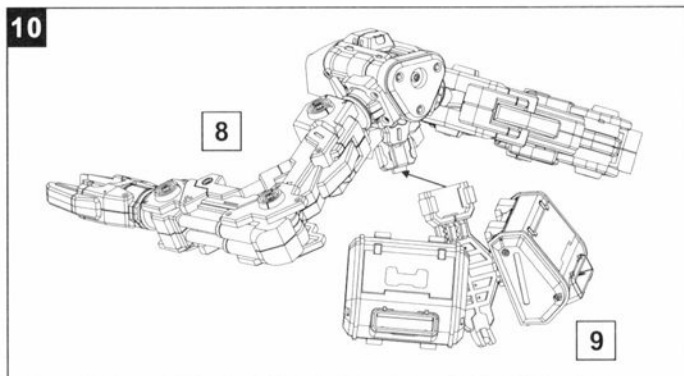
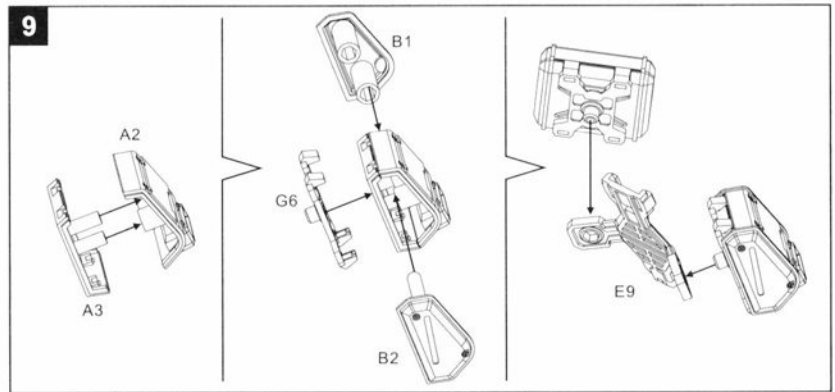
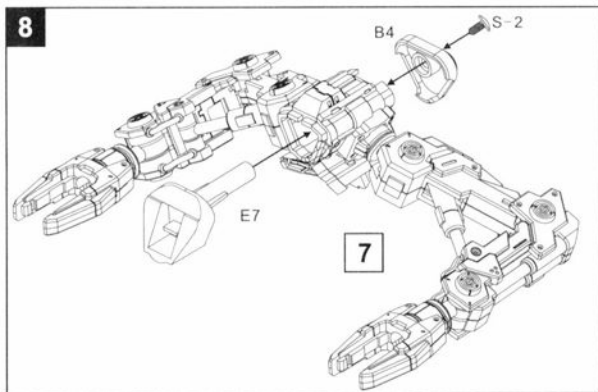
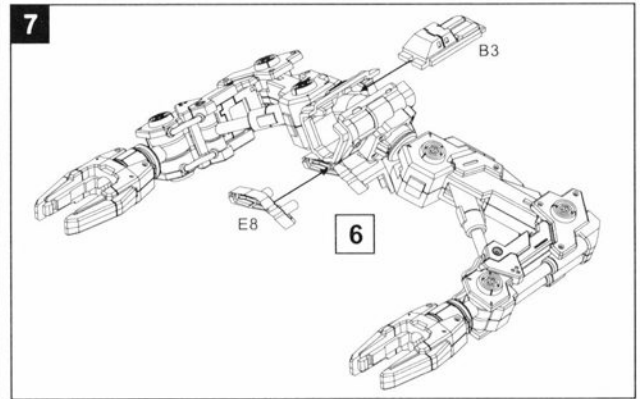
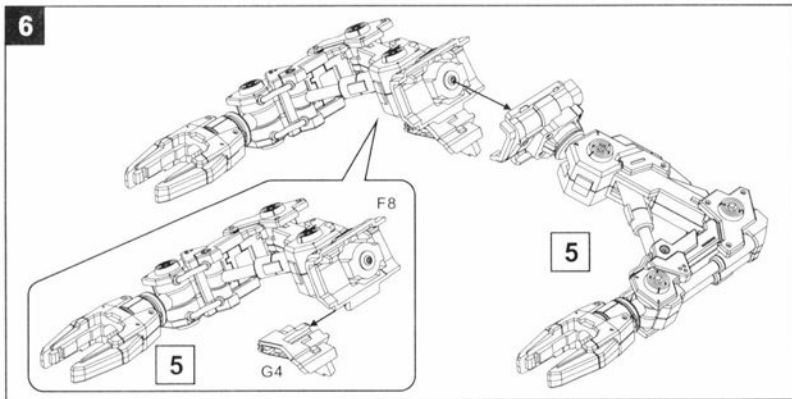
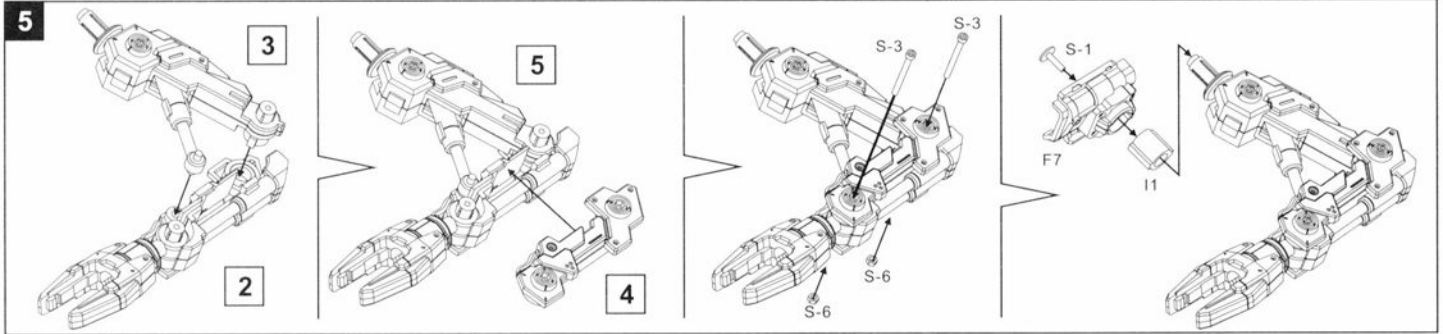

ASSEMBLY STEPS

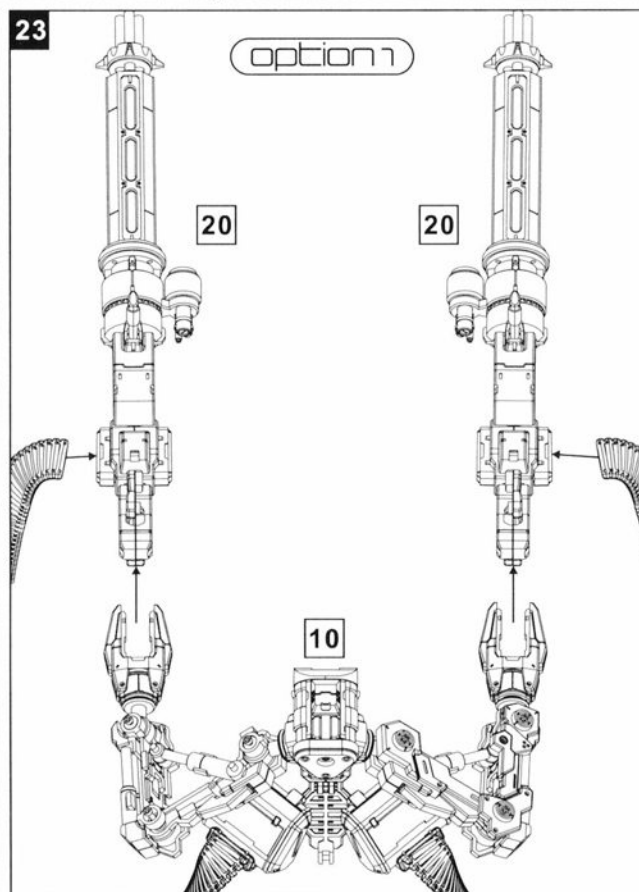
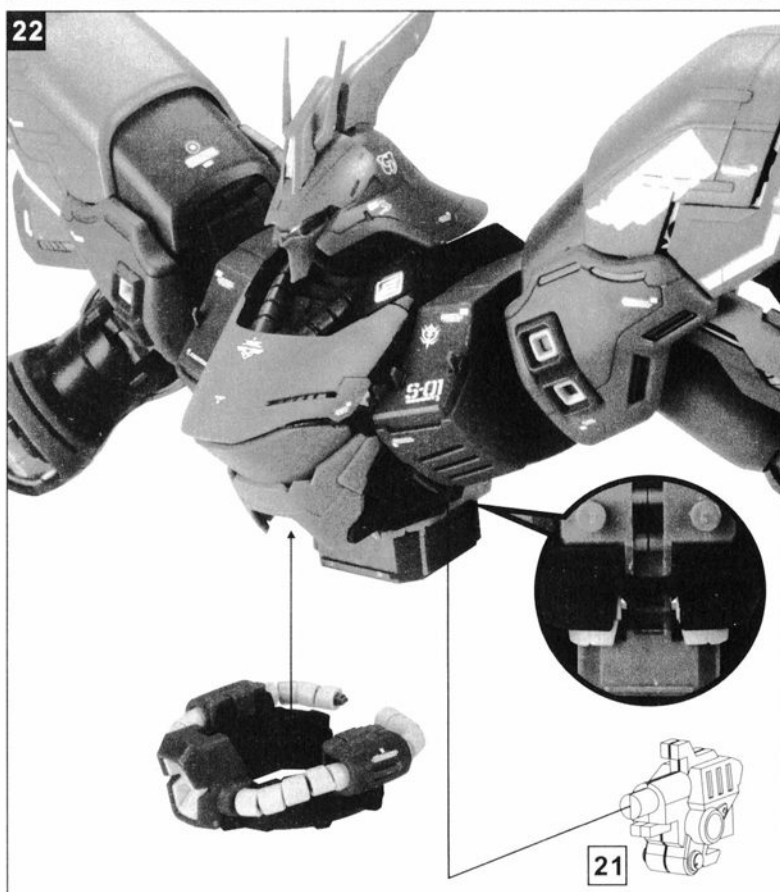
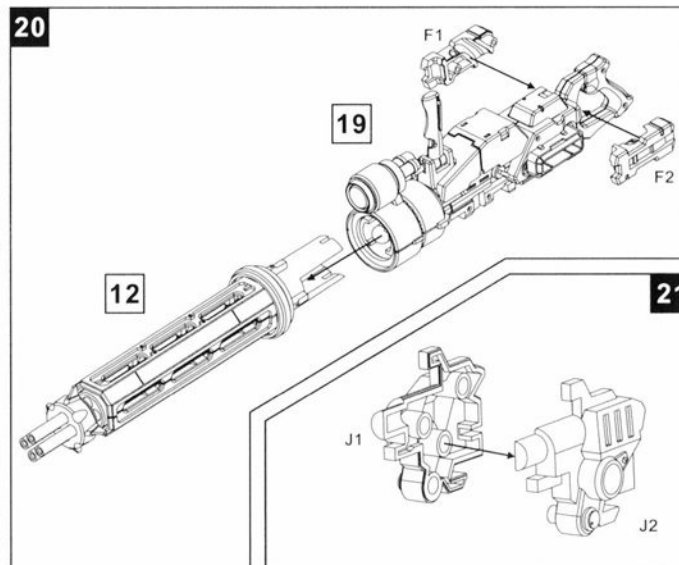
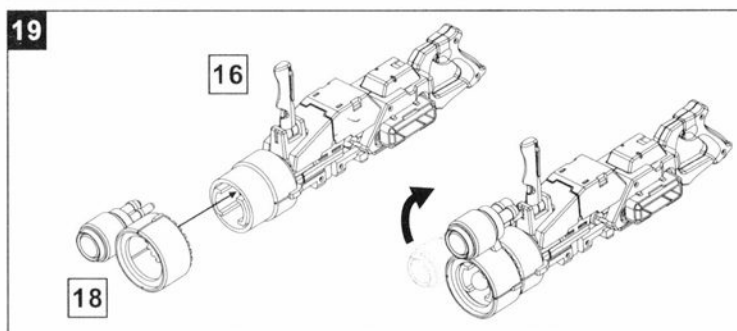
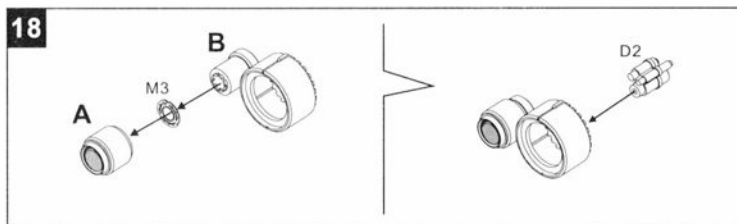
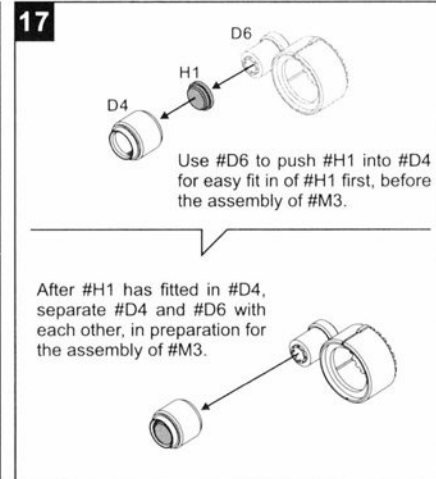
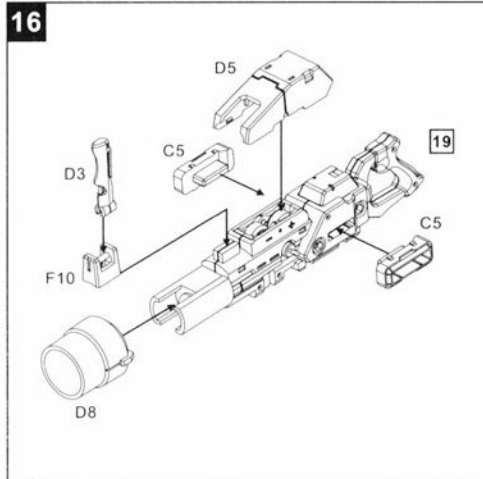
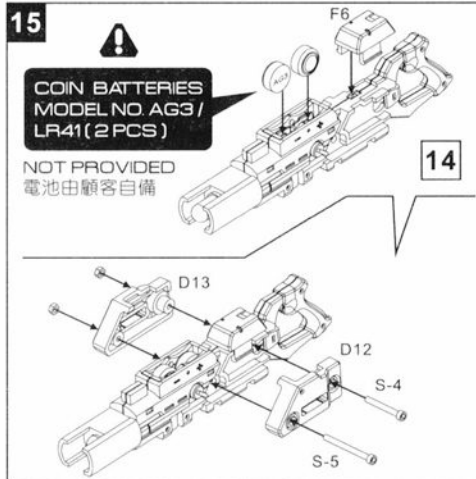

24

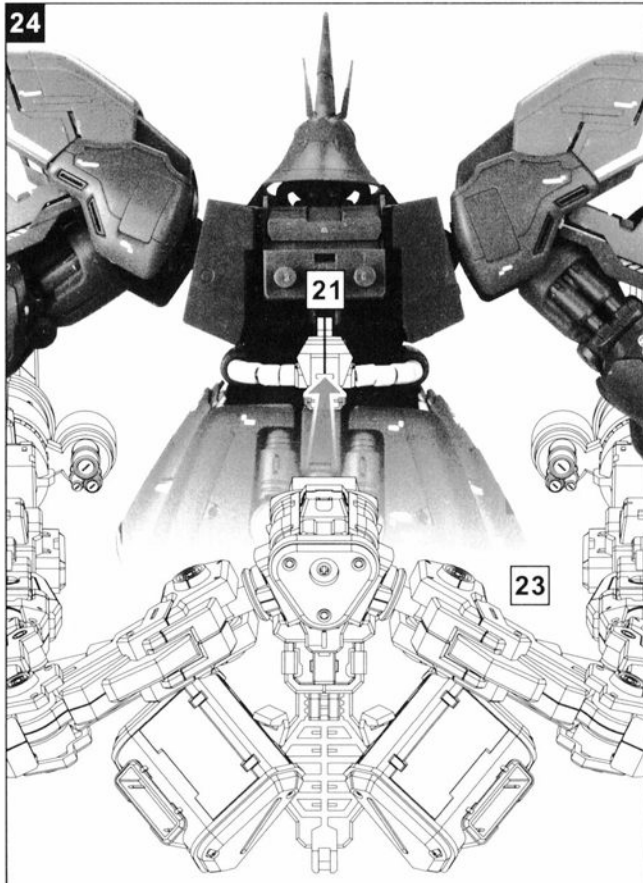

26

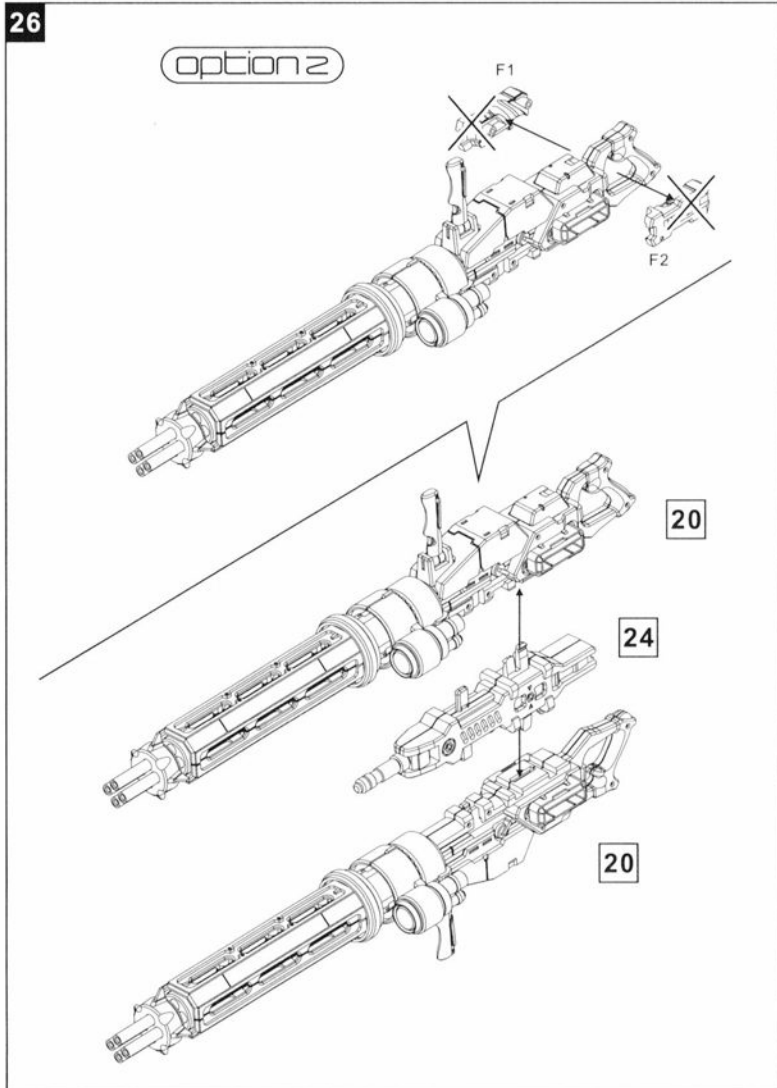

25

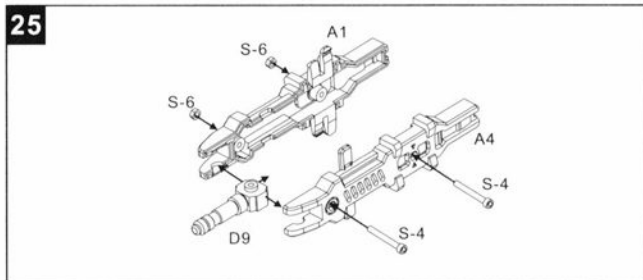

27

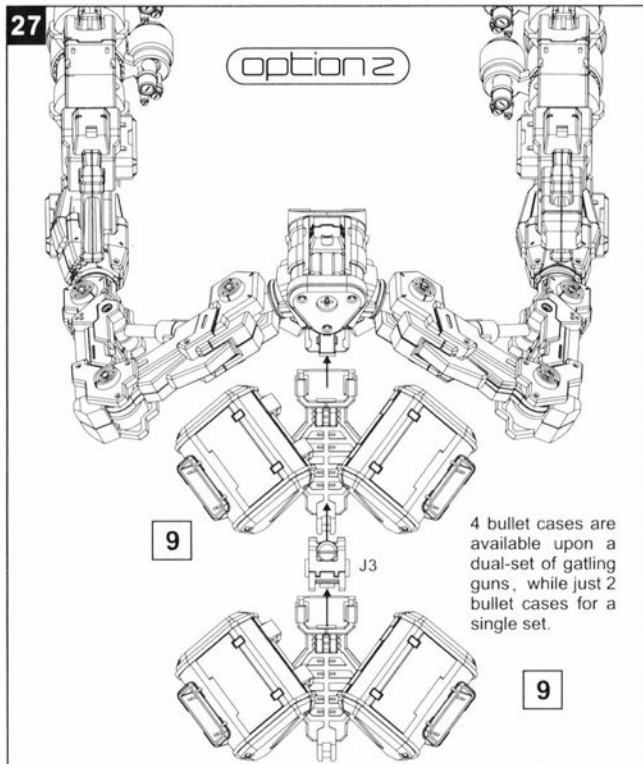

28

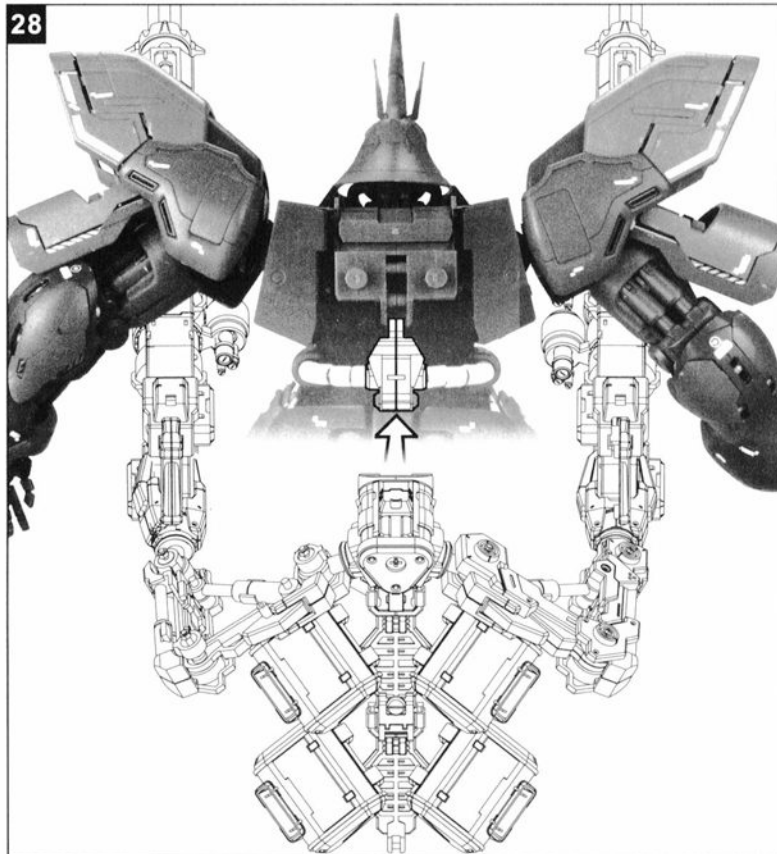

ASSEMBLY STEPS

29

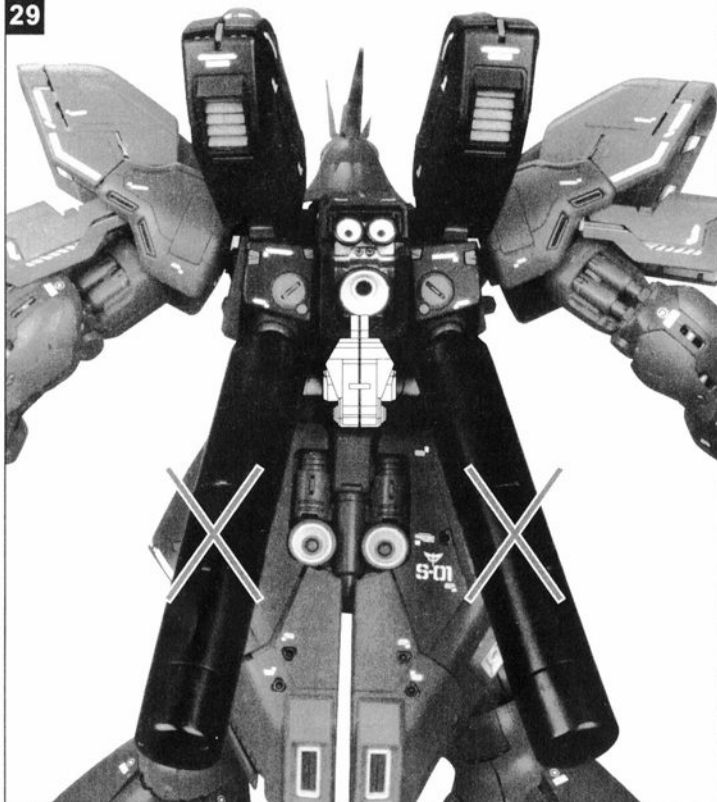

30

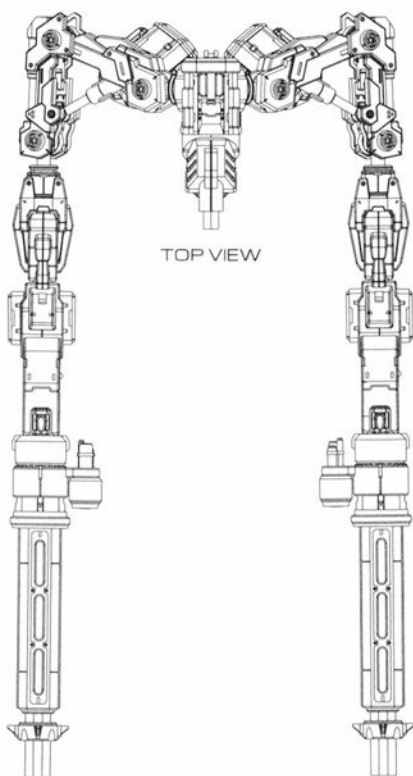
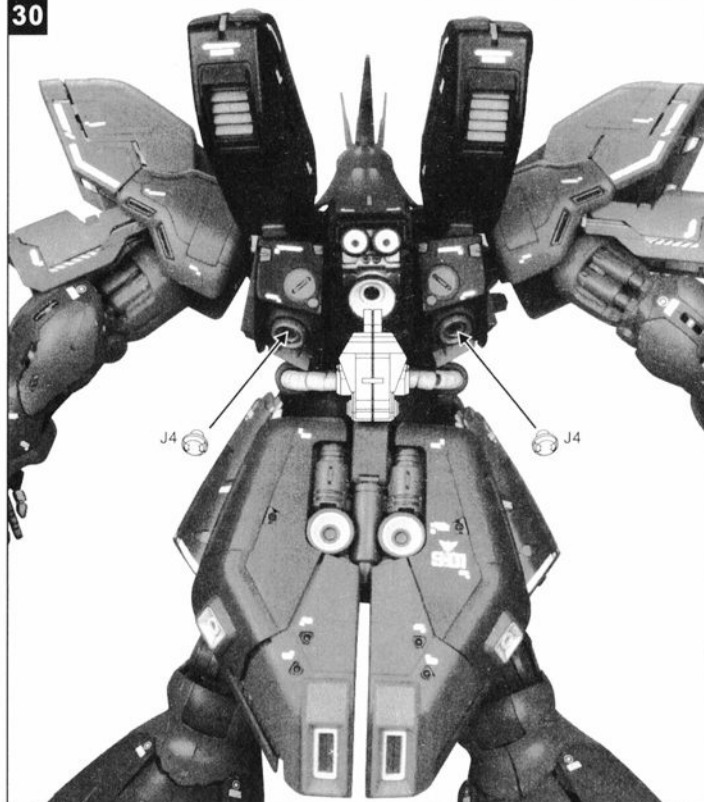

TOP VIEW

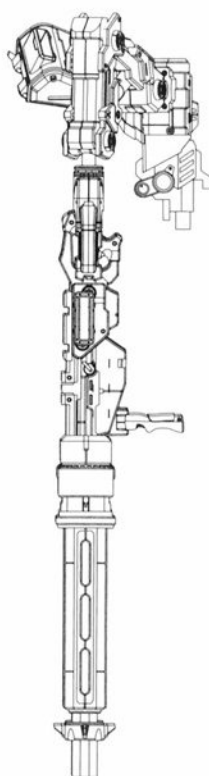

SIDE VIEW

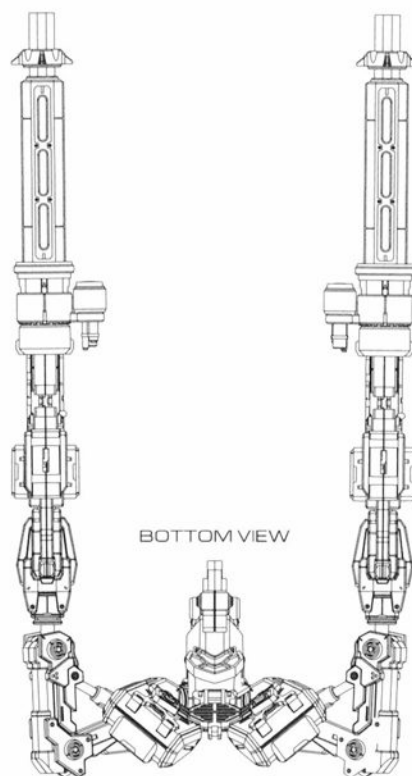

BOTTOM VIEW

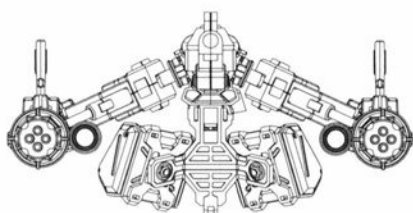

FRONT VIEW

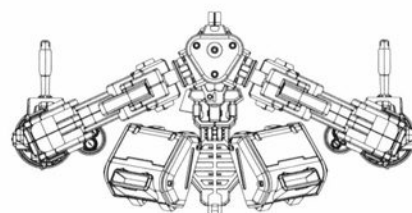

REAR VIEW