



1:35

Head Desktop Model



**Hi**  
RX-93

AE-E-FS-F

*Head Desktop Model*  
**νGUNDAM.**



### 【组装时注意】

- ◆ 组装前请详细阅读说明书。
- ◆ 请将零件按编号整齐组装，组装后把边角料丢弃。
- ◆ 零配件当中有带尖锐或刺手的，在组装时请小心。
- ◆ 建议在涂装粘贴时使用安全的“水性涂料”。

### 【NOTICE WHILE ASSEMBLING】

- ◆ Please read the instruction carefully before assembly.
- ◆ Please assemble the parts as per serial numbers and discard the leftover material after assembly.
- ◆ While assembling, please pay attention that some of the parts may be sharp-pointed or aciculate.
- ◆ Please use the safe "aqueous coating" while painting.

## 零件目录(PARTS LIST)

板件 A

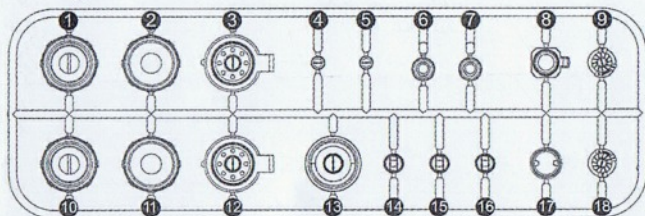

板件 B



板件 C

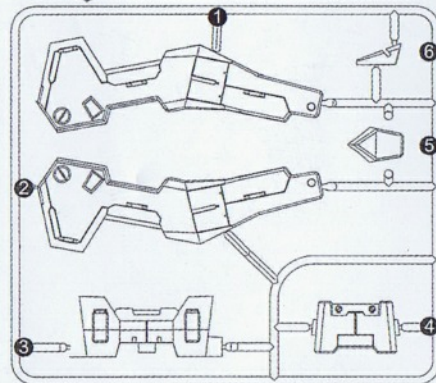

板件 D

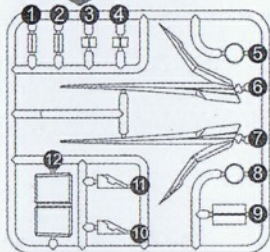

板件 J

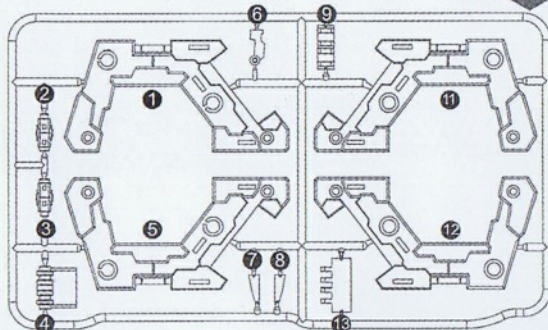

板件 K

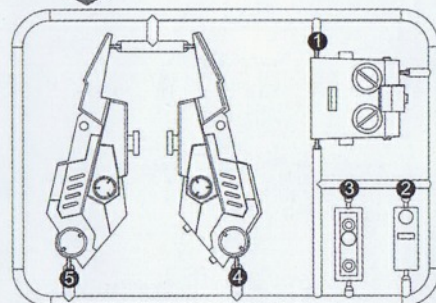

板件 E

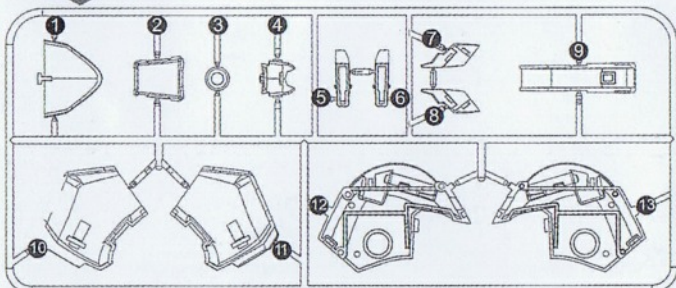

### 套件附带配件：

- ① 标志水贴X1
- ② 动力金属管X5
- ③ 发光电路组件X1

板件 G

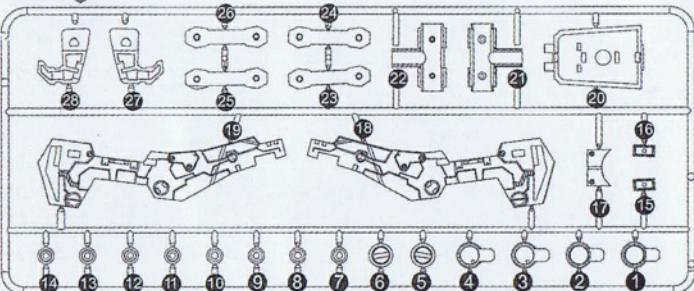

板件 I

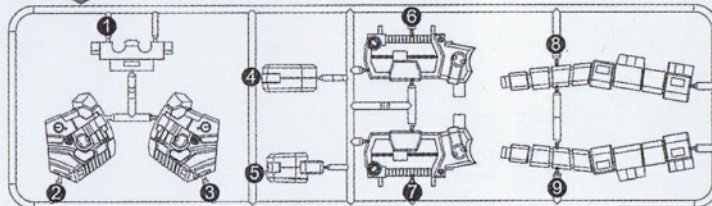

板件 H

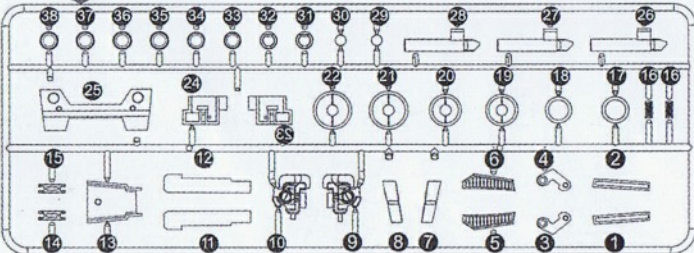

板件 F

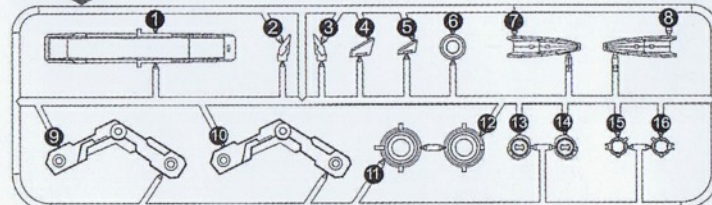

板件 L

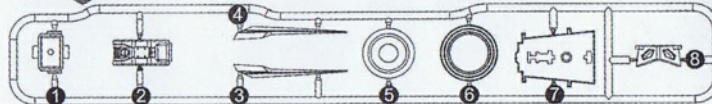







# 16 A14 ※该部位组装请与发光电路同时组装！

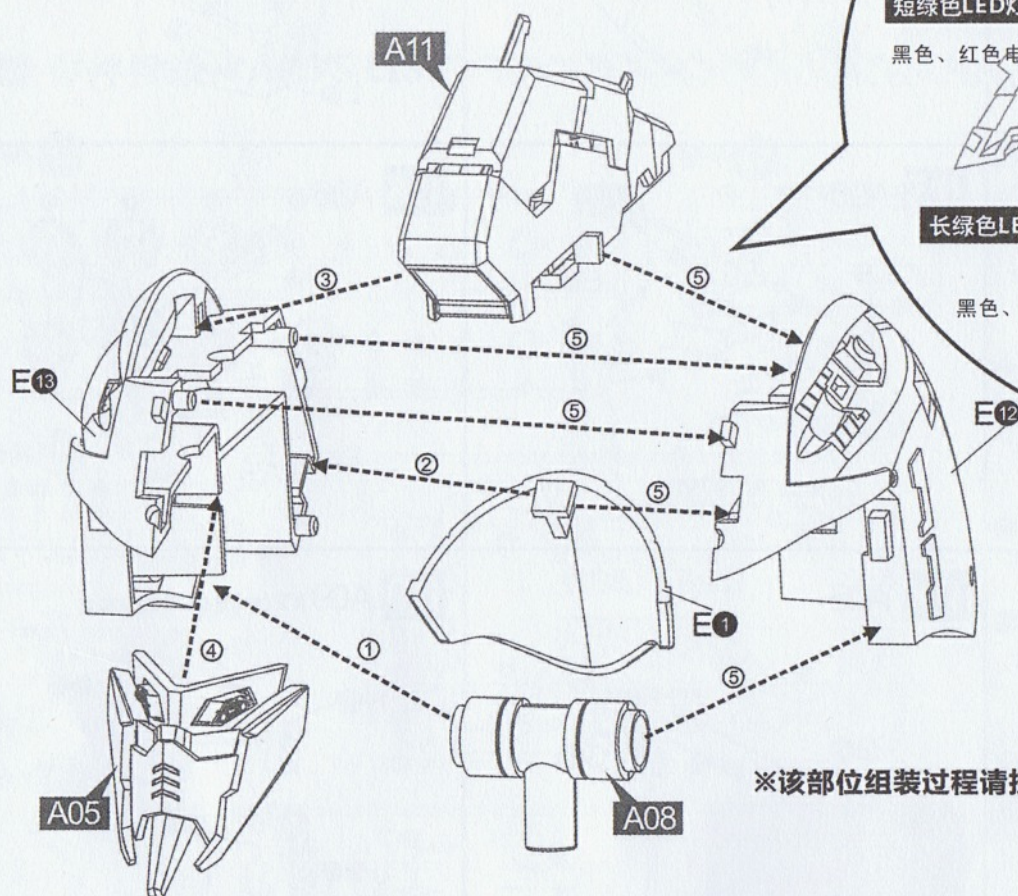

## 发光电路组装布线图

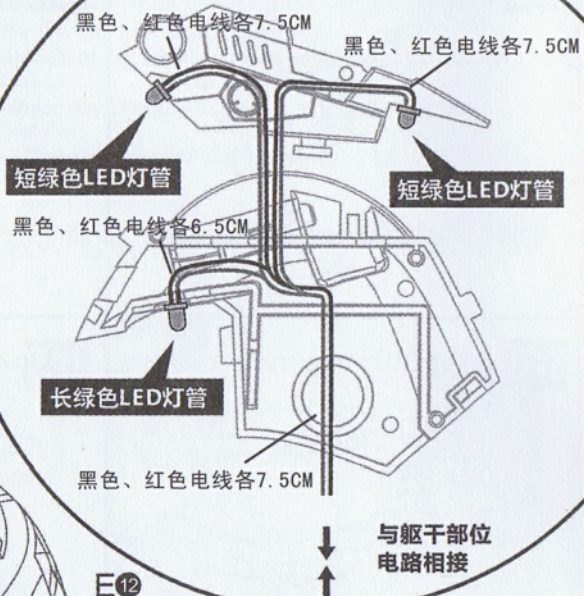

※该部位组装过程请按顺序进行！

# 17 A15

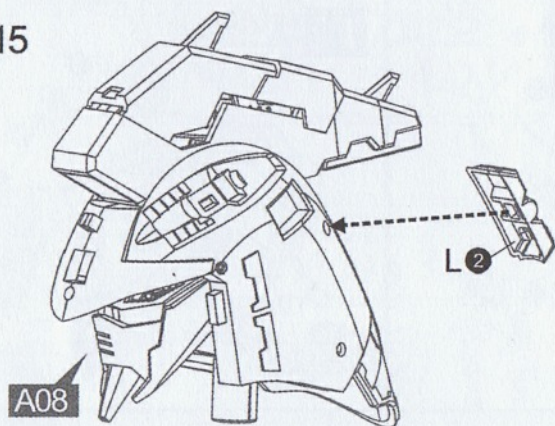

# 19 A17

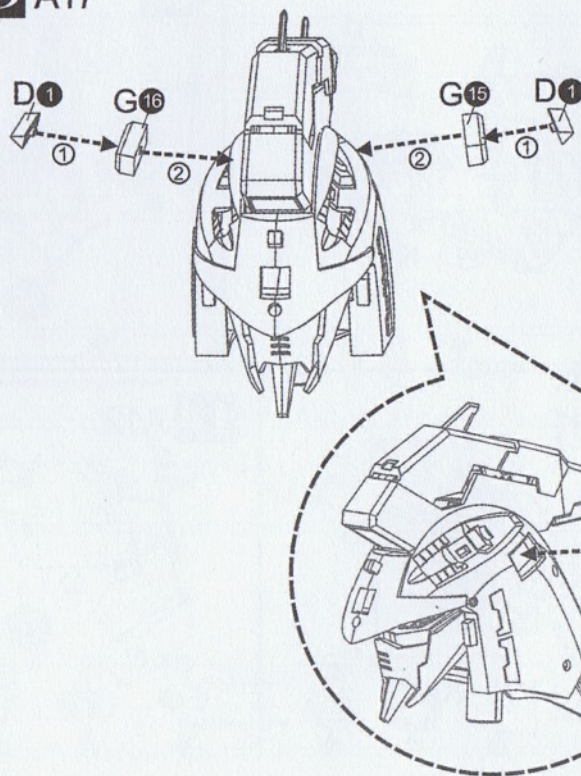

# 18 A16

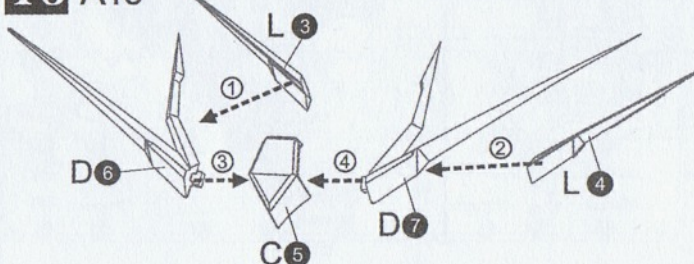



## 20 A18

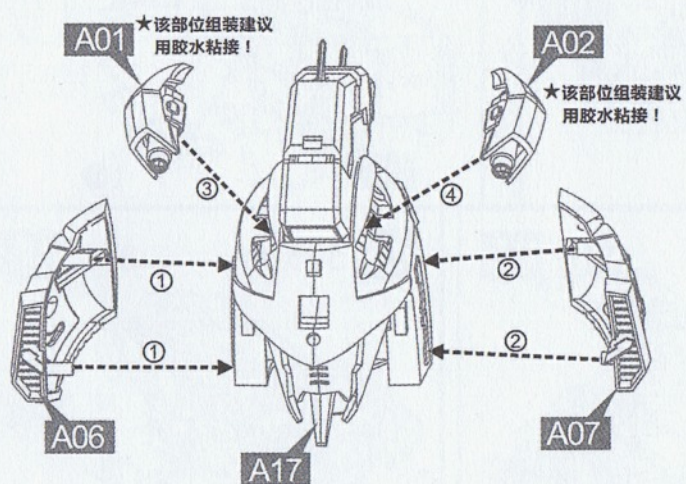

## 21 A19

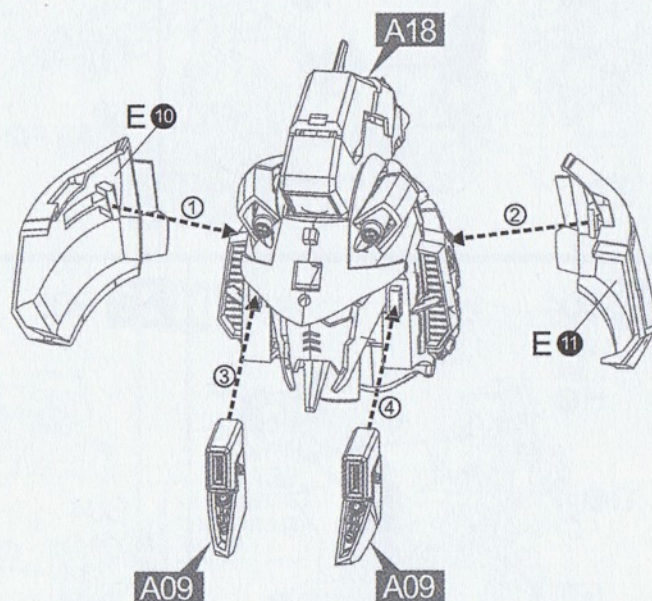

## 22 A20

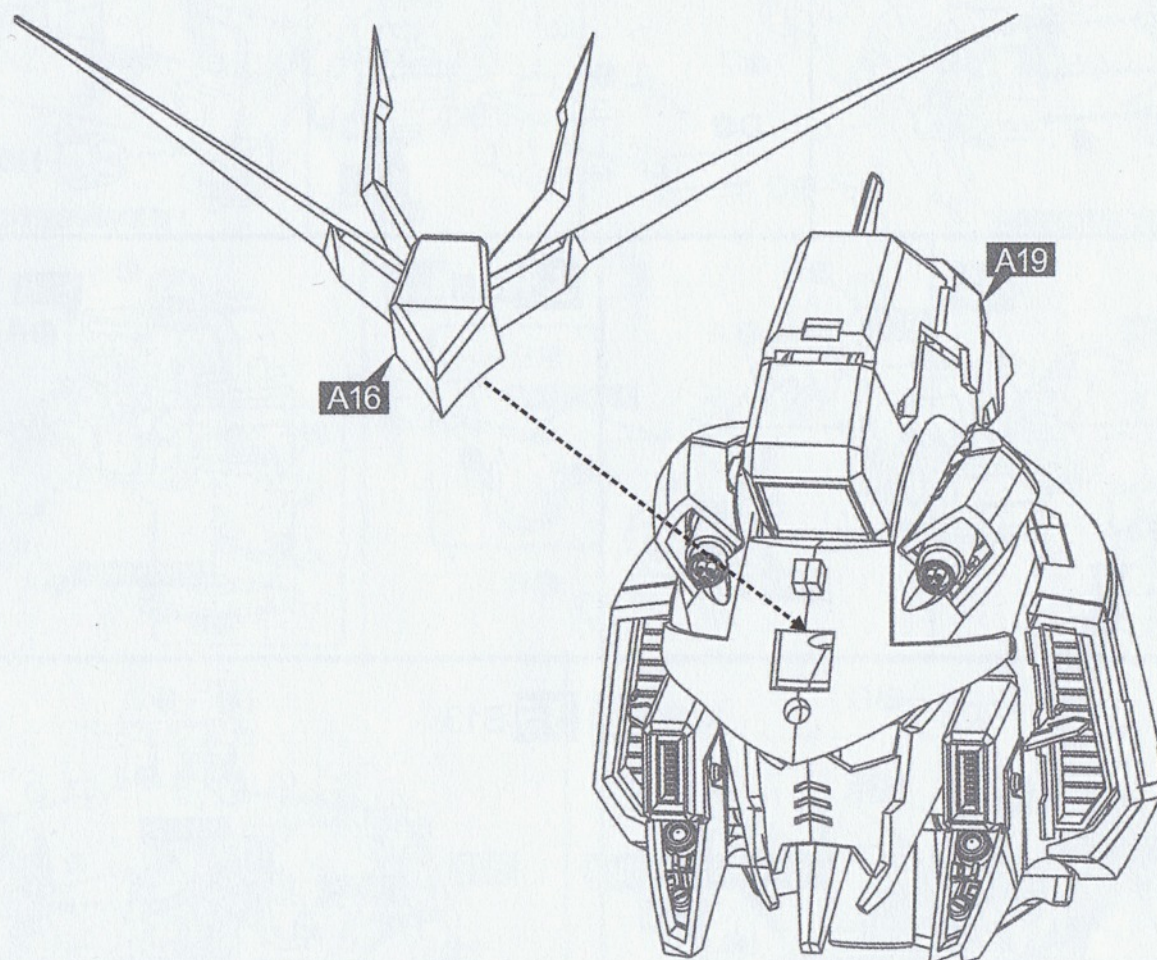



# 23 B01

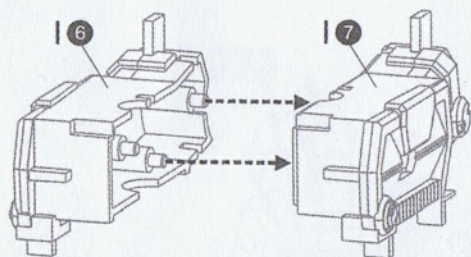

# 24 B02

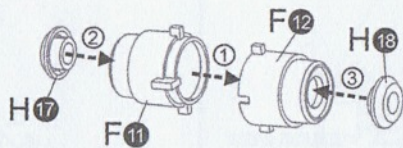

# 25 B03

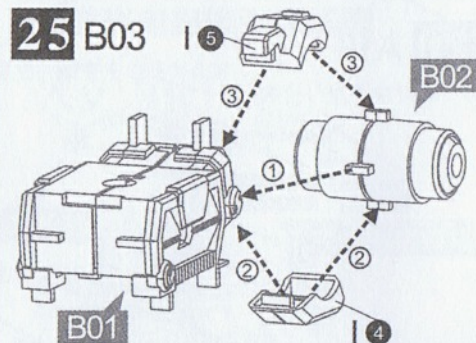

# 26 B04

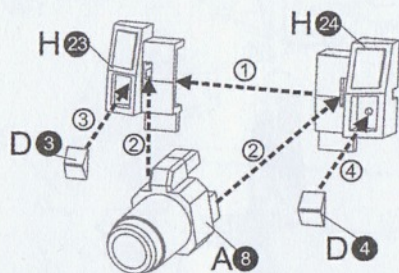

# 27 B05

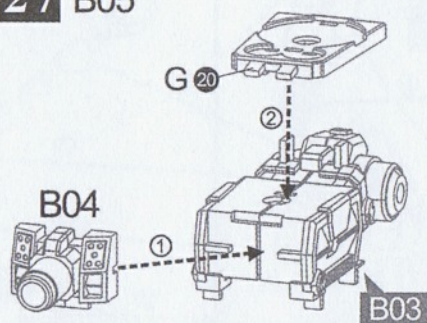

# 28 B06

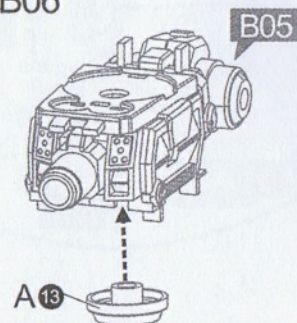

# 29 B07

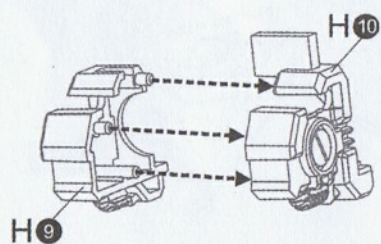

# 30 B08

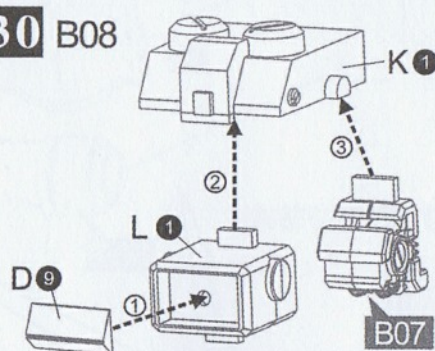

# 31 B09

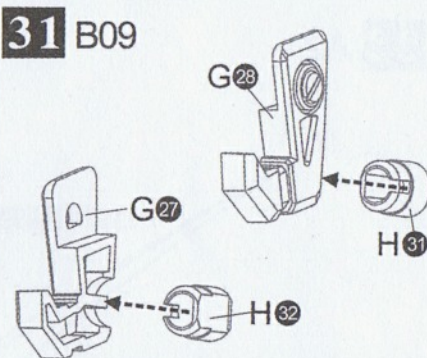

# 32 B10

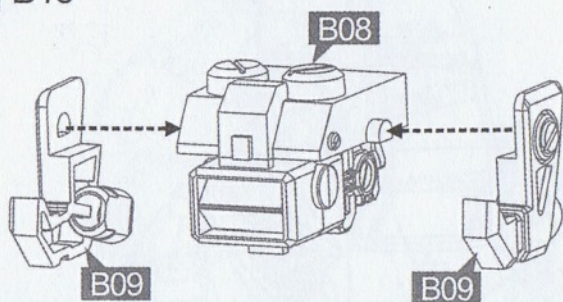

# 33 B11

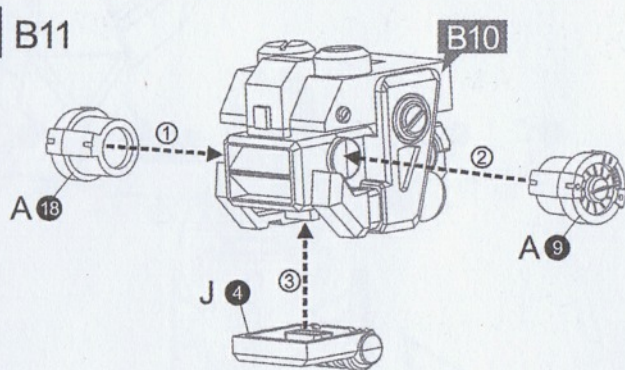

# 34 B12

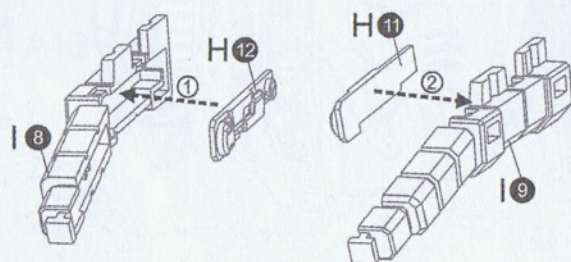

# 35 B13

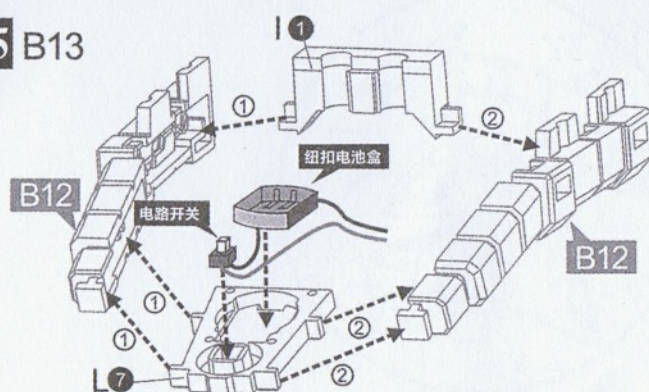



# 36 B14

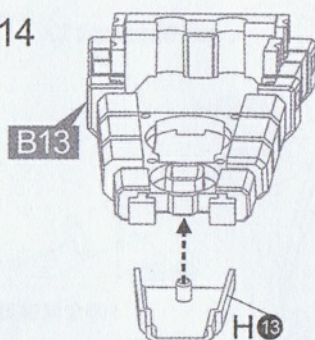

# 37 B15

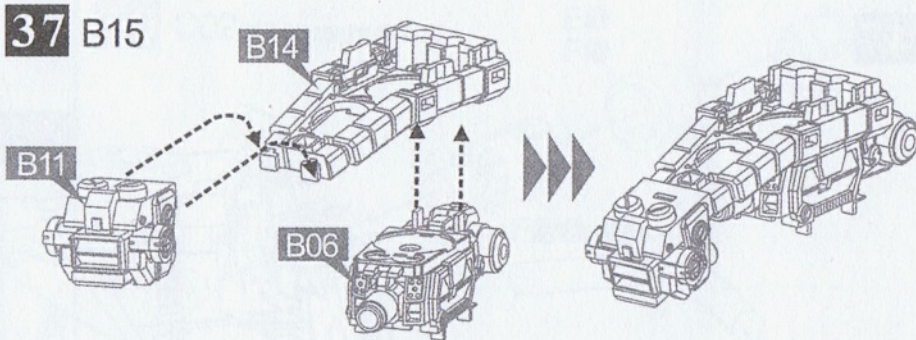

# 38 B16

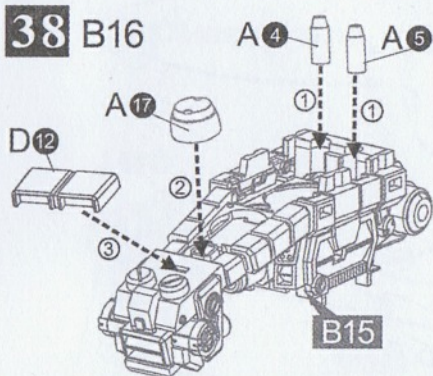

# 39 B17

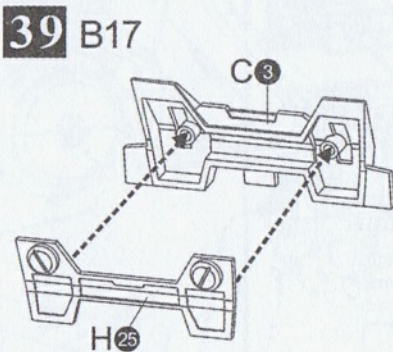

# 40 B18

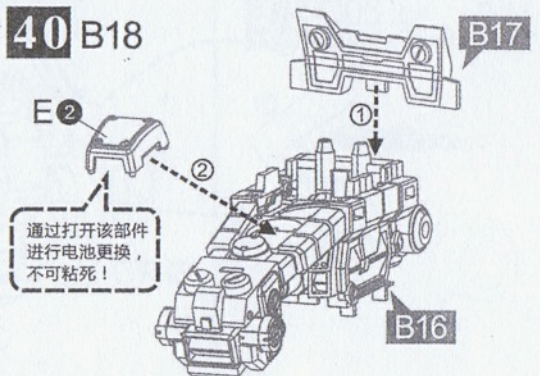

# 41 B19

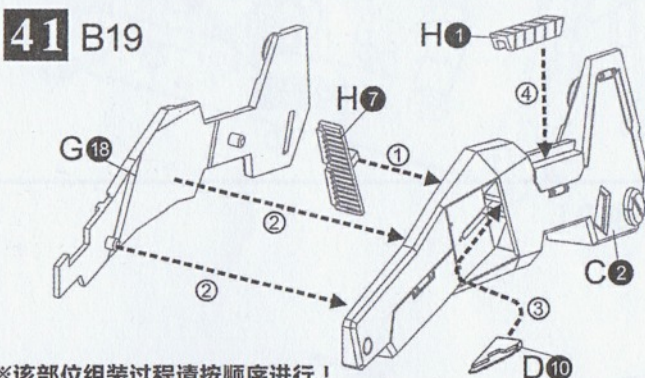

※该部位组装过程请按顺序进行!

# 42 B20

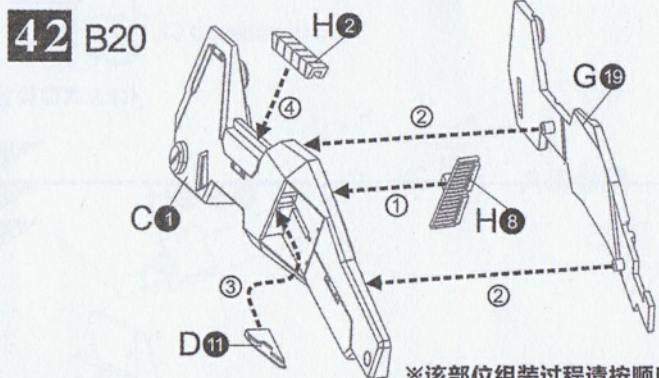

※该部位组装过程请按顺序进行!

# 43 B21

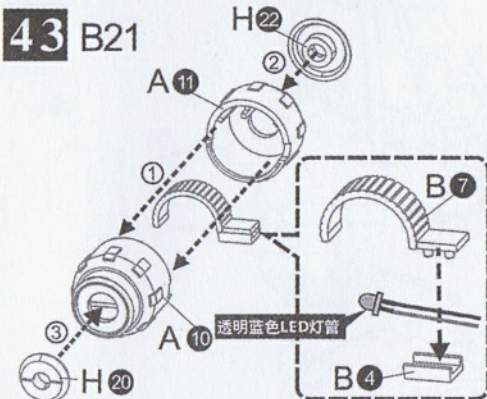

# 44 B22

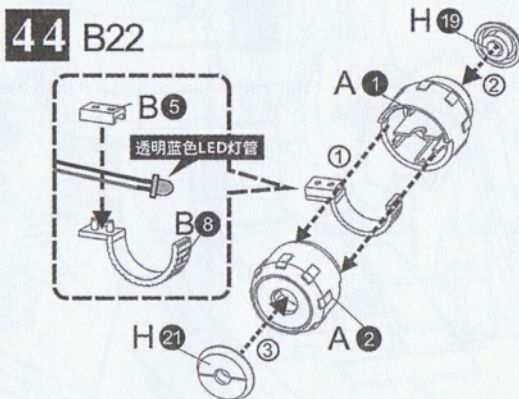

# 45

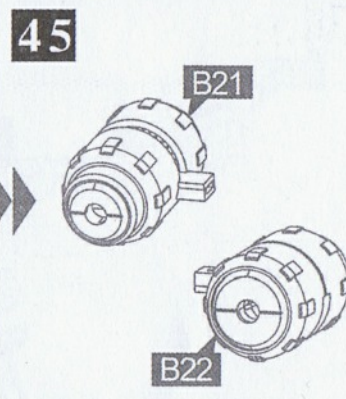

# 46 B23

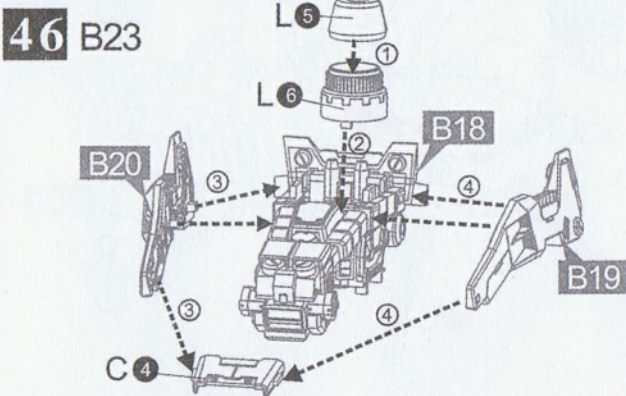

# 47 B24

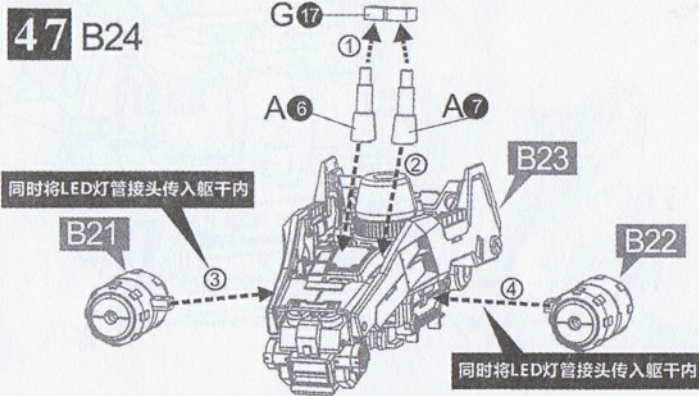



47

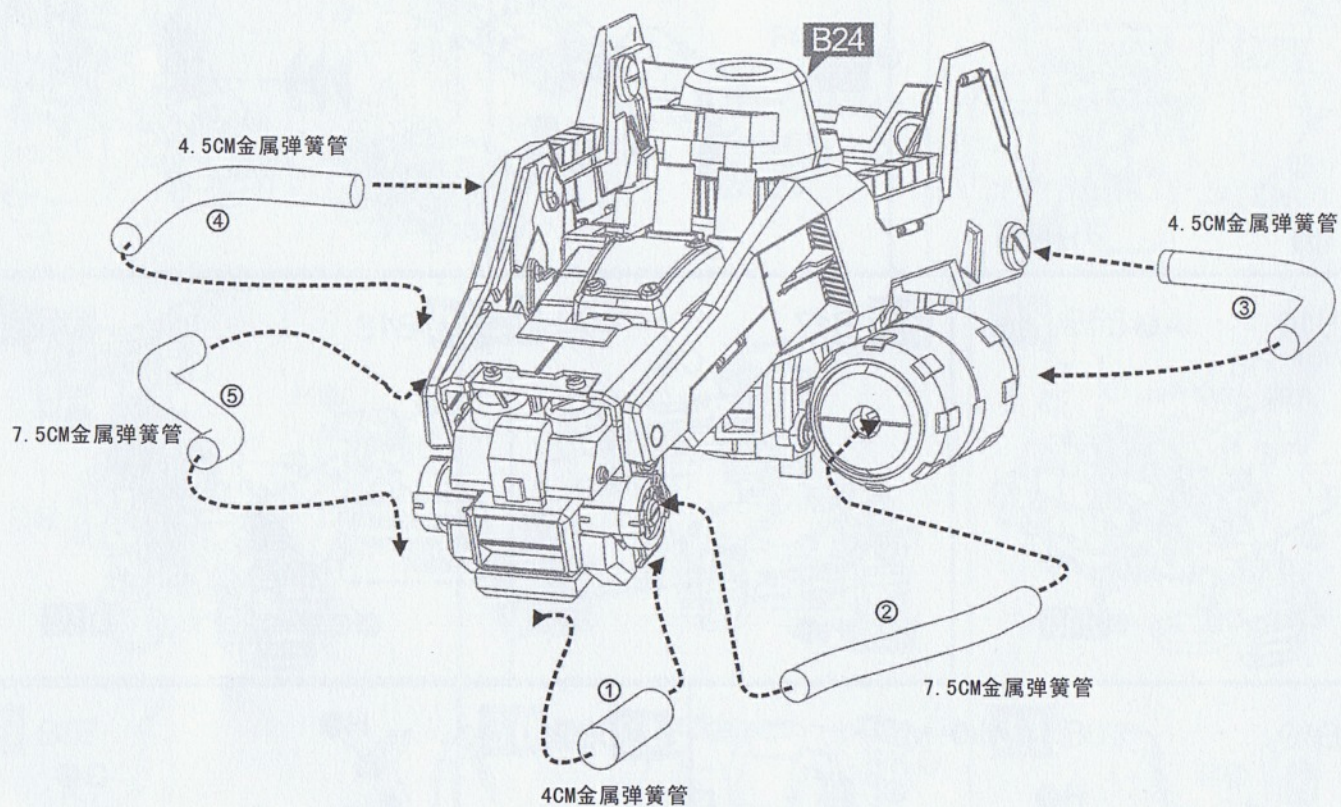

48 B25

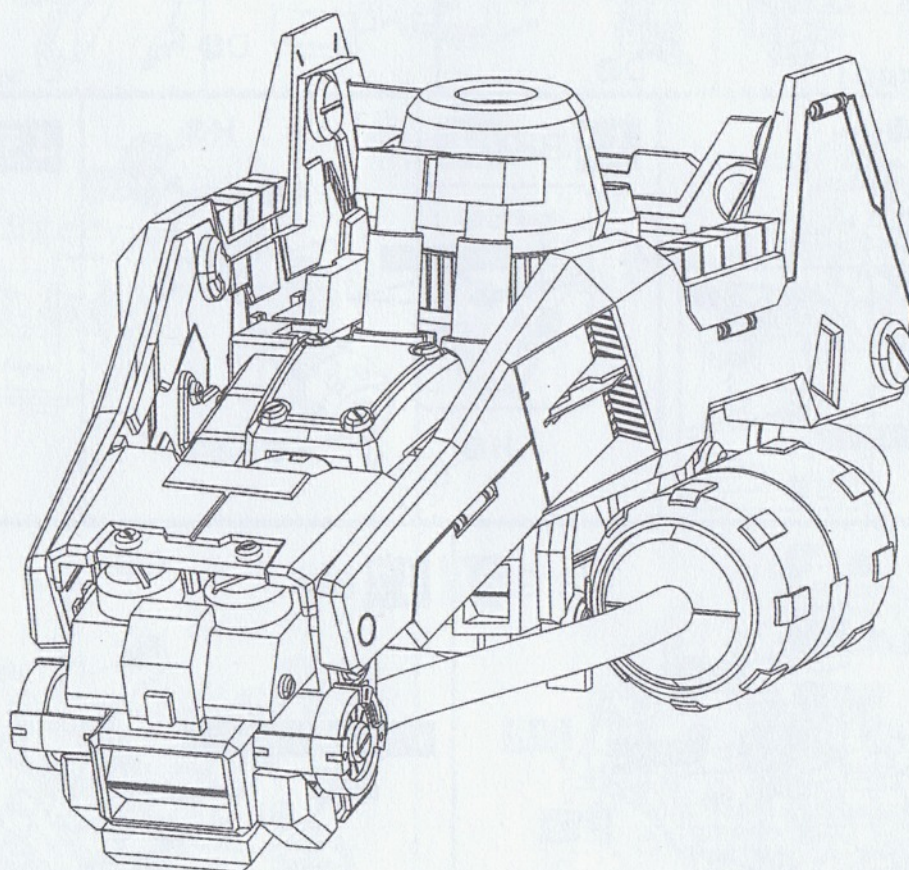



# 49 C01 X2(该过程需制作2组！)

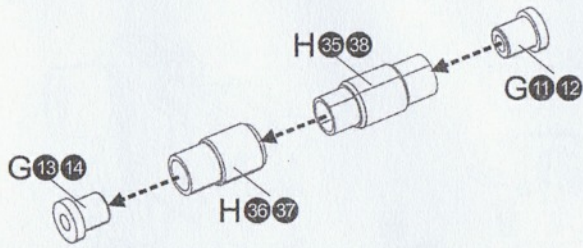

# 50 C02 X2(该过程需制作2组！)

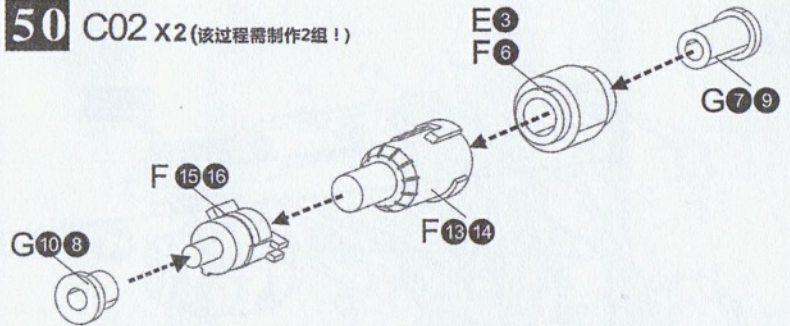

# 51 C03 X2(该过程需制作2组！)

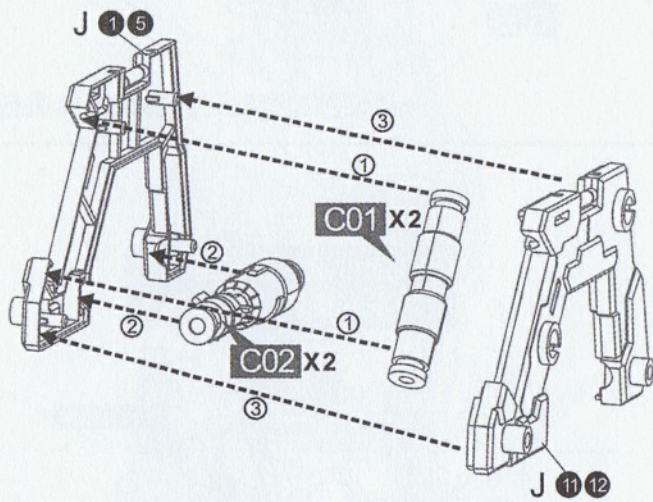

# 52 C04 X2(该过程需制作2组！)

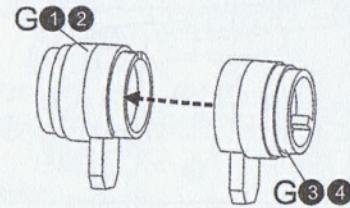

# 53 C05 X2(该过程需制作2组！)

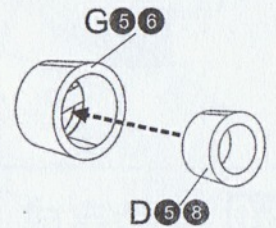

# 54 C06 X3(该过程需制作3组！)

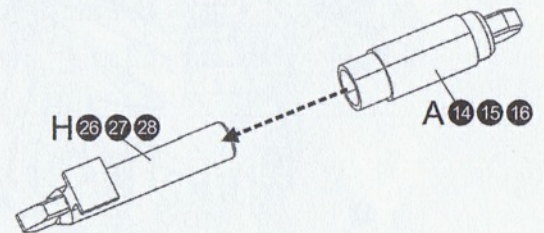

Scanned by www.plasticandplasters.com

# 55 C07

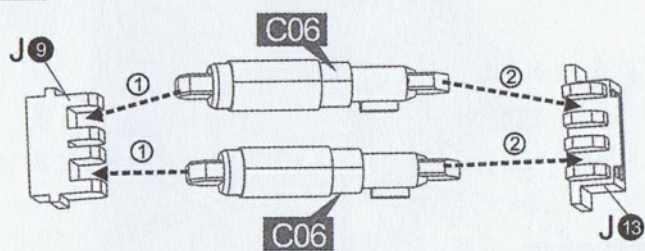

# 56 C08

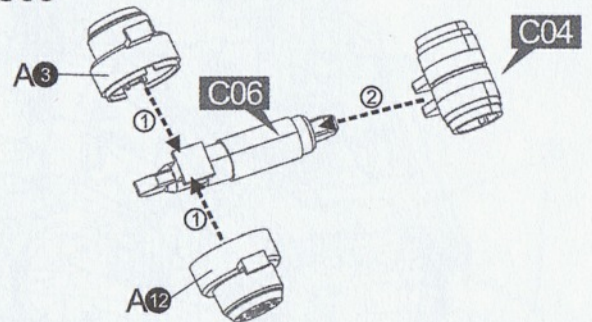

# 57 C09

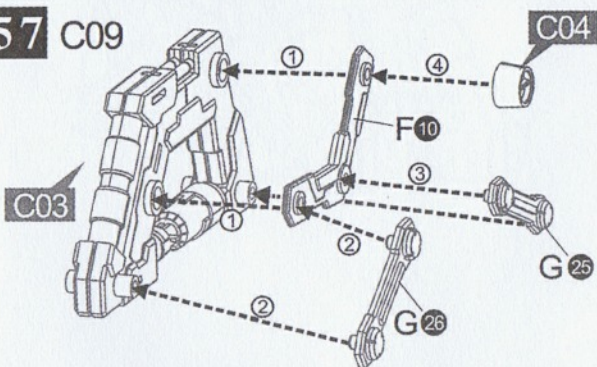

# 58 C10

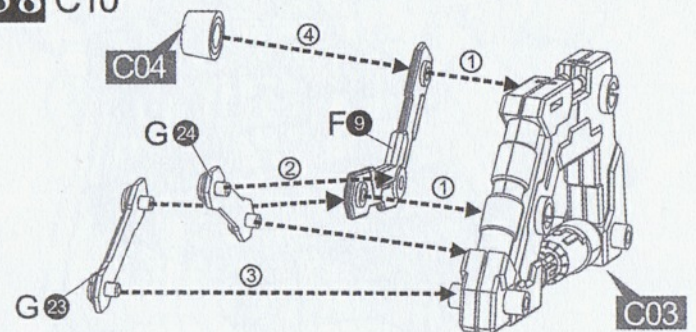



## 59 C11

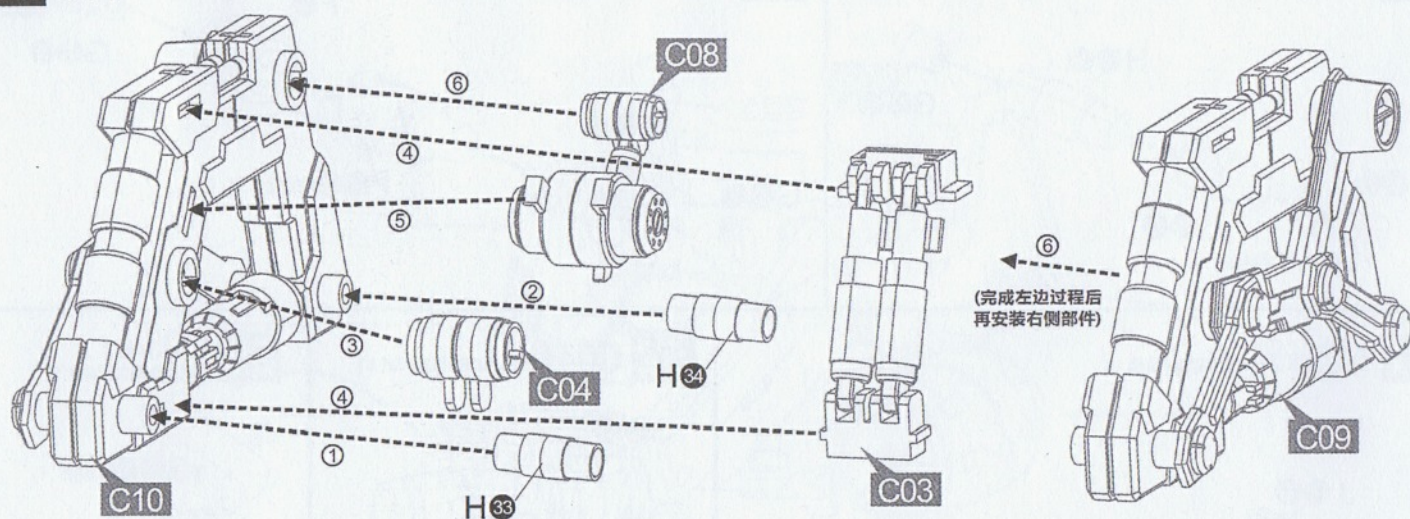

※该部位组装过程请按顺序进行！

## 60 组装完成

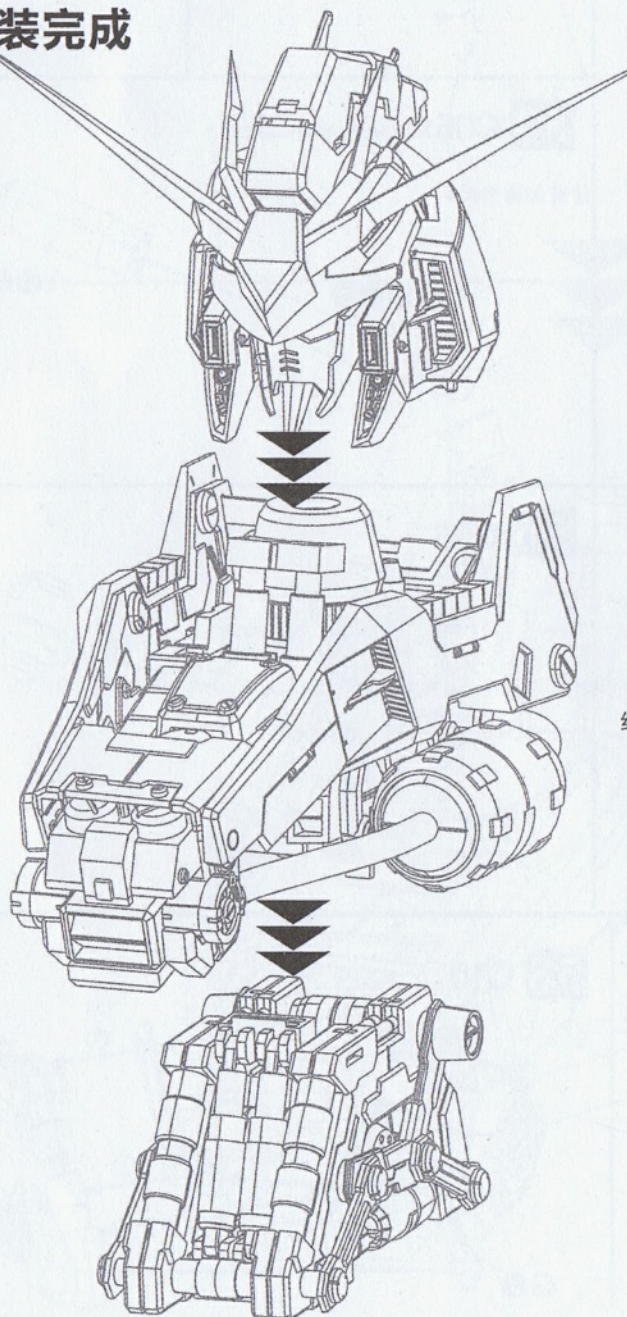

※该部位组装过程请同时将发光电路连接起来！

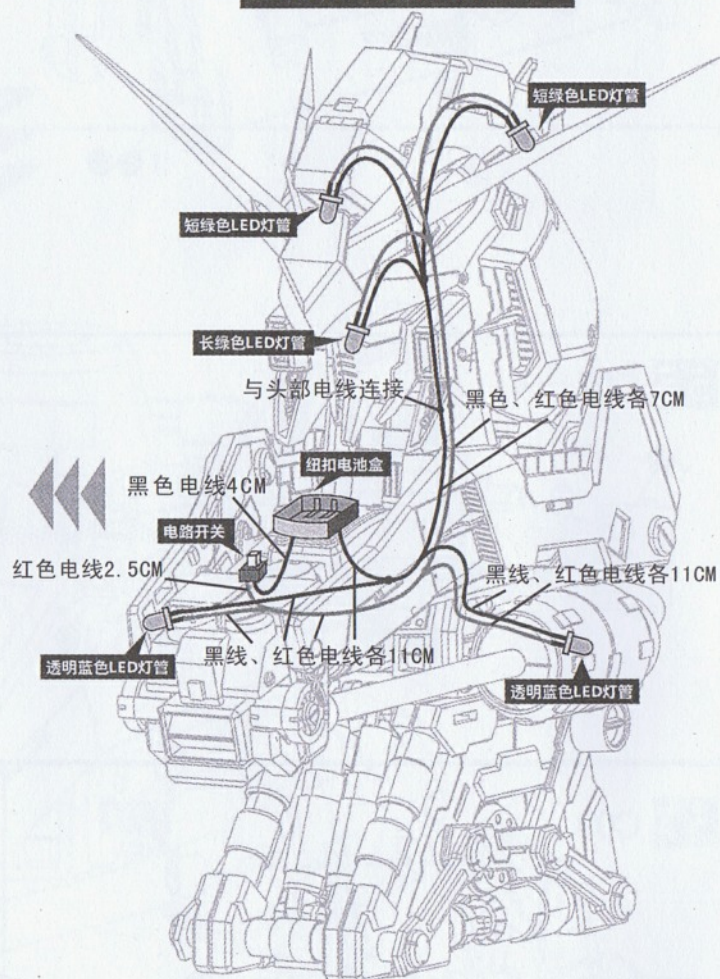



水贴指示范例

侧面指示范例

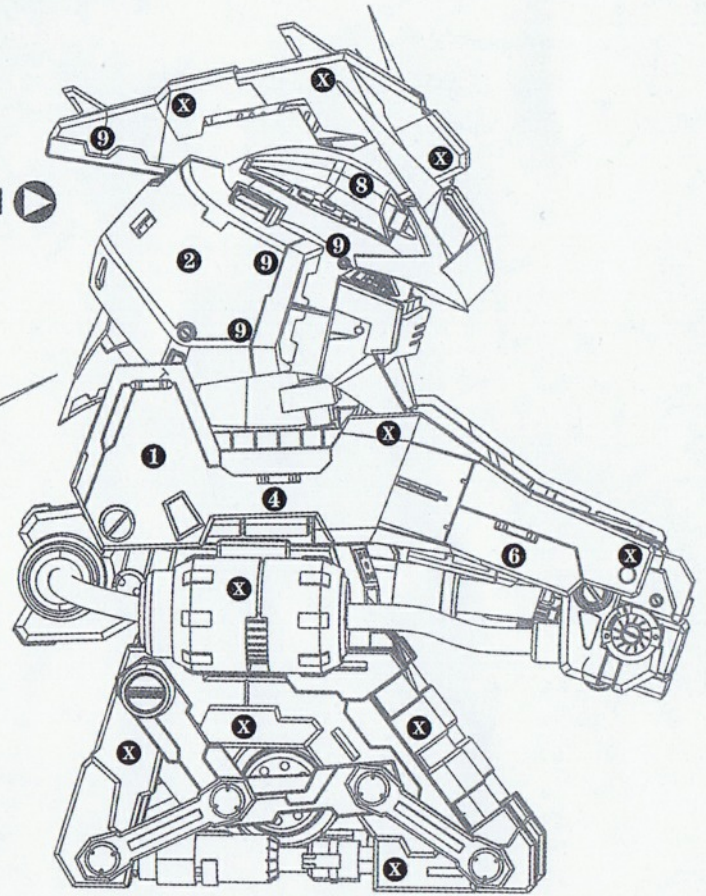

正面指示范例

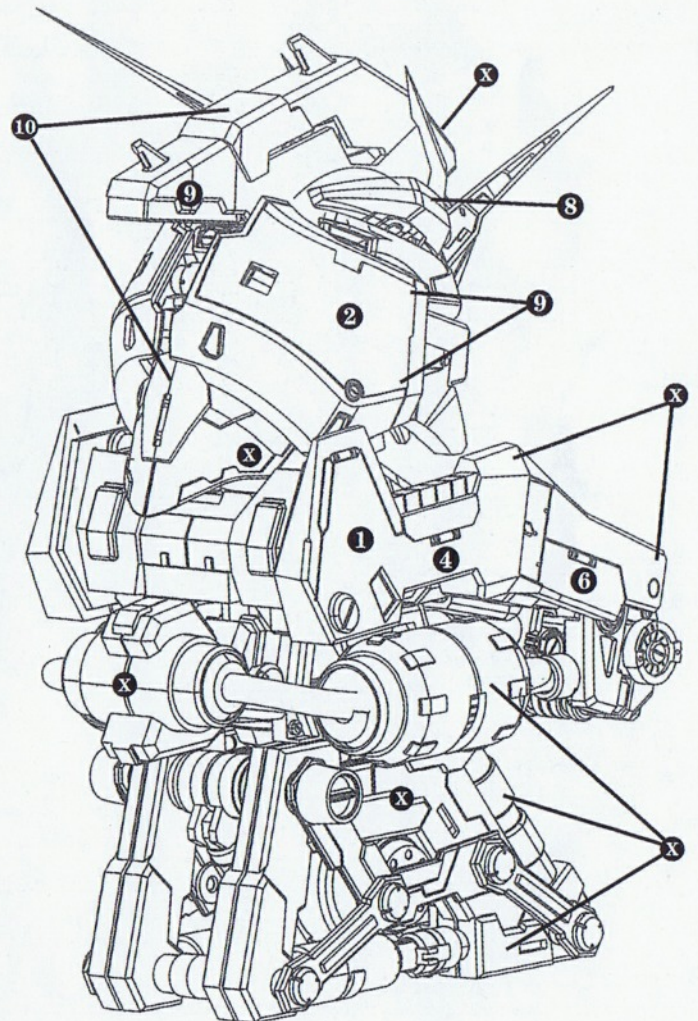



*Head Desktop Model*  
**Hi-V GUNDAM.**  
RX-93

