

**1:100 SCALE MODEL**



# **MS-06V ZAKU TANK**

**PRINCIPALITY OF ZEON  
MASS PRODUCTIVE MOBILE SUIT**

MODEL NUMBER: MS-06V

HEIGHT: 14.7m

WEIGHT: 53.6t

MATERIAL: TITANIUM-ALLOY &  
CERAMICS HYBRID ARMOR

GENERATOR OUTPUT: 43,000kg

ARMAMENTS: ZAKU MACHINEGUN × 3

MANIPULATOR ARM × 2





# 零件目录 PARTS LIST

# ZAKU TANK

## 【组装时注意】

- 组装前请仔细阅读说明书。
- 请将零件按编号整齐组装，组装后把边角料丢弃。
- 零配件当中有带尖锐或刺手的，在组装时请小心。
- 建议在涂装粘贴时使用安全的“水性涂料”。

## 【NOTICE WHILEASSEMBLING】

- Please read the instruction carefully before assembly.
- Please assemble the parts as per serial numbers and discard the leftover material after assembly.
- While assembling, please pay attention that some of the parts may be sharp-pointed or aciculate.
- Please use the safe “aqueous coating” while painting

## PLATE A

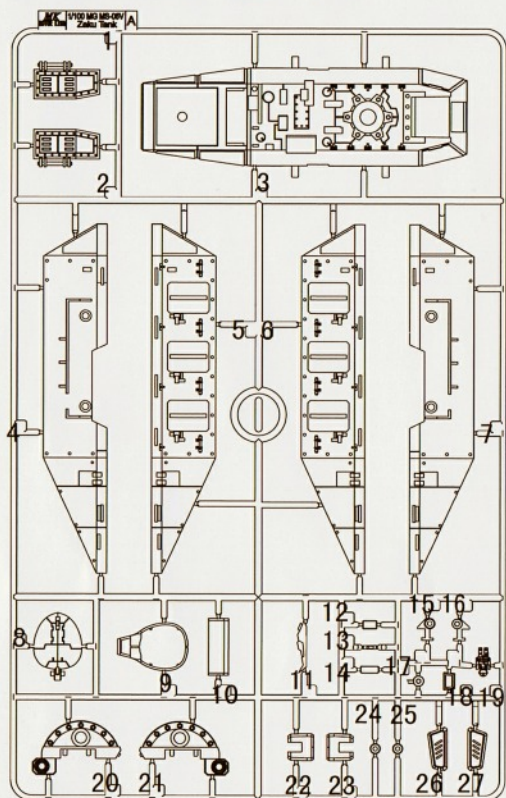

## PLATE C × 2

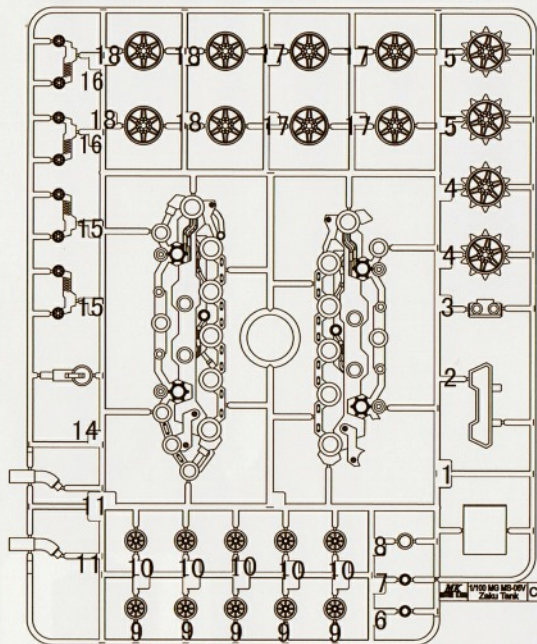

## PLATE B × 2

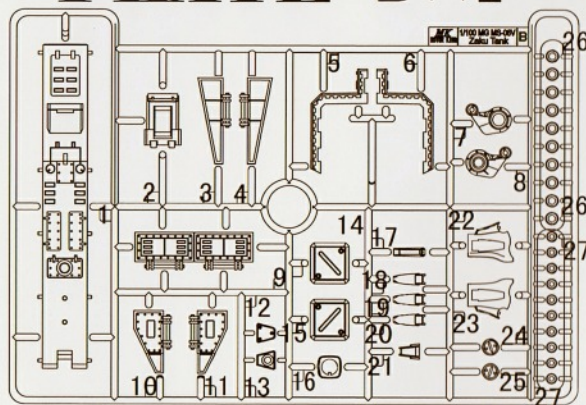

## PLATE D

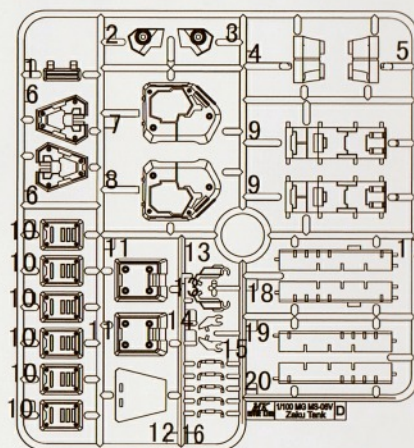

## PLATE E

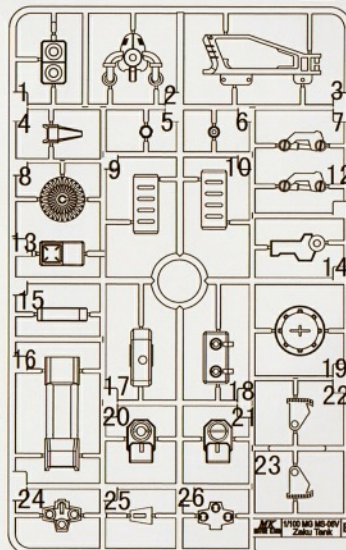



## PLATE F × 2

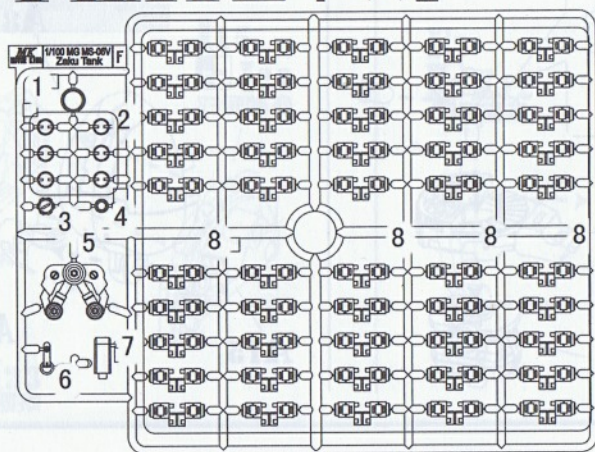

## PLATE G

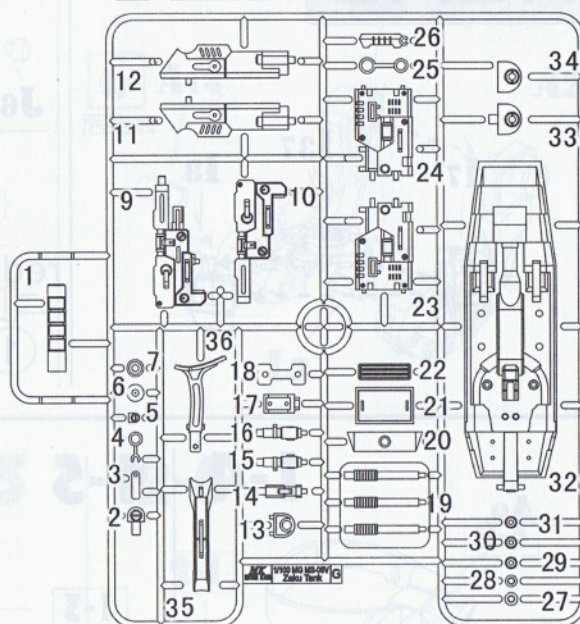

## PLATE H × 2

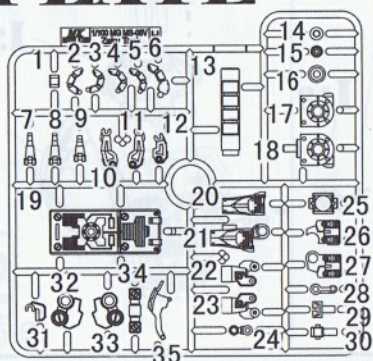

## PLATE I

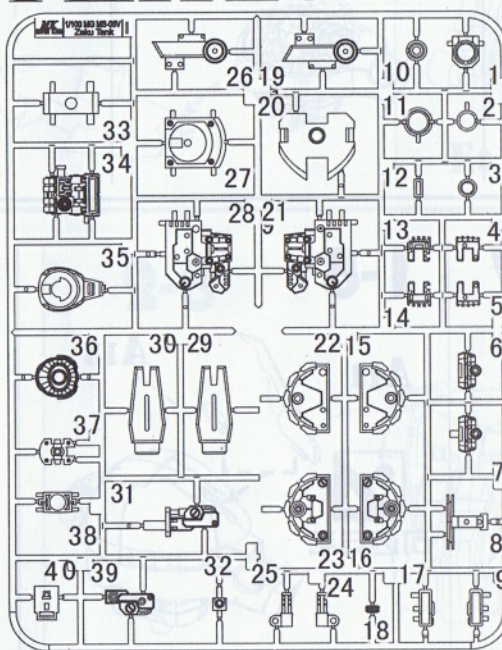

## PLATE J

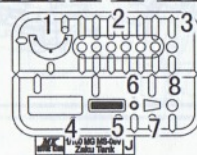

## PLATE L

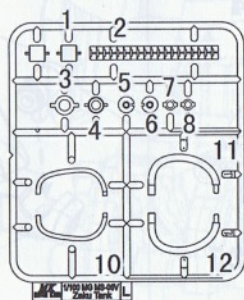

## PLATE K

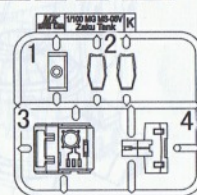

## 安装标识 INSTALLATION IDENTIFIER



制作相同数量  
Making the  
same number



对称安装  
On the side  
of the same



后行安装  
After the  
installation



先行安装  
The first  
installation



可选安装  
Optional  
types



# HEAD

**I-1**

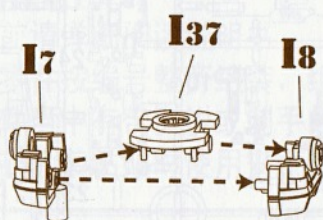

**I-2**

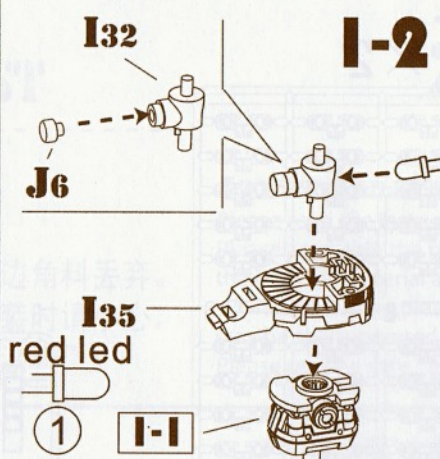

**I-3**

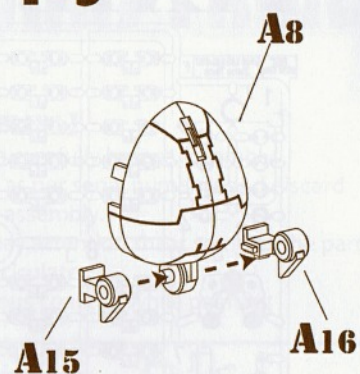

**I-4**

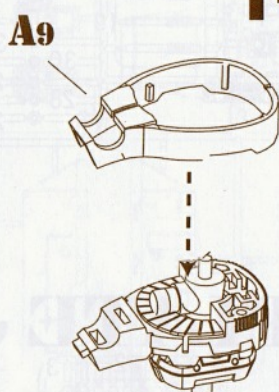

**I-5**

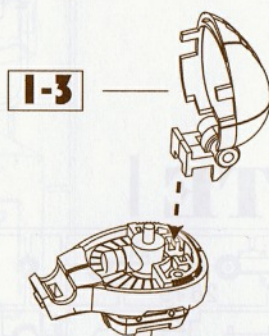

**I-6**

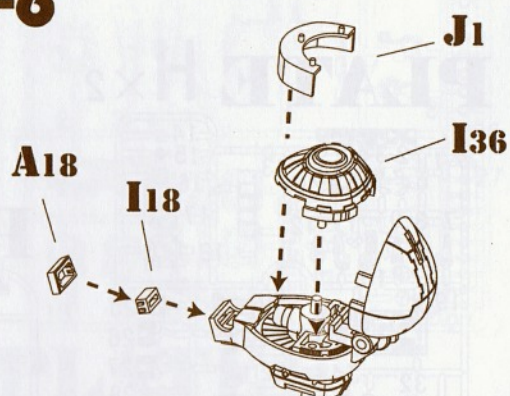

**I-7**

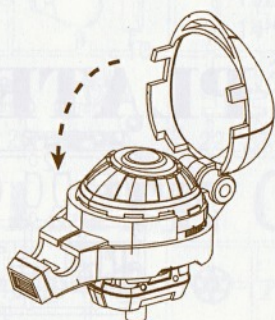

**I-8**

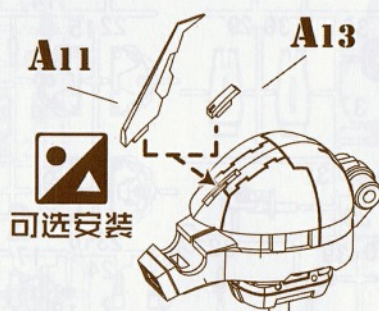

**I-9**

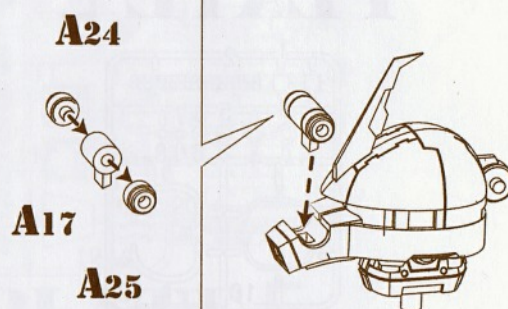

**I-10**

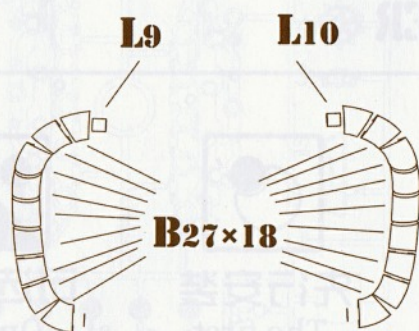

**I-11**

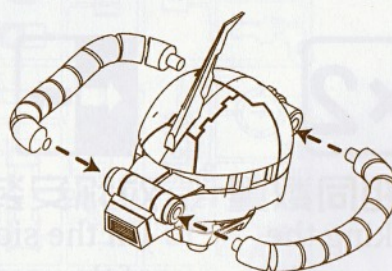



# BODY

## 2-1

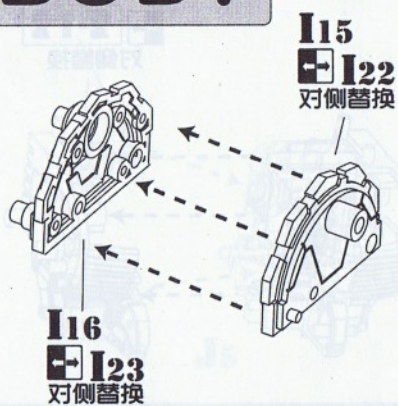

## 2-2

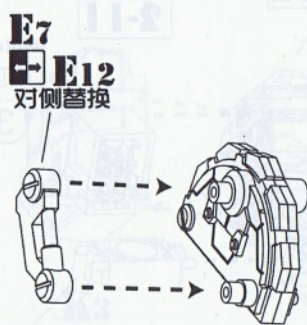

## 2-3

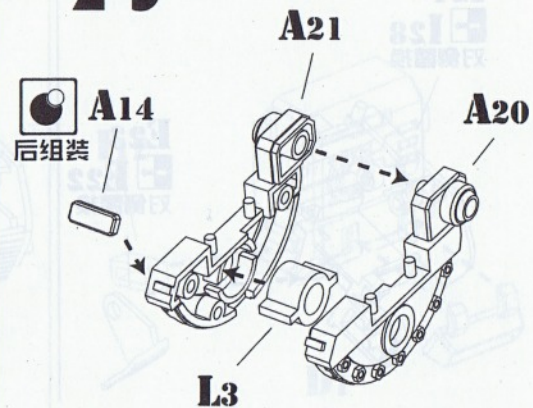

## 2-4

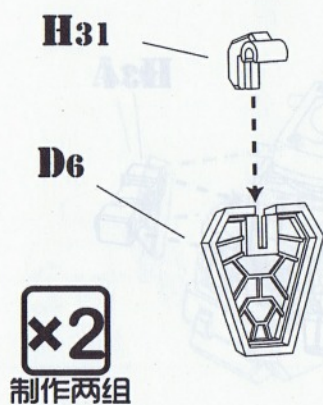

## 2-5

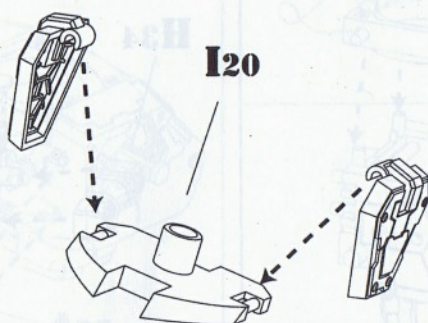

## 2-6

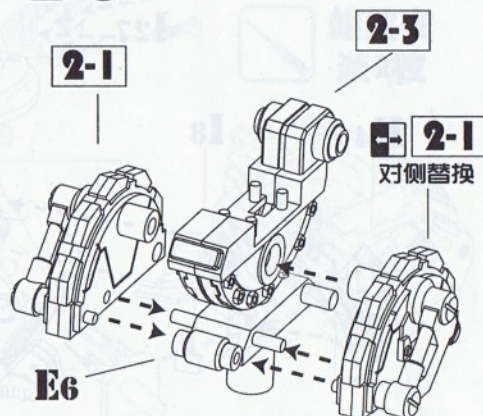

## 2-7

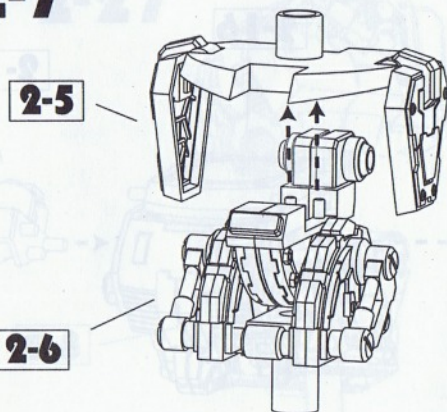

## 2-8

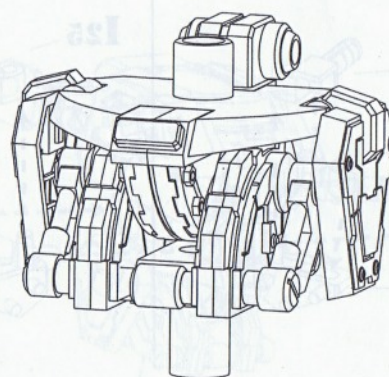

## 2-9

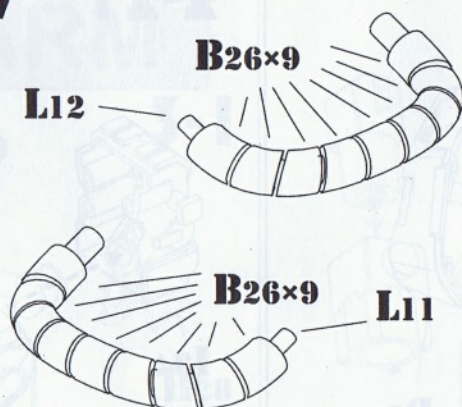

## 2-10

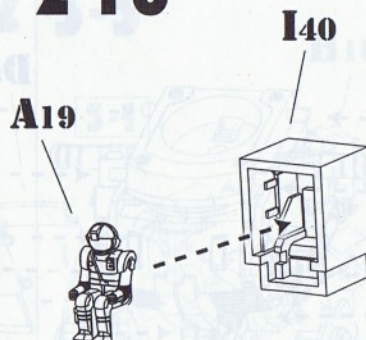

## 2-11

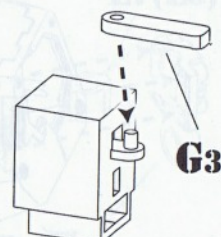



I21  
I28  
对侧替换

2-12

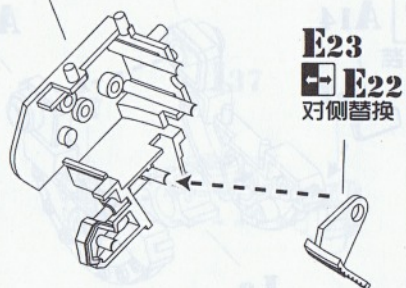

2-12

2-11

white led

3

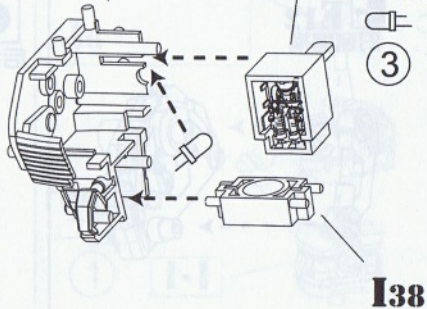

2-14

2-12  
对侧替换

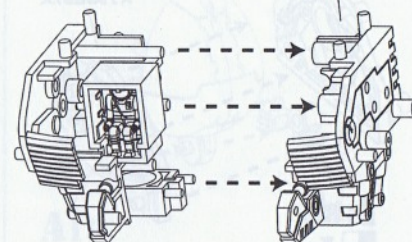

2-15

2-16

I27

K4

I8

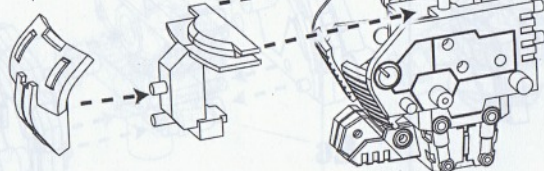

H34

H34

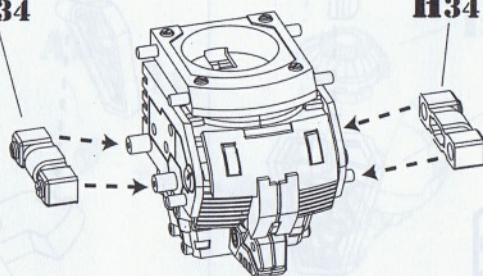

2-17

2-18

2-19

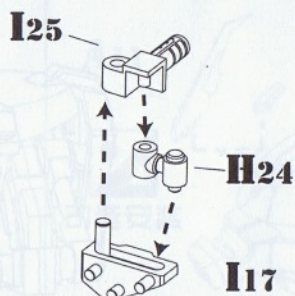
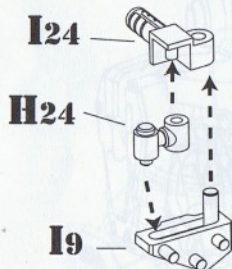

2-18

2-16

2-17

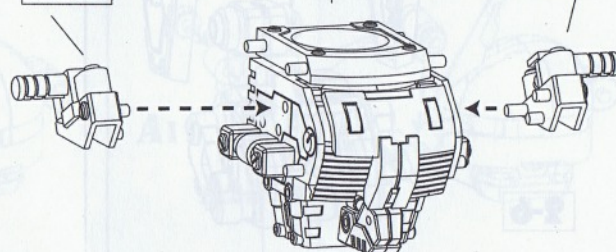

2-20

2-21

D4

D5

D7

D2

D3

D8

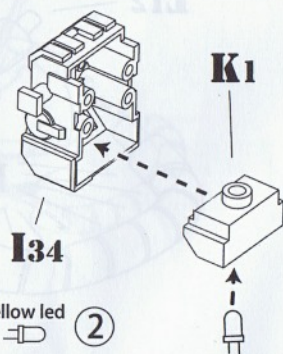
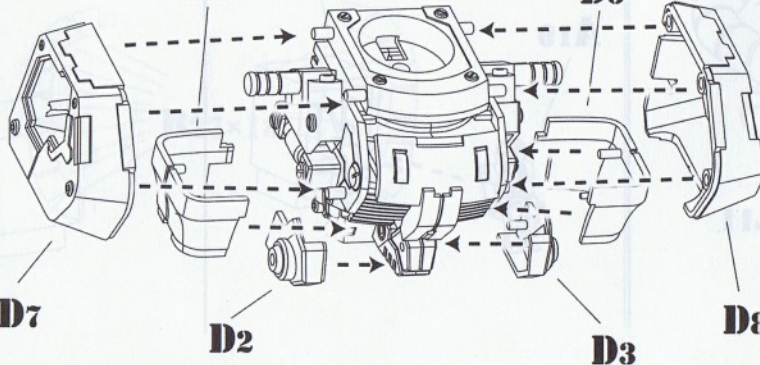

yellow led  
2



# 2-22

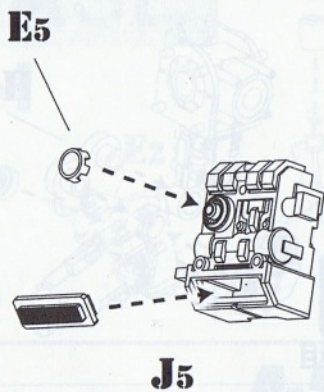

# 2-23

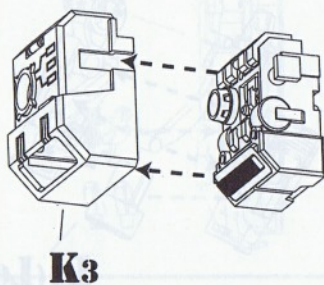

# 2-24

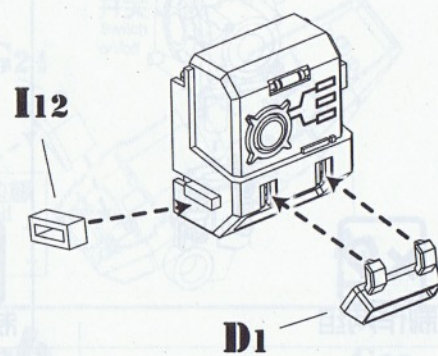

# 2-25

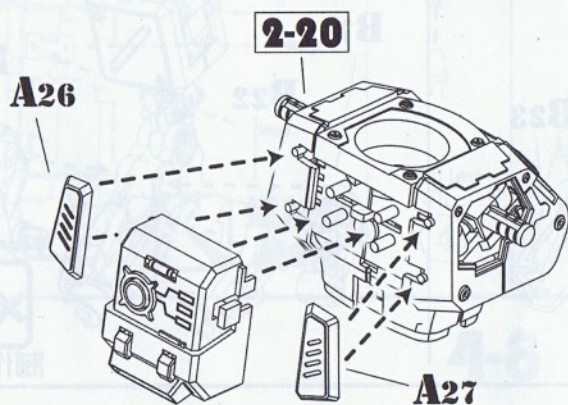

# A31

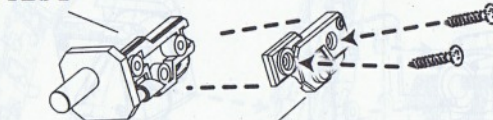

# 2-26



螺丝安装2枚

# A39

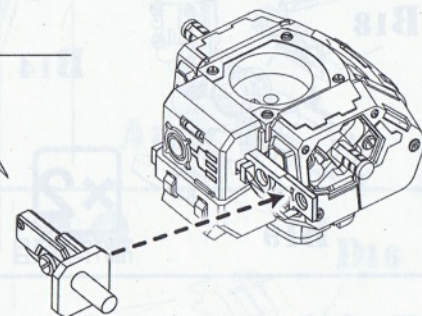

# 2-27

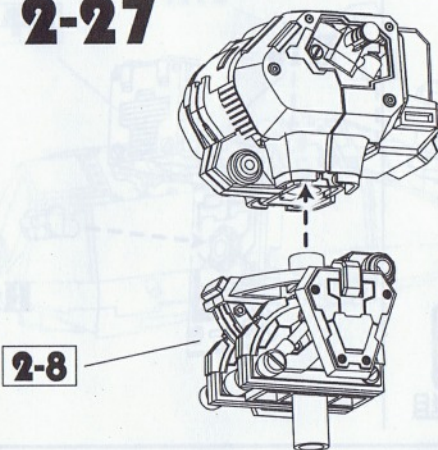

# 2-28

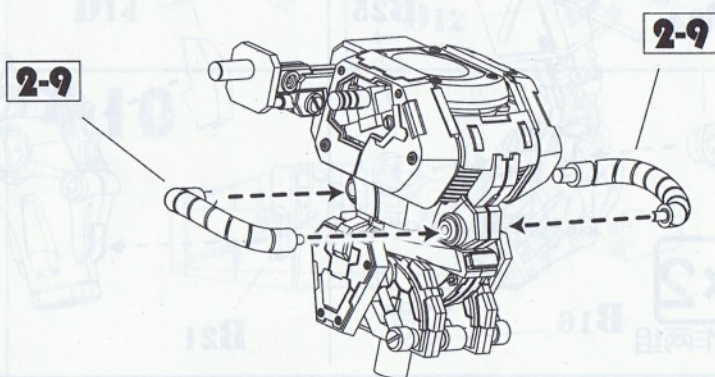

# ARM

# 3-1

# H29



# H28

×2

制作两组

# 3-2

# L1



# H28

×2

制作两组

# 3-3

# 3-1

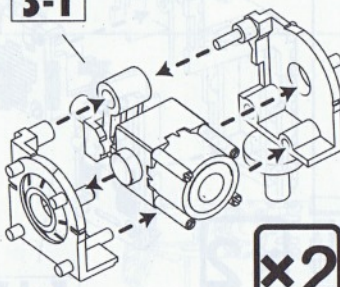

# H18

# H17

×2

制作两组

# 3-4

# H26



# L7(L8)



# H27

×2

制作两组



### 3-5

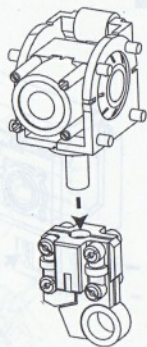

**×2**

制作两组

### 3-6

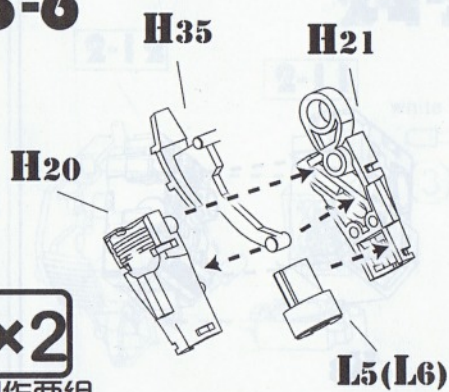

**×2**

制作两组

### 3-7

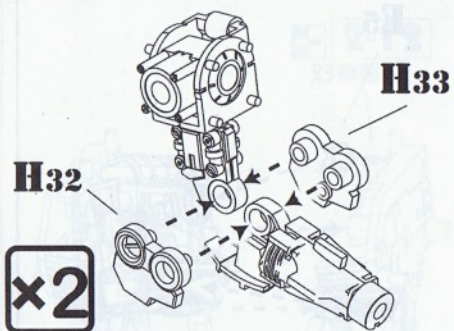

**×2**

制作两组

### 3-8

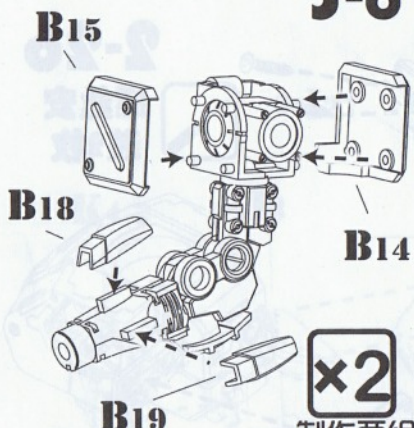

**×2**

制作两组

### 3-9

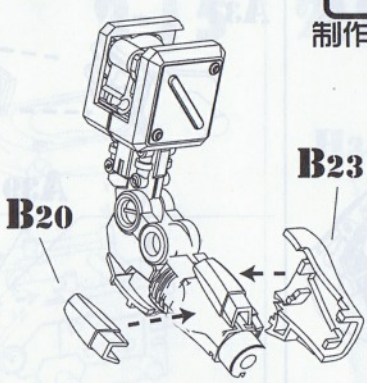

**×2**

制作两组

### 3-10

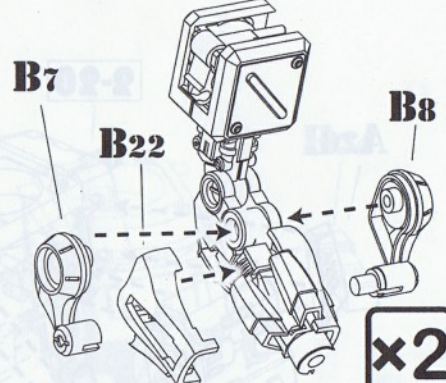

**×2**

制作两组

Scanned by www.plasticandplasters.com

### 3-11

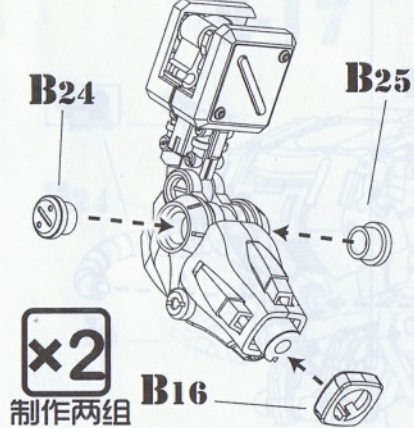

**×2**

制作两组

### 3-12

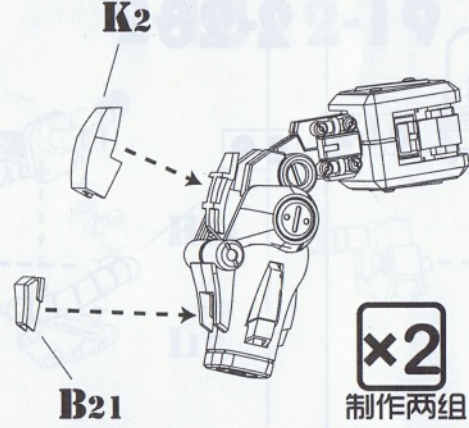

**×2**

制作两组

### 3-13

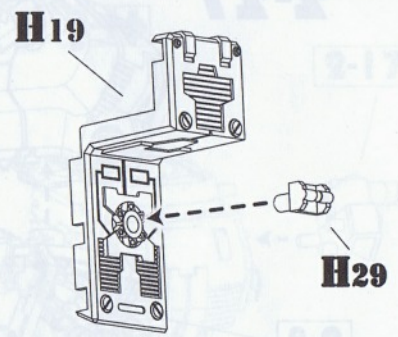

### 3-14

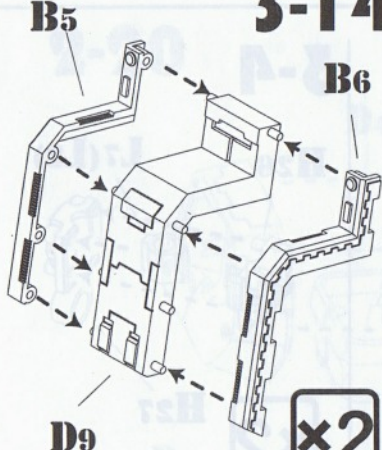

**×2**

制作两组

### 3-15

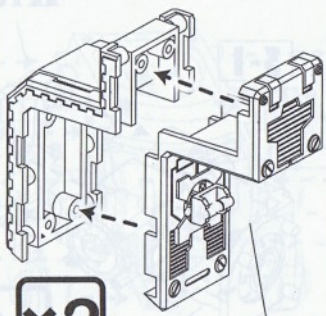

**×2**

制作两组

### 3-16

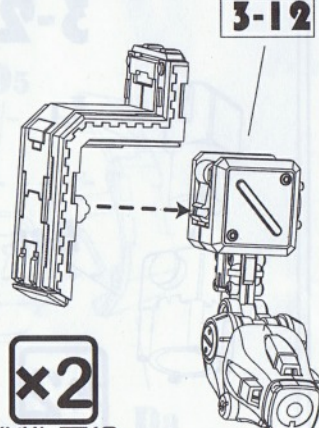

**×2**

制作两组

### 3-17

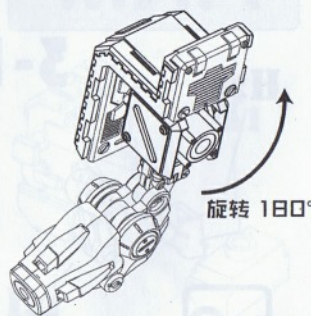

旋转 180°



# BASE

## 4-1



## 4-2

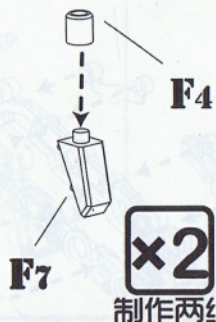

## 4-3

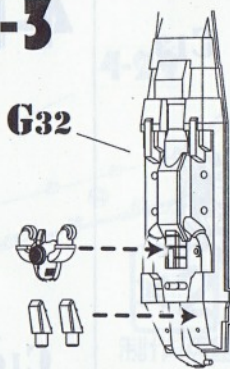

## 4-4

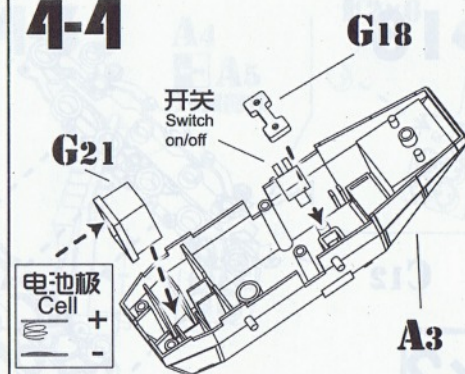

## 4-5

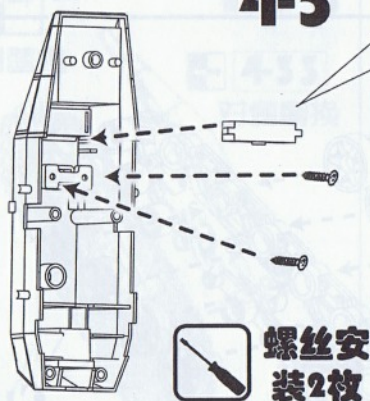

## G20



red led

4

## 4-6

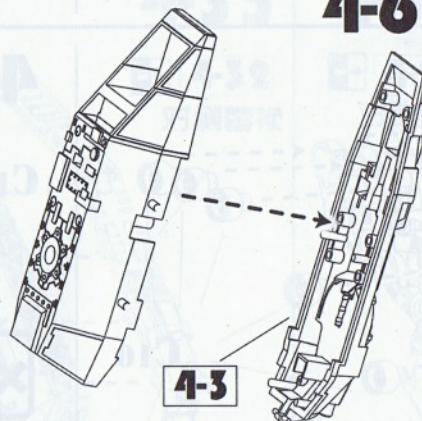

## J4

## G22

## 4-7



## 4-8

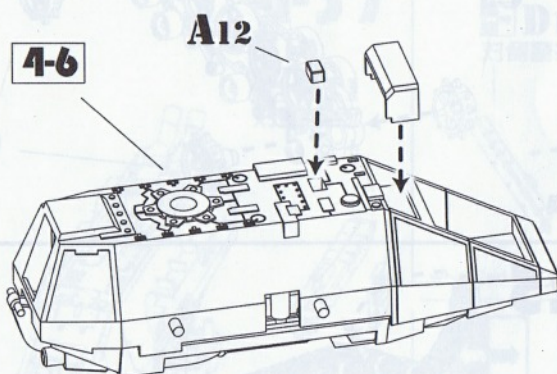

## 4-9

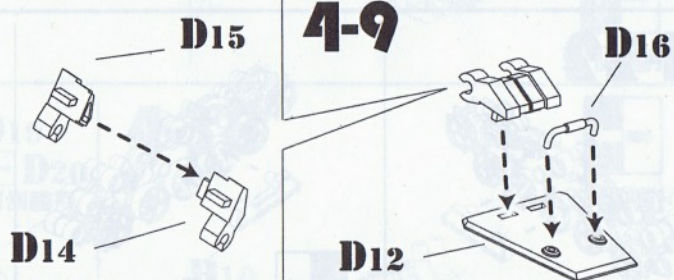

## 4-10

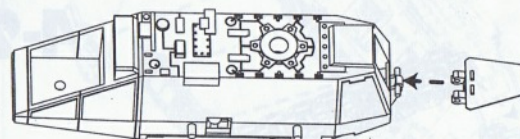

## 4-11

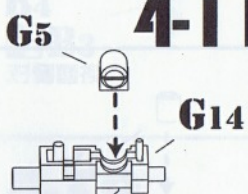

## 4-12

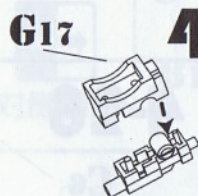

## 4-15



## 4-16

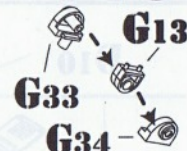

## 4-13



## 4-14



## 4-17

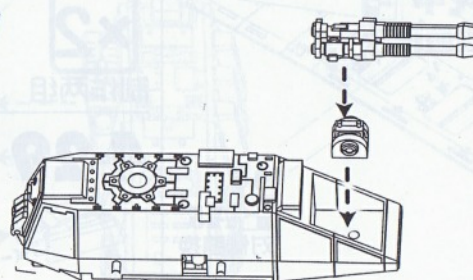



# 4-18

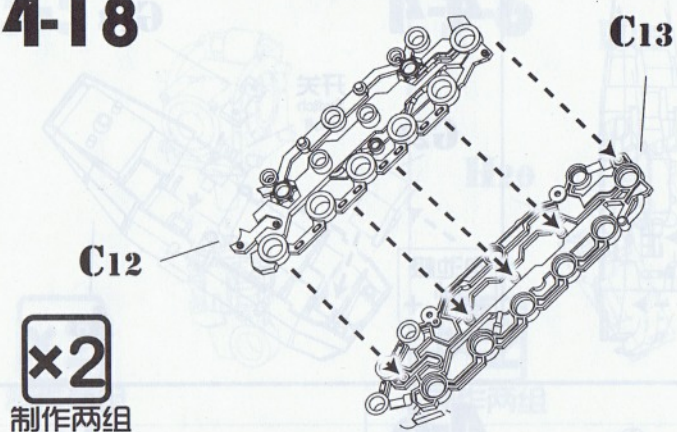

# 4-19

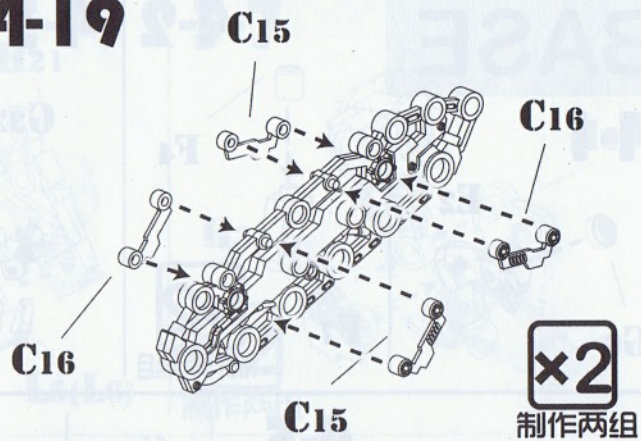

# 4-20

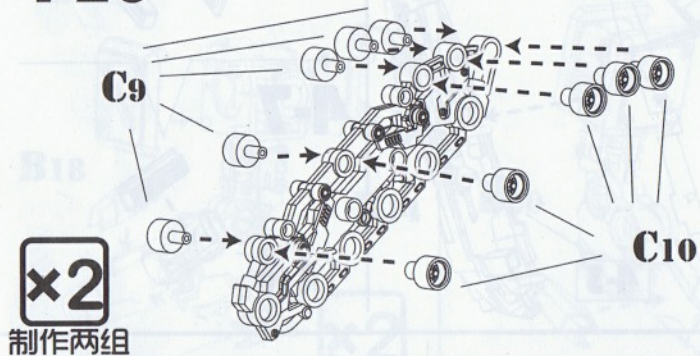

# 4-21

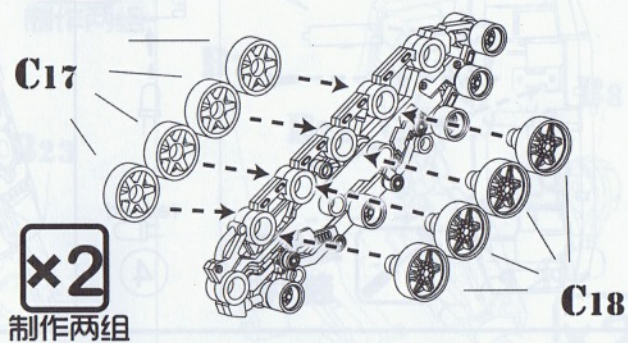

# 4-22

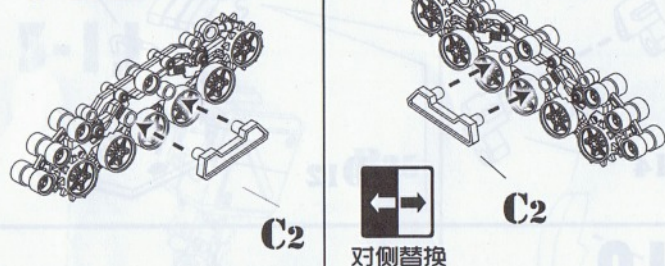

# 4-23

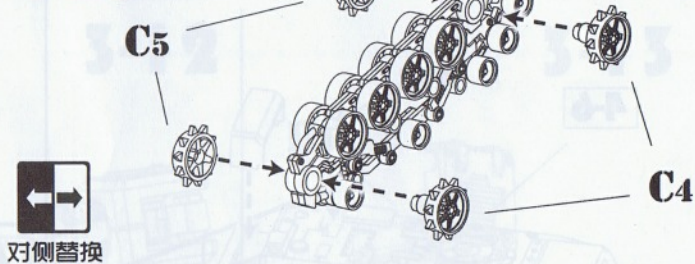

# 4-24

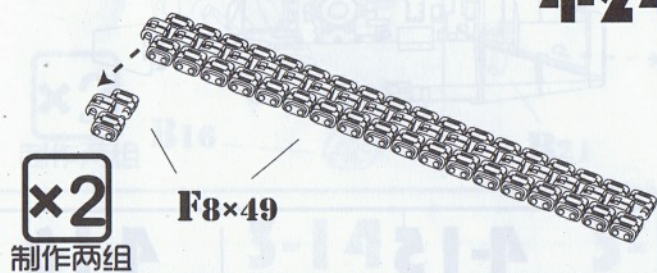

# 4-25



# 4-26

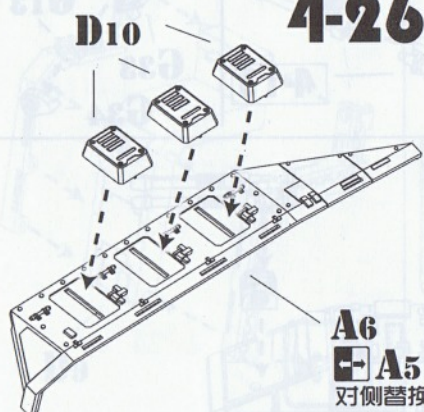

# 4-27



# 4-28

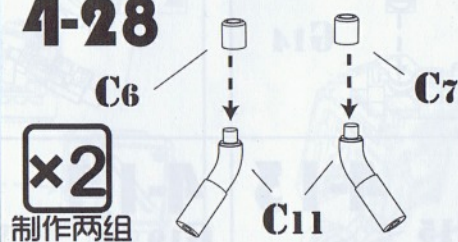

# 4-29

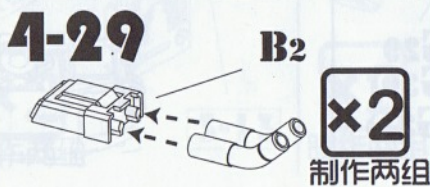

# 4-30

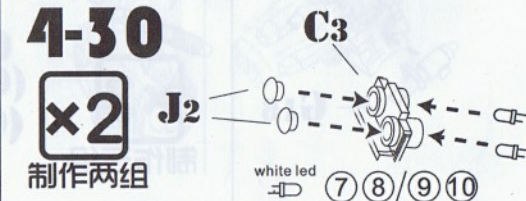



# 4-31

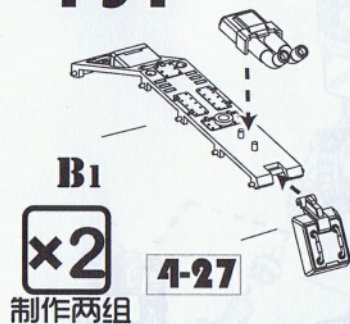

# 4-32

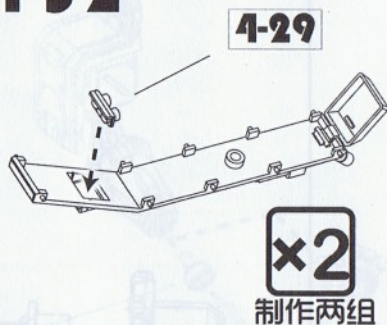

# 4-33

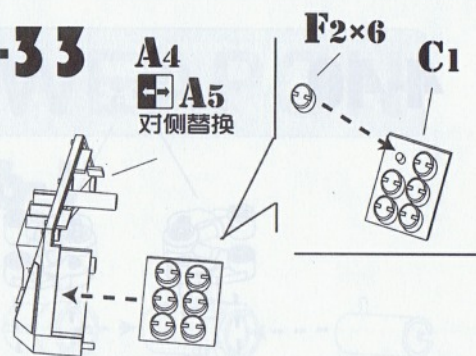

# 4-34

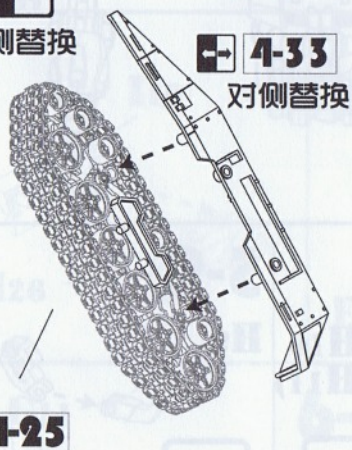

# 4-35

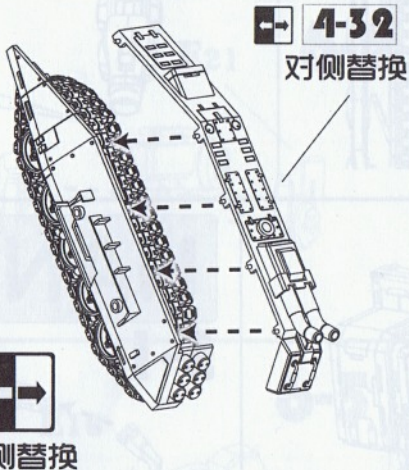

# 4-36

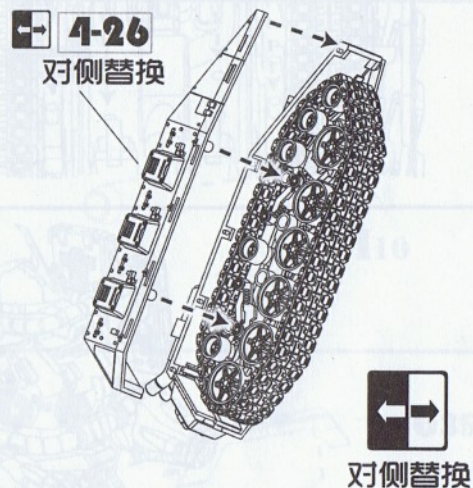

# 4-37

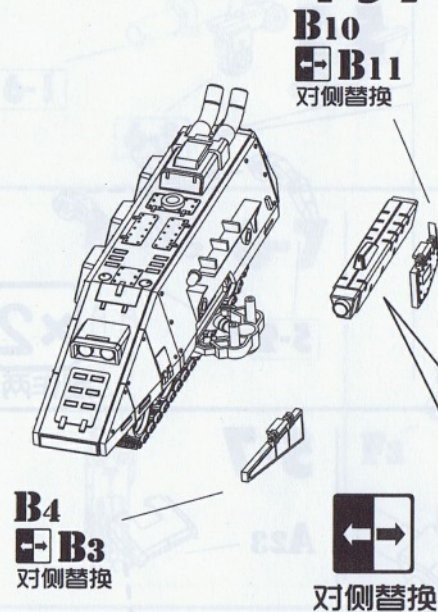

**D17**  
**D18**  
对侧替换

**D19**  
**D20**  
对侧替换

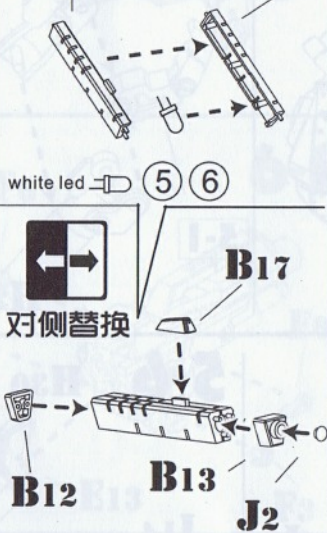

# 4-38

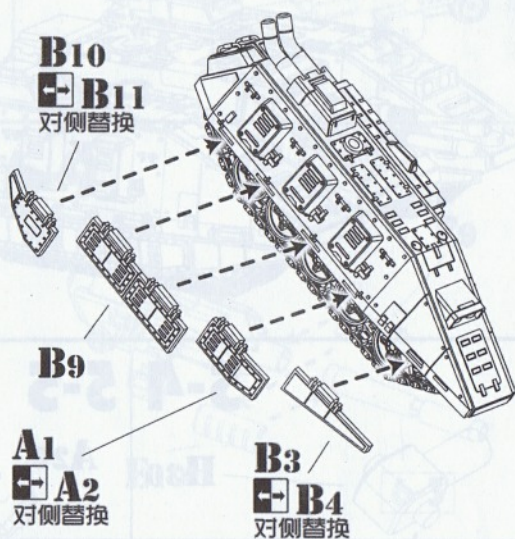

# 4-39

4-32

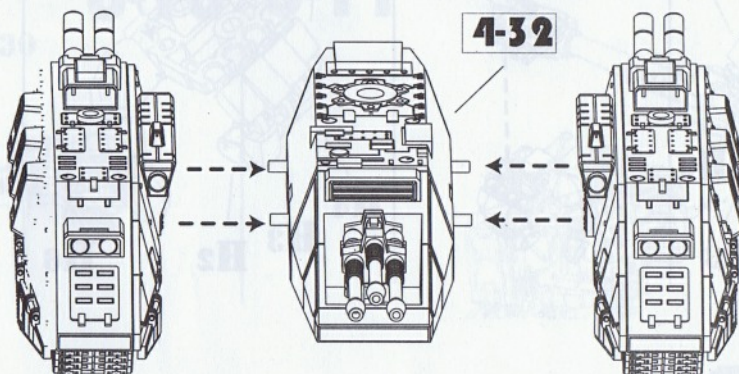

4-32  
对侧替换



# 4-40

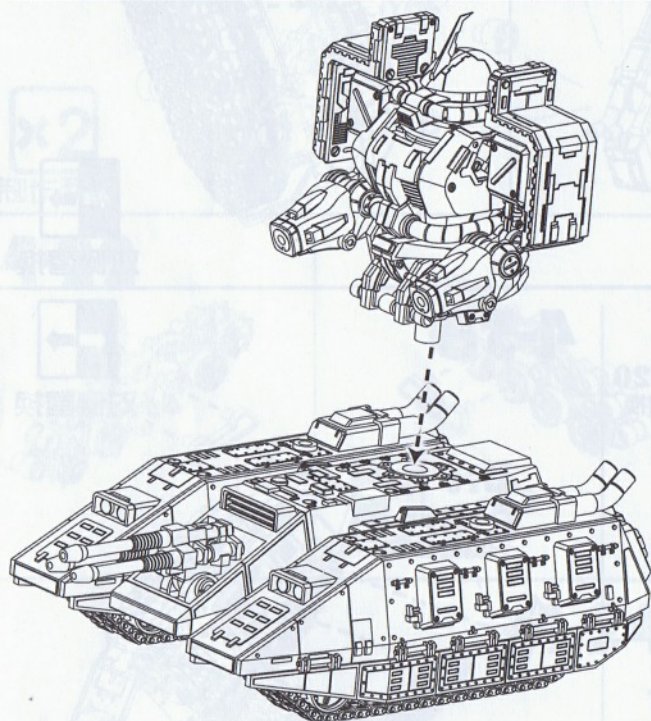
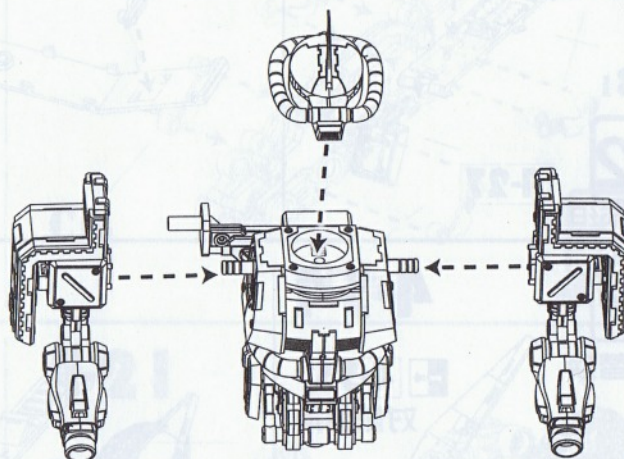
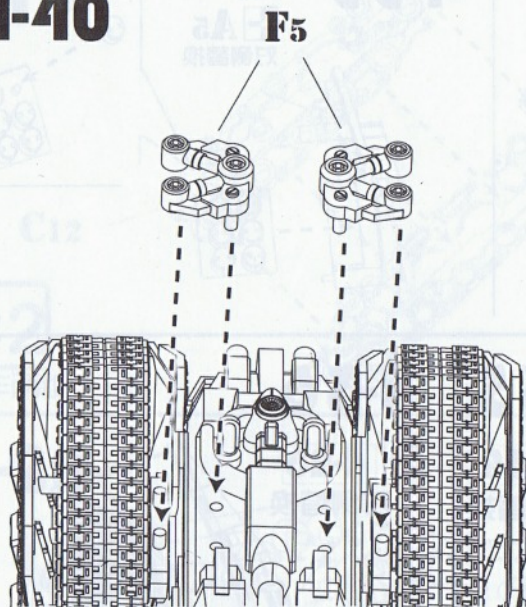

## HAND

### 5-1



**×4**  
制作四组

### 5-2



**×2**  
制作两组

### 5-1

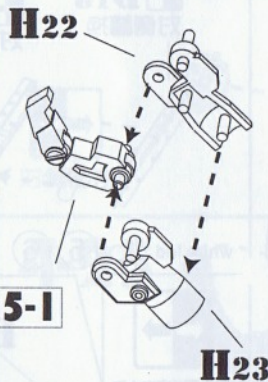

### 5-3

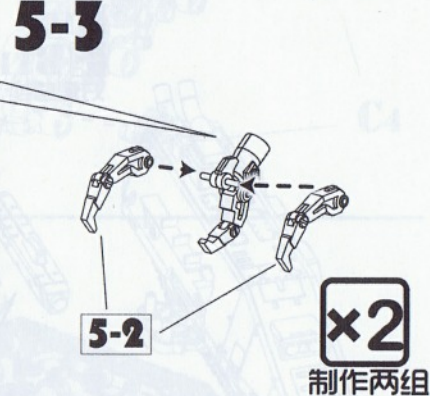

**×2**  
制作两组

### 5-4

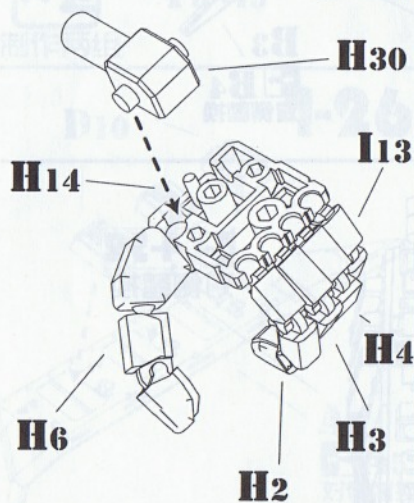

### 5-5

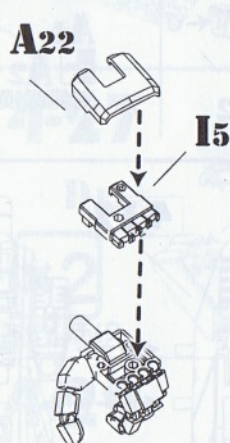

### 5-6

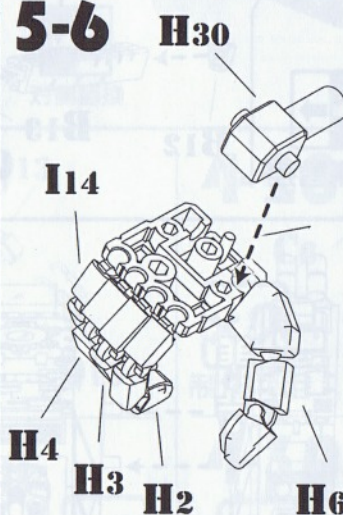

### 5-7

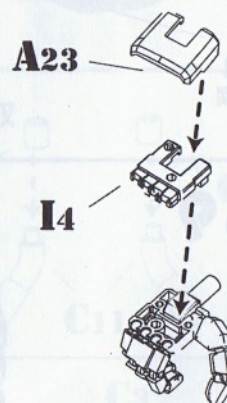



# WEAPON

**6-1**

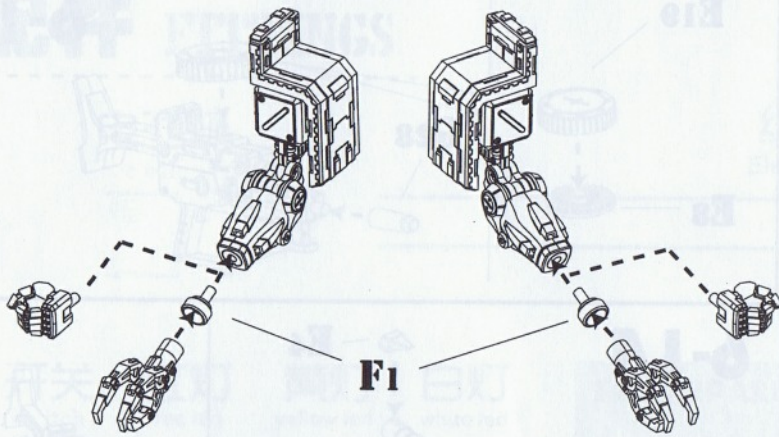
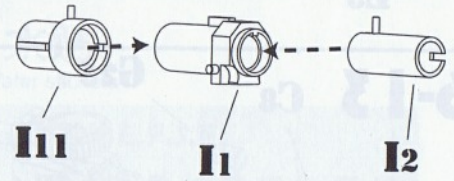

**6-2**

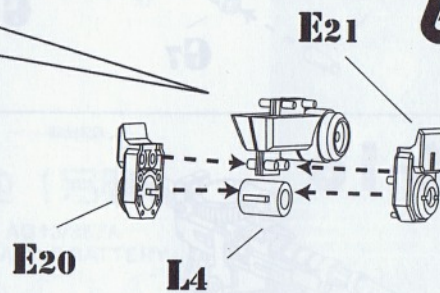
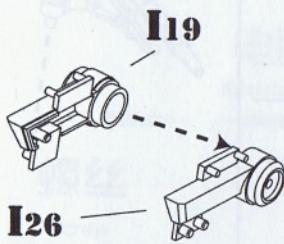

**6-3**

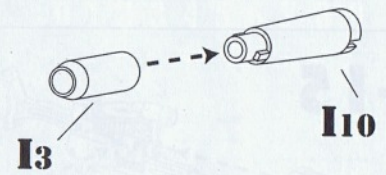

**6-4**

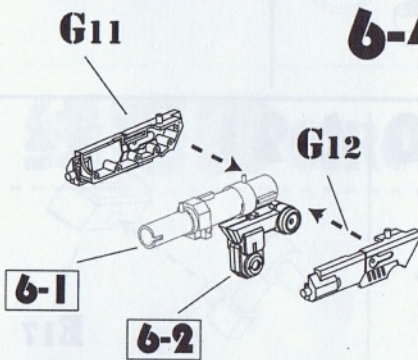

**6-5**

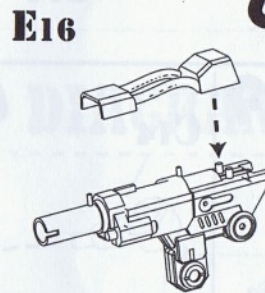

**6-6**

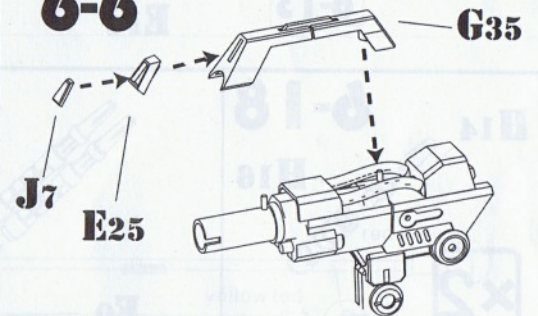

**6-7**



**6-8**

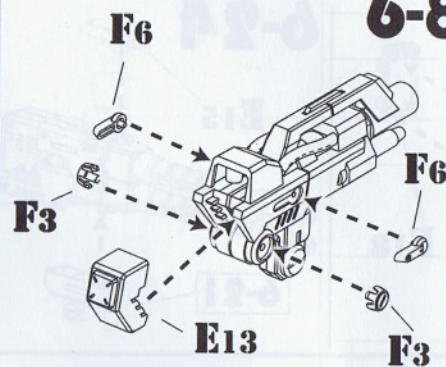

**6-9**



**6-10 6-11**

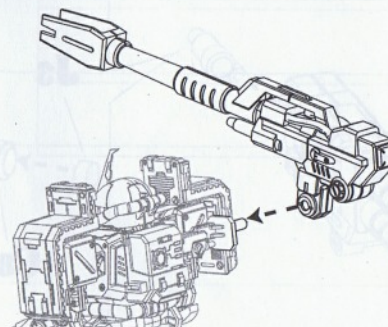
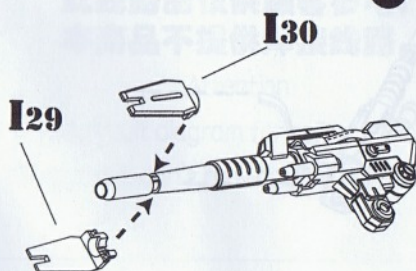

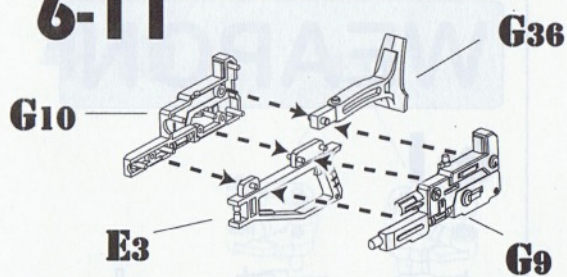
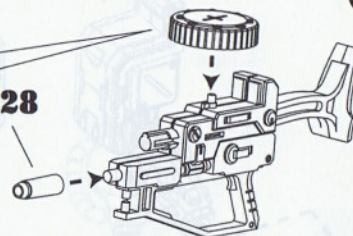
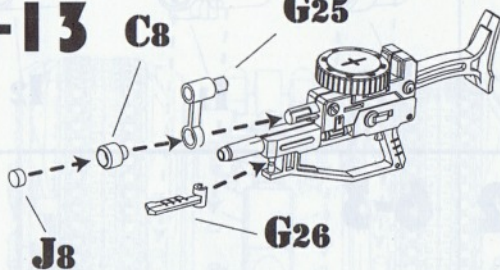
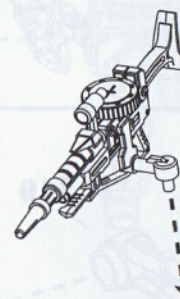
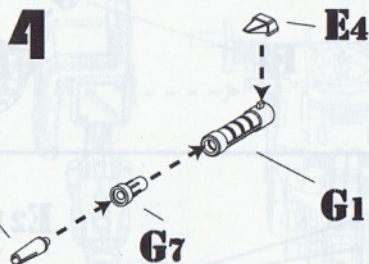
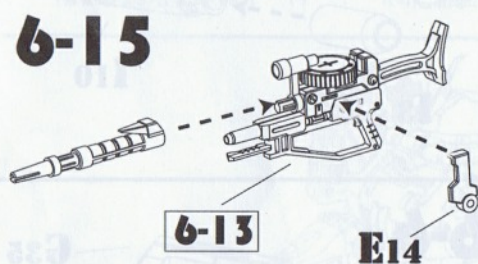
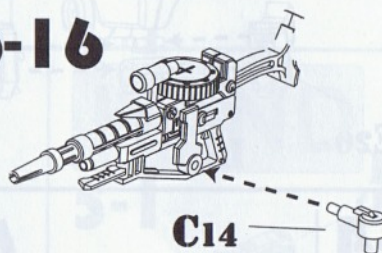

**6-11****E19****E8****6-12****G28****6-13****C8****G25****6-14****E4****G27****G7****G1****6-15****6-13****E14****6-16****C14****H14****6-18****H16****H13****×2**

制作两组

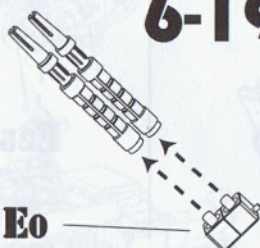
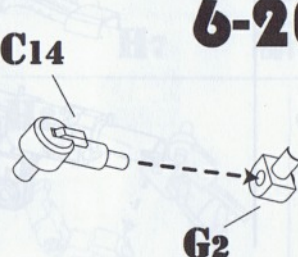
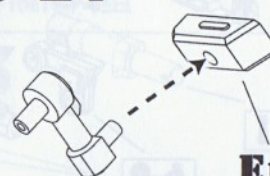
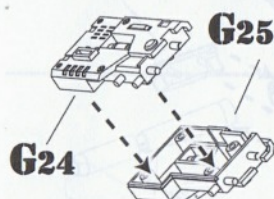
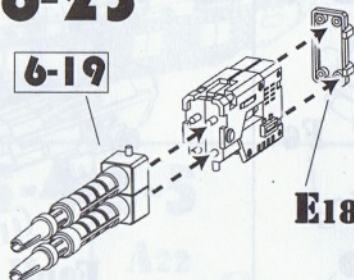
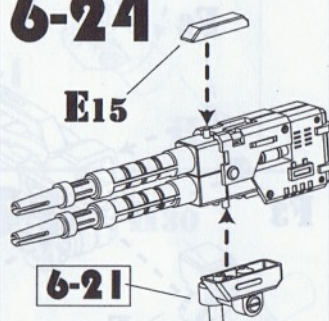
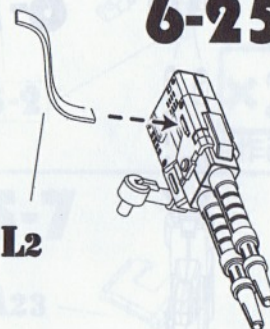
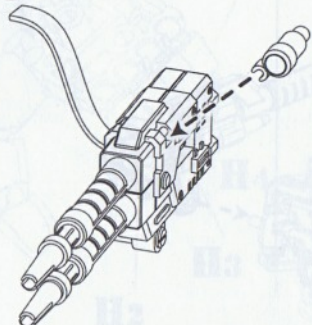
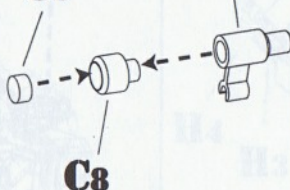
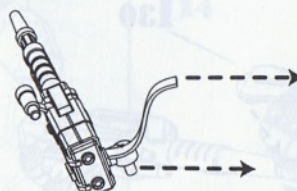
**6-19****E0****C14****6-20****G2****6-21****E17****6-22****G25****G24****6-23****6-19****E18****6-24****E15****6-21****6-25****L2****6-26****J3****G4****C8****6-27**



# 配件 FITTINGS

## 电池极

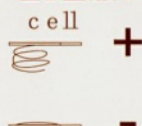

## 线路

Electric wire

## 水贴

Water stickers

## 开关

sw itch  
on/off



## 红灯

red led



## 黄灯

yellow led



## 白灯

white led



## 电阻

Resistance



## 螺丝

Screw



## 电池 (另购)

AG13/357A  
ALKALINE BATTERY



## PRINCIPALITY OF ZEON/ E.F.S.F

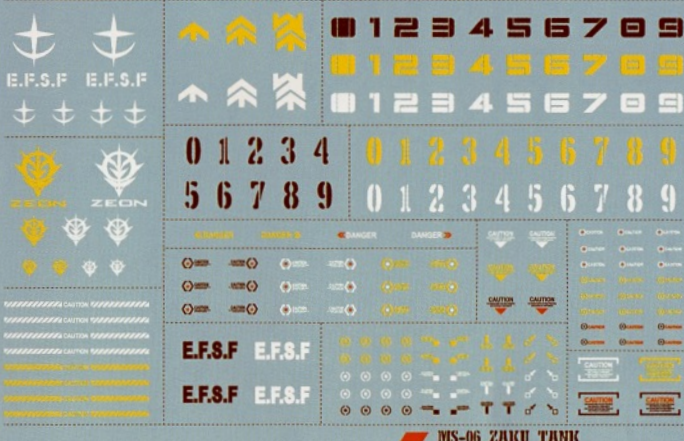

# 线路图 CIRCUIT DIAGRAM

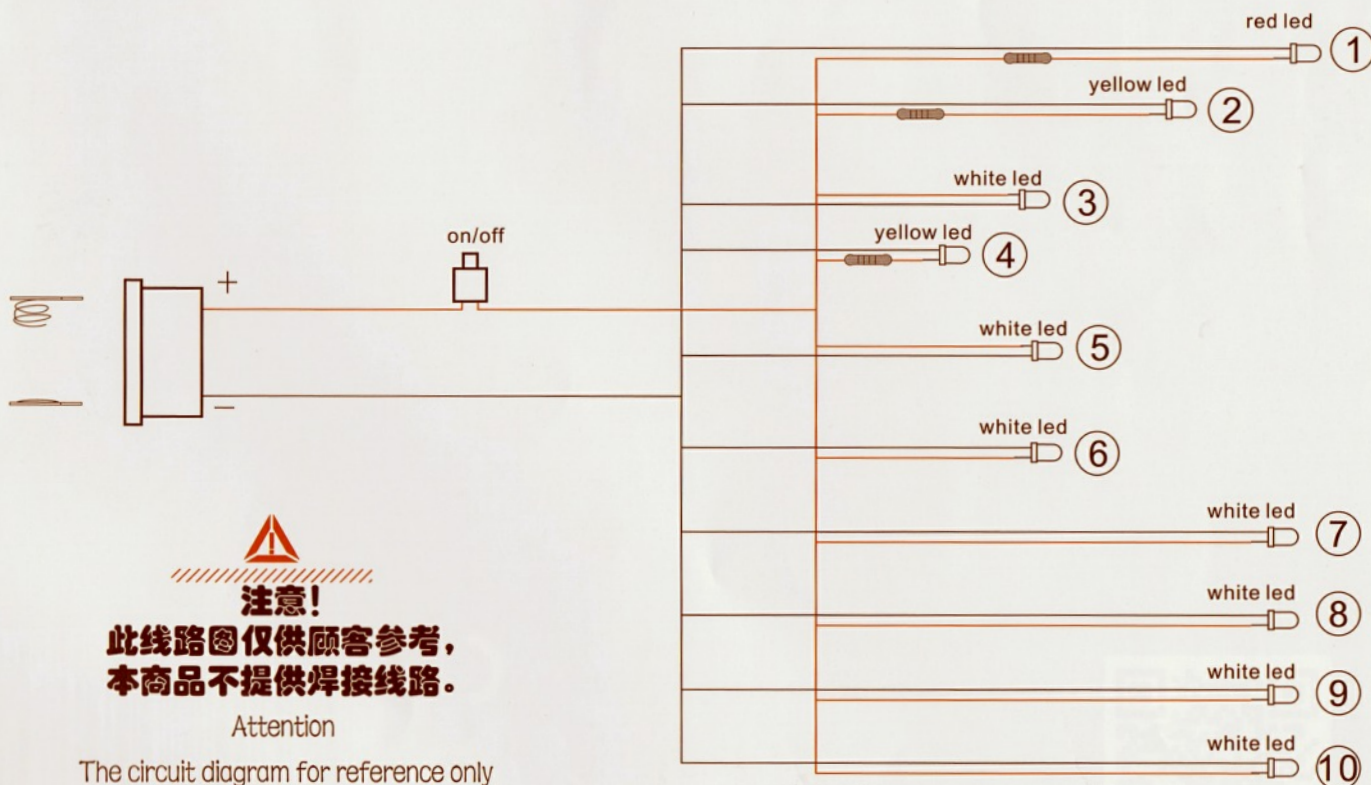

**注意!**

此线路图仅供顾客参考，  
本商品不提供焊接线路。

Attention

The circuit diagram for reference only  
This goods don't provide welding services