

The Mitchell-Hyundyne SA-23 Starfury is a proven space combat veteran. These one-man fighters, specially designed for space combat, provide the primary defense for Earth Alliance after BABYLON 5 seceded from Earth, the Starfuries remained on the station to provide for the common defense. Each Starfury division carries specific markings on top of the upper wing body that identify the particular division. Keeping with military fighter-craft tradition, some pilots add their own personal flair to the "nose-art" on their ships. Former Babylon 5 commander Jeffery Sinclair displays a Red Chevron on his Starfury during his command of Babylon 5, and the black and yellow stripes of his squadron during the "Battle of the Line". Captain John Sheridan, the current commander of Babylon 5, displays his "Flying Tiger" design on his wing. Former security chief Michael Garibaldi's Starfury is decorated with orange, tan and brown "Lizard" stripes. "Battle of the Line" pilot Mitchell sported black and white "Zebra" stripes before its destruction, and Garibaldi's wingman, "Delta 7" has green "Lizard" markings. Your Starfury can be built with any one of these designs, and you can custom number your ship with the all-new expanded decal sheet included in this kit.

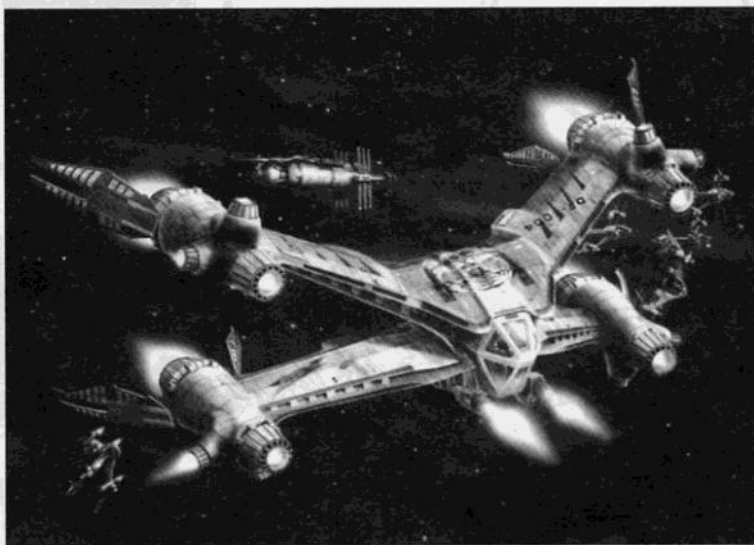

MODELING TIPS



PAINTING TIPS



DECAL



OPTIONAL PARTS

READ THIS BEFORE YOU BEGIN

- * Study the assembly drawings.
- * Each plastic part is identified by a number.
- * In the assembly drawings, some parts will be marked by a star (★) to indicate chrome plated plastic.
- * For better paint and decal adhesion, wash the plastic parts in a mild detergent solution. Rinse and let air dry.
- * Check the fit of each piece before cementing in place.
- * Use only cement for polystyrene plastic.
- * Scrape plating and paint from areas to be cemented.
- * Allow paint to dry thoroughly before handling parts.
- * Any unused parts may be discarded.

DECAL APPLICATION INSTRUCTIONS
(If Applicable)

1. Cut desired decal from sheet.
2. Dip decal in water for a few seconds.
3. Place wet decal on paper towel.
4. Wait until decal is movable on paper backing.
5. Place decal in position on model, face up and slide backing away.
6. Press out air bubbles with a soft damp cloth.
7. Milkiness that may appear is for better decal adhesion and will dry clear. Wipe away any excess adhesive.
8. Do not touch decal until fully dry.
9. Allow the decals 48 hours to dry before applying clear coat.

NOTE: Decals are not compatible with setting solutions or solvents.

This paint guide is provided to complete this kit as shown on the box

Dark Gray

Neutral Gray

Field Green

Silver

Flat Black

Yellow

Gloss Orange

Flat White

Gray Green

Jet Exhaust

Light Gray

Medium Gray

If you have any questions or comments, call our hotline at: (800) 833-3570

or, please write to:

Revell-Monogram Consumer Service Department, 8601 Waukegan Road, Morton Grove, Illinois 60053

Be sure to include the plan number (85363200200), part number, description, your return address and phone number.

Visit our website: www.revell-monogram.com

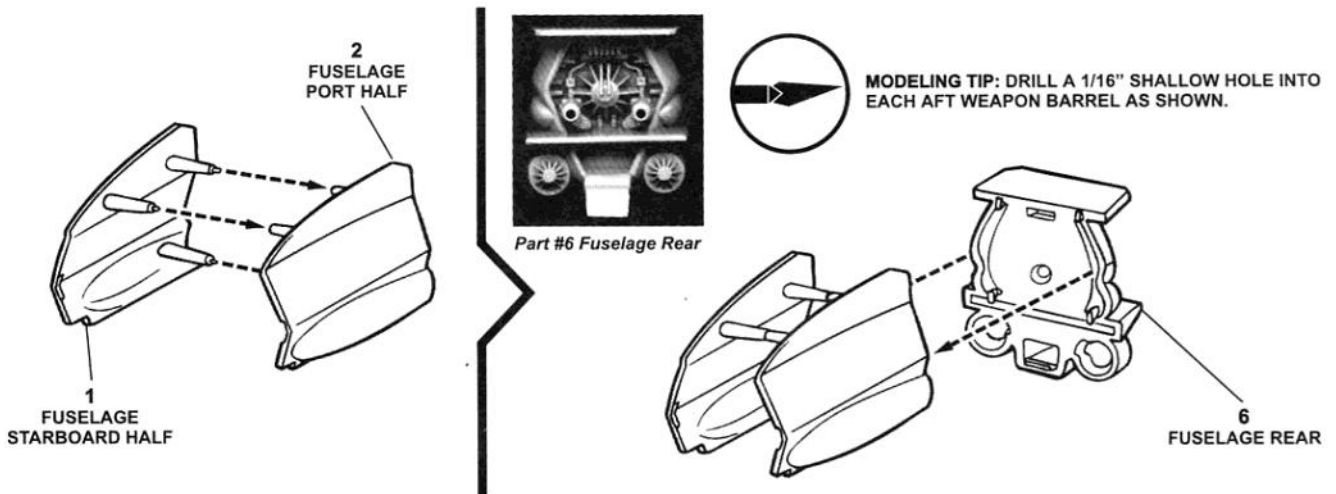
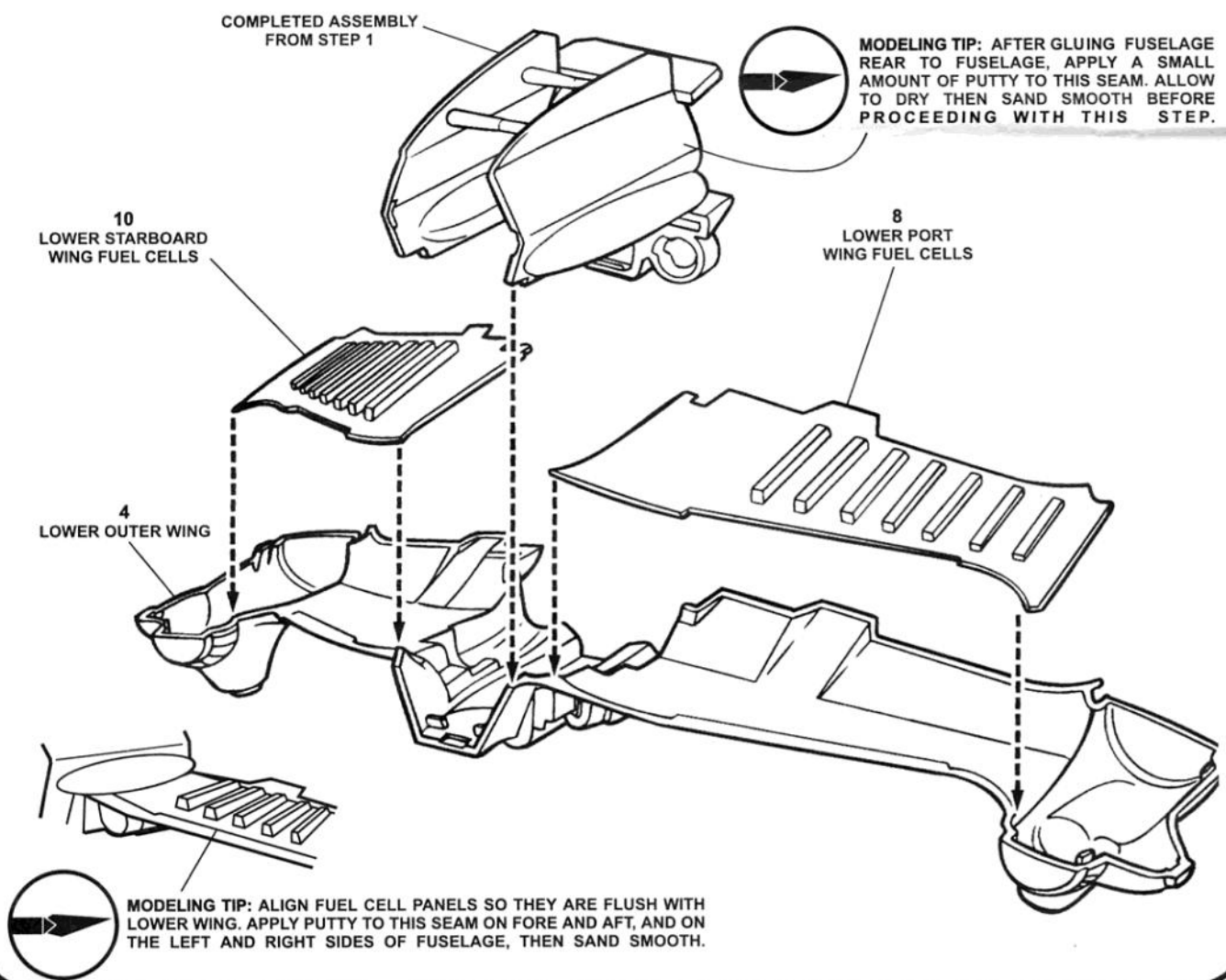
1**FUSELAGE ASSEMBLY****2****LOWER WING ASSEMBLY**

3 LOWER WING ASSEMBLY CONTINUED

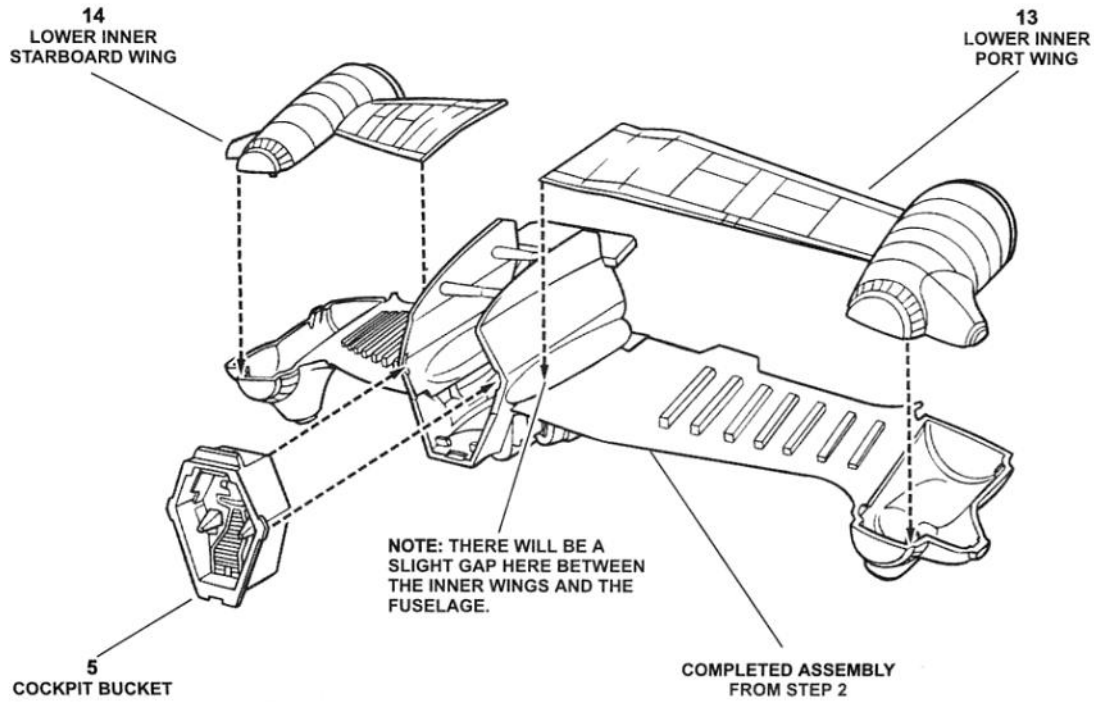

4 UPPER WING ASSEMBLY

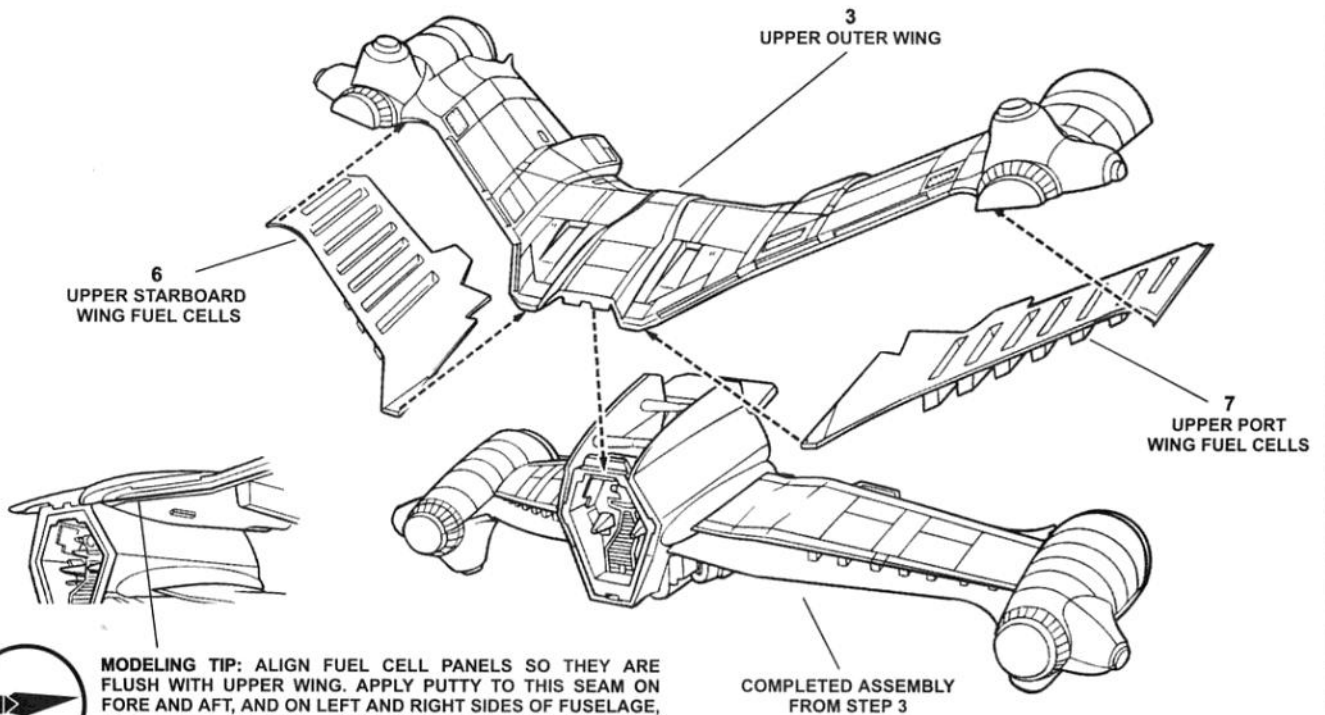

5 UPPER WING ASSEMBLY CONTINUED

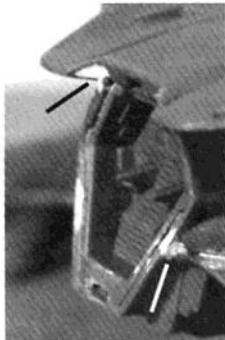

A close up view of the cockpit. Apply putty only to the areas shown. It is not necessary to putty the seam line around the cockpit as this will be covered by the canopy.

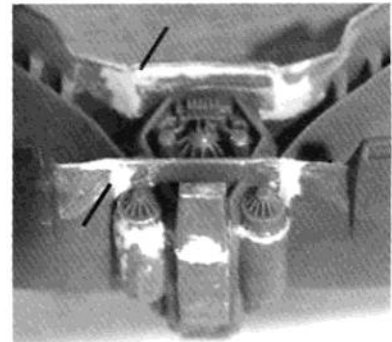
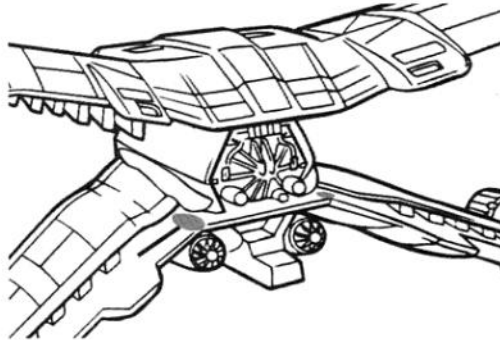

The aft end of the underside. You can apply putty as shown here to fill any unwanted gaps.



MODELING TIP: THIS OPTIONAL STEP CAN ENHANCE THE FINISHED APPEARANCE OF YOUR STARFURY. APPLY MODELING PUTTY TO THE AREAS INDICATED ABOVE. WHEN PUTTY HAS COMPLETELY DRIED, SAND THESE AREAS SMOOTH. YOU MAY ALSO PRIMER THESE AREAS TO CHECK YOUR PUTTY AND SANDING WORK. RETOUCH IF NECESSARY BEFORE PROCEEDING TO NEXT STEP.

6 UPPER WEAPON ASSEMBLY

MAIN WEAPONS PREPARATION:

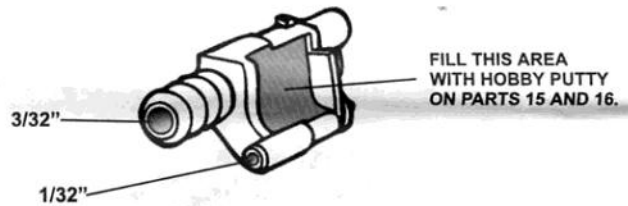
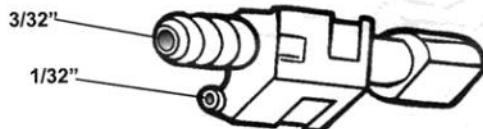

MODELING TIP: THE SMALL MODIFICATIONS HERE CAN GREATLY ENHANCE THE APPEARANCE OF THE MAIN WEAPONS. APPLY FILLER PUTTY TO THE INBOARD SIDES OF PARTS No. 15 AND 16 AS SHOWN. WITH FILES AND SANDPAPER, REMOVE THE SEAM LINES AROUND THE BARREL AND BODY OF ALL FOUR PARTS. DRILL A SMALL SHALLOW HOLE INTO THE BARRELS OF EACH WEAPON WITH THE DRILL BIT SIZE INDICATED ABOVE.

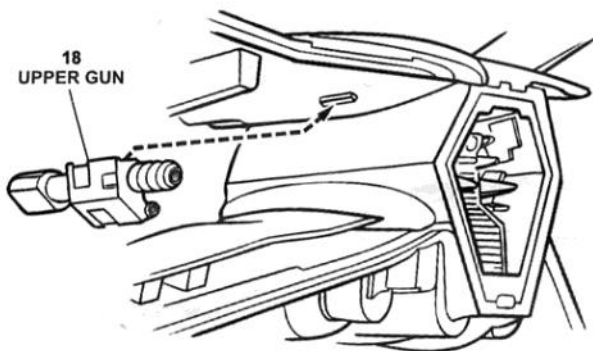

STARBOARD (RIGHT) SIDE

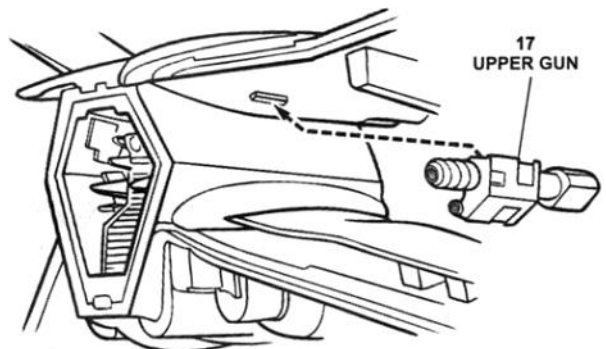

PORT (LEFT) SIDE

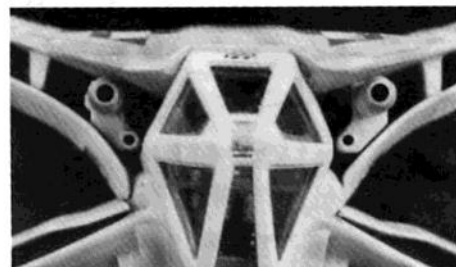

UPPER GUN ALIGNMENT

7 UPPER INNER WING ASSEMBLY

ATTACH INNER WINGS TO THE UNDERSIDE OF THE TOP WING AS SHOWN. ALIGN ENGINE NACELLE BOTTOM HALF ON INNER WING WITH THE ENGINE TOP HALF AND CEMENT IN PLACE. PULL THE LOWER WING CLOSE TO THE FUSELAGE AND CEMENT IT TO THE TANK STRUCTURE ON THE SIDE OF THE FUSELAGE.

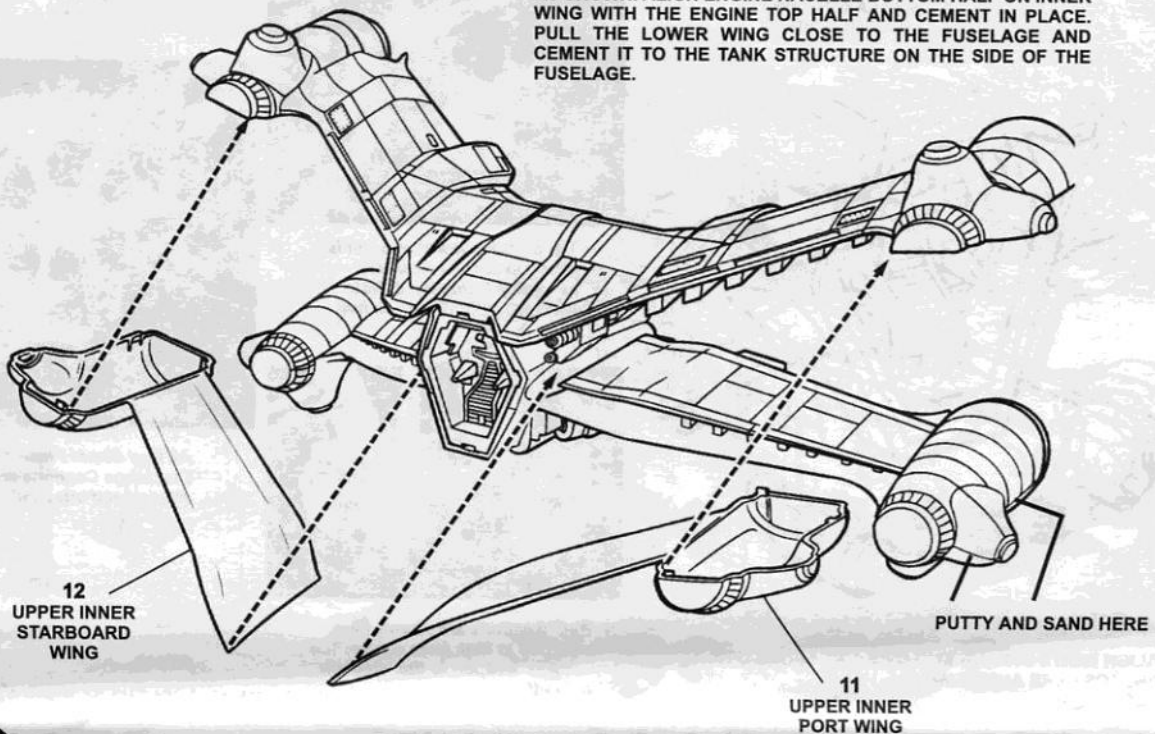

MODELING TIP: AFTER CEMENT HAS COMPLETELY DRIED, SAND THE SEAM RUNNING ALONG THE OUTBOARD SIDE OF ALL FOUR ENGINES SMOOTH. APPLY MODELING PUTTY IF NECESSARY TO THE SEAM AND SAND AGAIN. PRIMER THESE AREAS AND CHECK SEAM. RETOUCH PUTTY AND SANDING IF NECESSARY.

8 THRUSTER ASSEMBLY

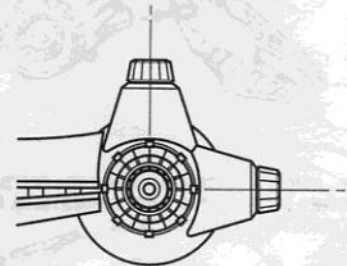
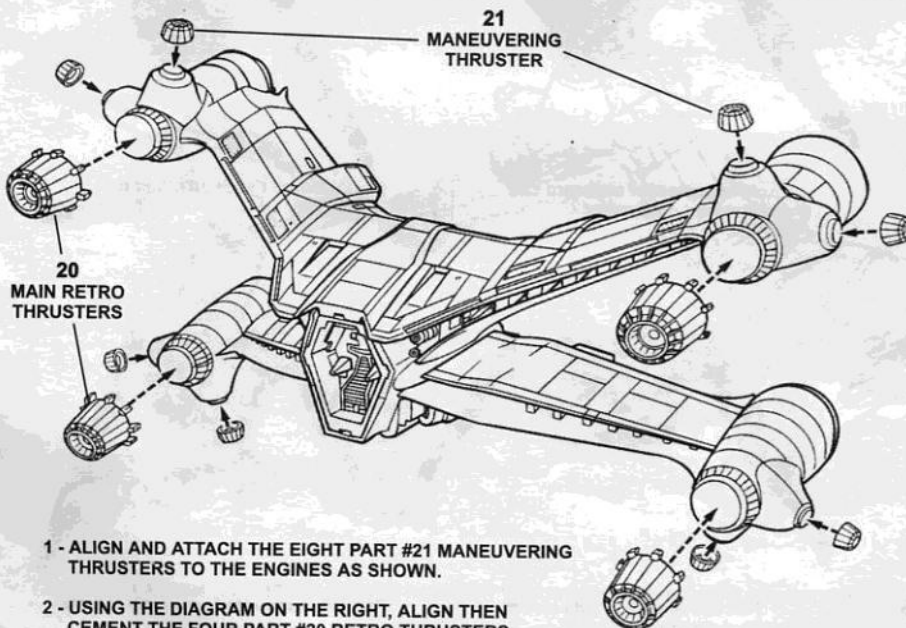

Main Retro Thruster alignment

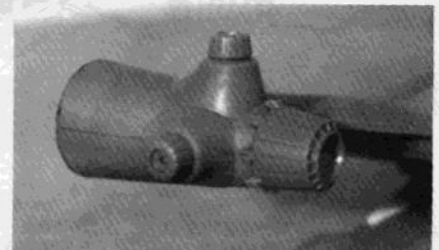

The maneuvering and retro thrusters are attached to the topside starboard engine.

- 1 - ALIGN AND ATTACH THE EIGHT PART #21 MANEUVERING THRUSTERS TO THE ENGINES AS SHOWN.
- 2 - USING THE DIAGRAM ON THE RIGHT, ALIGN THEN CEMENT THE FOUR PART #20 RETRO THRUSTERS TO THE FORWARD ENDS OF EACH ENGINE.

9

LOWER WEAPON ASSEMBLY

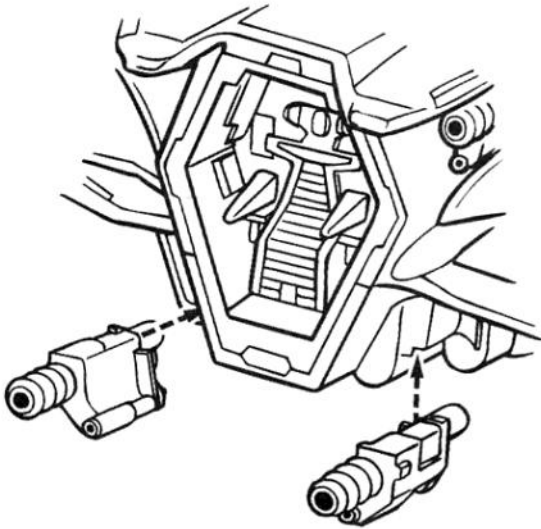

ALIGN PARTS #15 AND #16 LOWER WEAPONS USING PHOTOS HERE AND CEMENT IN PLACE.

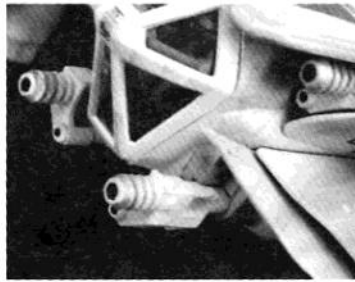

The portside lower weapon is attached to the completed assembly from step 8. Note connection of aft gun to hull.

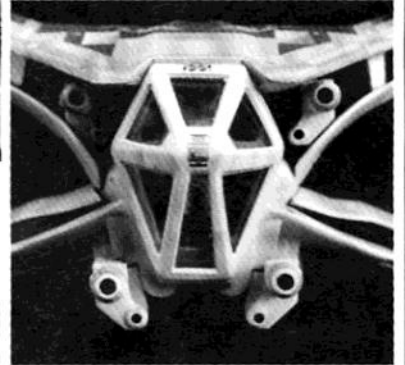

All four 40mm Plasma Pulse Discharge Cannons are shown aligned and attached.

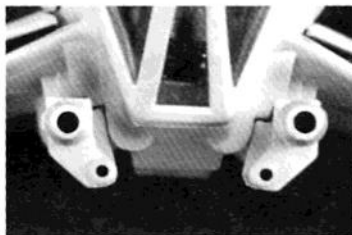

Both weapons are shown here attached to hull. Note connection of lower weapon to the 'step' on the hull.

10

TINES ASSEMBLY

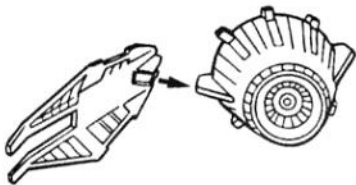

1 - ALIGN AND CEMENT PART #24 OUTBOARD TINES TO PART #19 MAIN THRUSTERS. REPEAT THIS STEP FOUR TIMES.

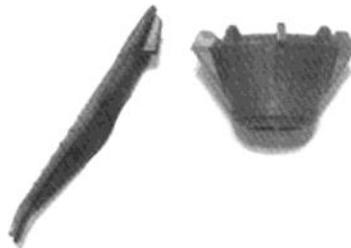

Note alignment of outboard tine with mount on thruster.



Outboard tine is attached to thruster.

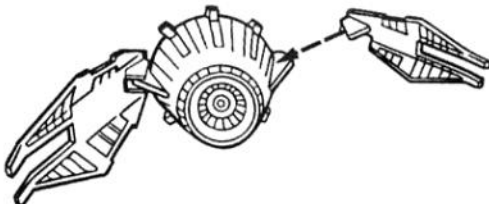

2 - ALIGN AND CEMENT PART #25 INBOARD TINES TO PART #19 MAIN THRUSTERS. REPEAT THIS STEP ONE TIME. ALSO, REPEAT THIS STEP USING PART #28 INBOARD TINES TWO TIMES.



Part #25 is aligned with mount on main thruster.



Part #28 is mounted onto main thruster.

11

PAINTING PREPARATION

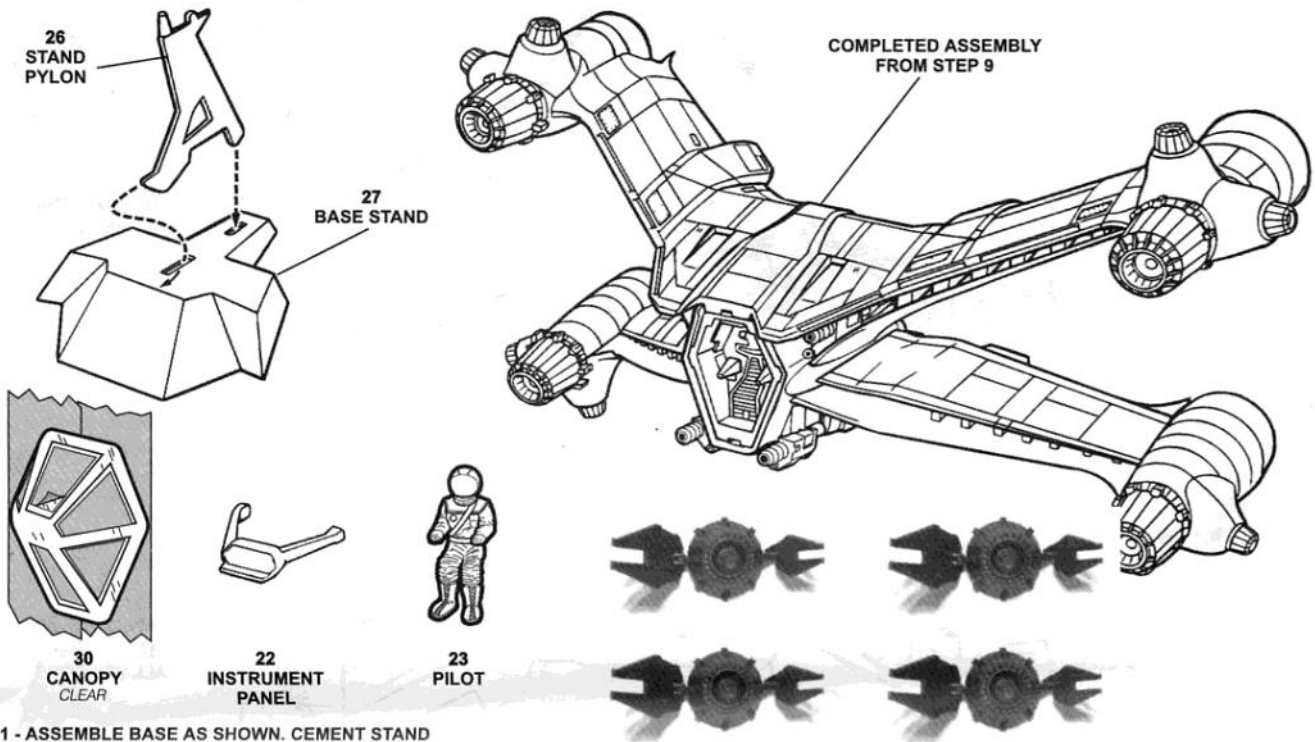

1 - ASSEMBLE BASE AS SHOWN. CEMENT STAND PYLON TO BASE STAND.

2 - MASK THE WINDOWS ON PART #30 CLEAR CANOPY AS SHOWN. ALSO MASK THE BACK SIDE OF THE CANOPY.

The Aft Thruster/Tines assemblies.

3 - PRIMER THE ASSEMBLED BASE, MASKED CANOPY, PART #22 INSTRUMENT PANEL, PART #23 PILOT, ASSEMBLED STARFURY FROM STEP 9, AND AFT THRUSTERS/TINES ASSEMBLY FROM STEP 10.

12

INITIAL PAINTING

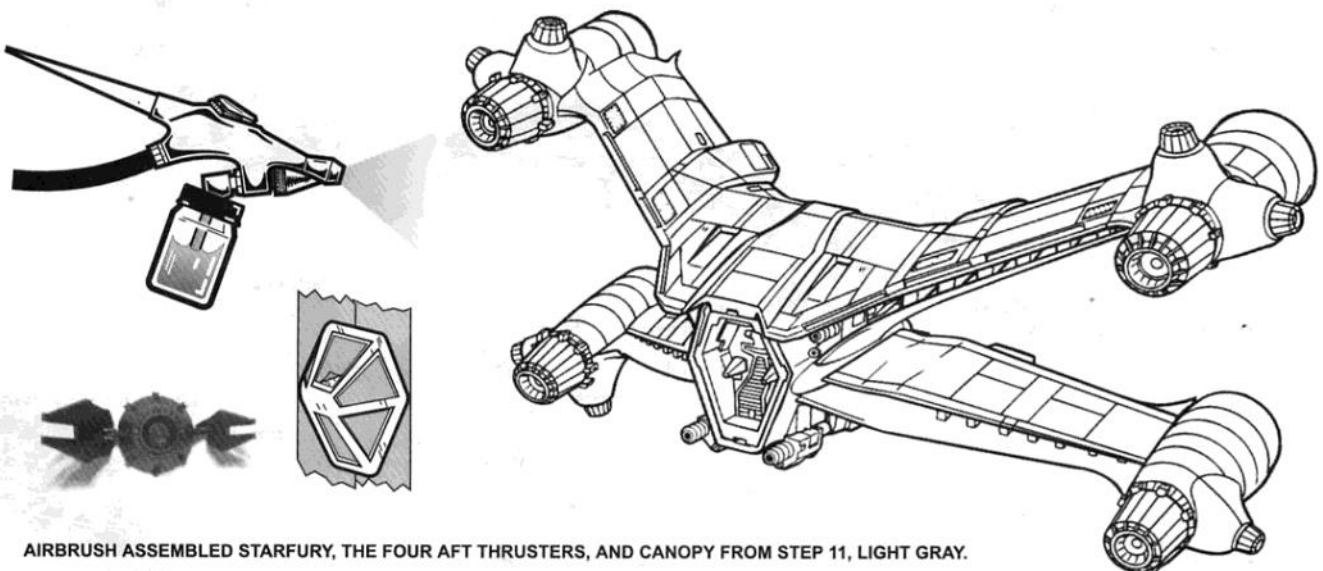

AIRBRUSH ASSEMBLED STARFURY, THE FOUR AFT THRUSTERS, AND CANOPY FROM STEP 11, LIGHT GRAY.

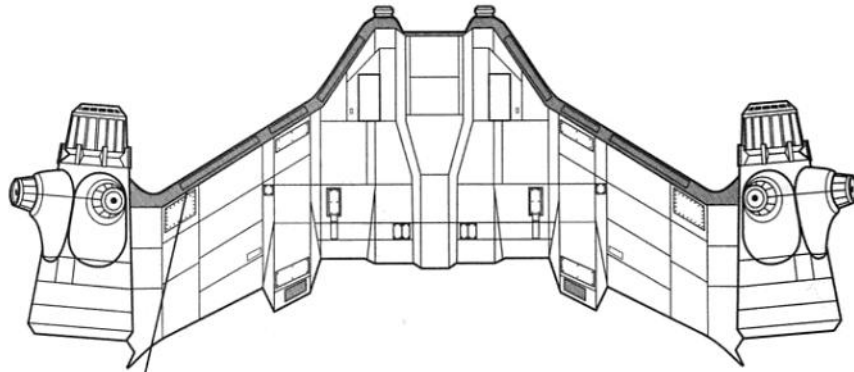

Top Wing Plan
ALL VERSIONS

1 - PAINT THE SHADED AREA ON THE LEADING EDGE OF THE TOP AND INNER TOP WING MEDIUM GRAY AS SHOWN.

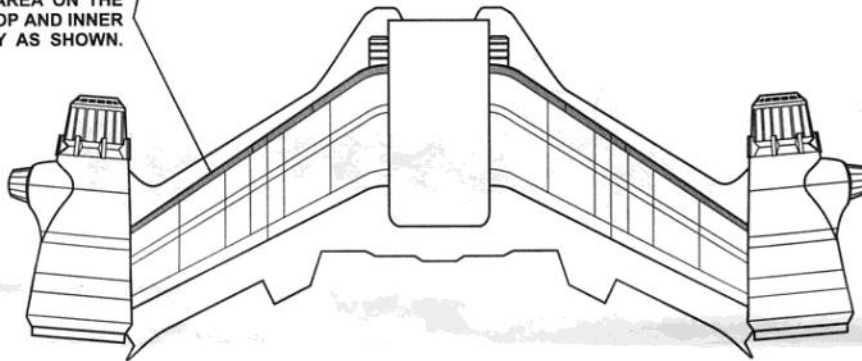

Underside Top Wing Plan
ALL VERSIONS

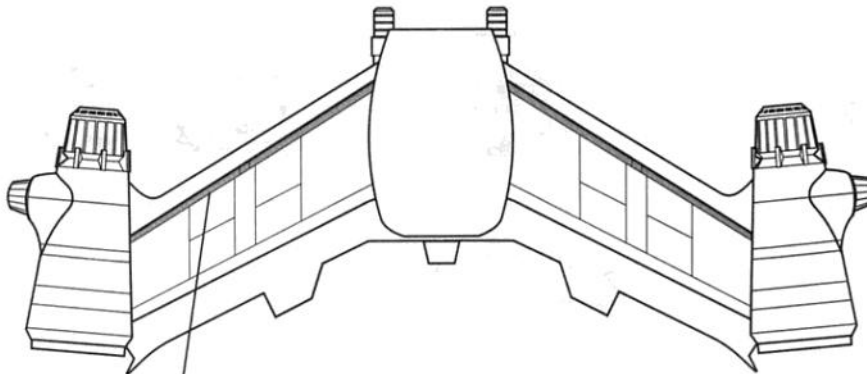

Topside Bottom Wing Plan
ALL VERSIONS

2 - PAINT THE SHADED AREA ON THE LEADING EDGE OF THE BOTTOM AND INNER BOTTOM WING MEDIUM GRAY AS SHOWN.

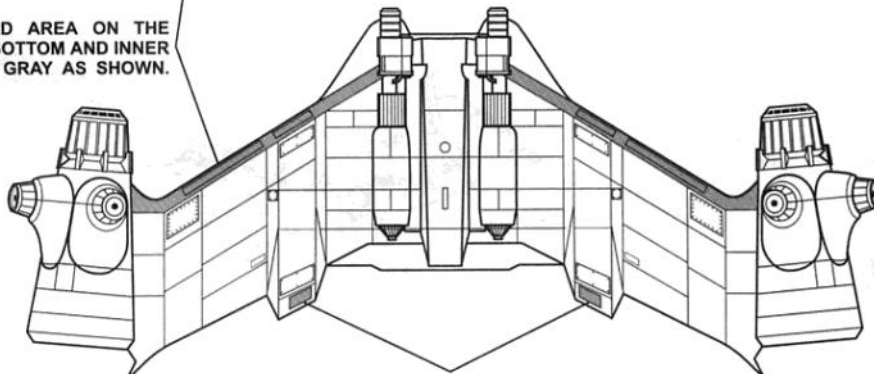

Bottom Wing Plan
ALL VERSIONS

3 - PAINT THE SHADED AREAS OF THE ECM FAIRINGS ON THE TOP AND BOTTOM WINGS MEDIUM GRAY AS SHOWN.

14

THRUSTERS/TINES PAINTING



PAINING TIP: THE OPTIONAL PAINTING DETAIL TIPS SHOWN HERE WILL GREATLY ENHANCE THE APPEARANCE AND ACCURACY OF YOUR FINISHED MODEL.

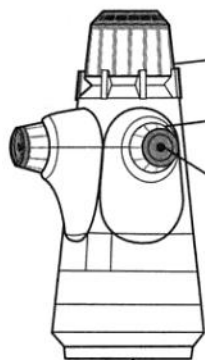

- 1 - PAINT THE RETRO THRUSTERS AS SHOWN WITH MEDIUM GRAY.
- 2 - PAINT THE EIGHT MANEUVERING THRUSTERS WITH MEDIUM GRAY AS SHOWN.
- 3 - PAINT THE SMALLEST RECESSED CIRCLE INSIDE OF EACH MANEUVERING, RETRO, AND AFT THRUSTER FLAT BLACK.

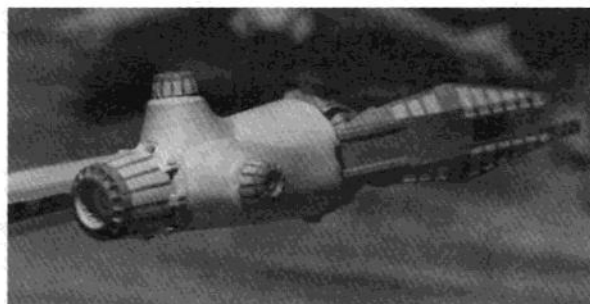

The completed port upper engine with aft thruster and tines attached.

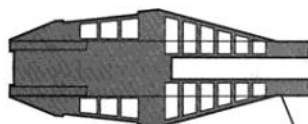
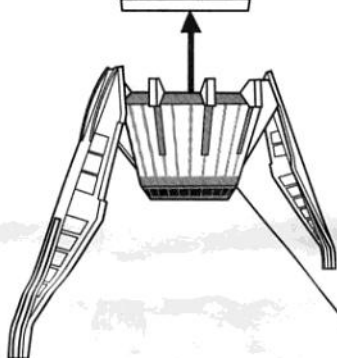

OUTBOARD TINE

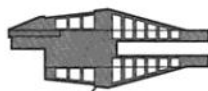

#25

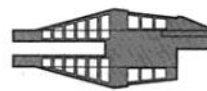

#28

INBOARD TINES

4 - PAINT BOTH SIDES OF THE INBOARD AND OUTBOARD TINES MEDIUM GRAY AS SHOWN BY THE SHADED AREAS.

5 - WITH MEDIUM GRAY, PAINT THE AFT THRUSTER AS SHOWN ACCORDING TO THE SHADED AREAS.

15

AFT THRUSTERS ASSEMBLY

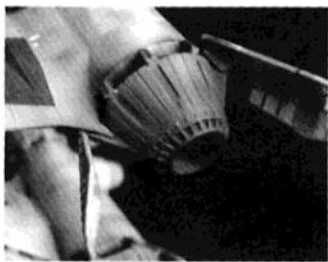

The upper starboard engine with tine and aft thruster attached.

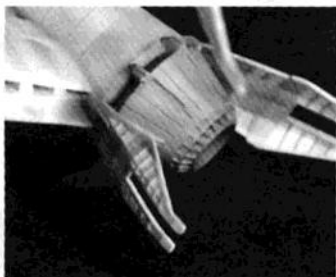

A close up of the lower starboard engine showing the tine and wing intersection.

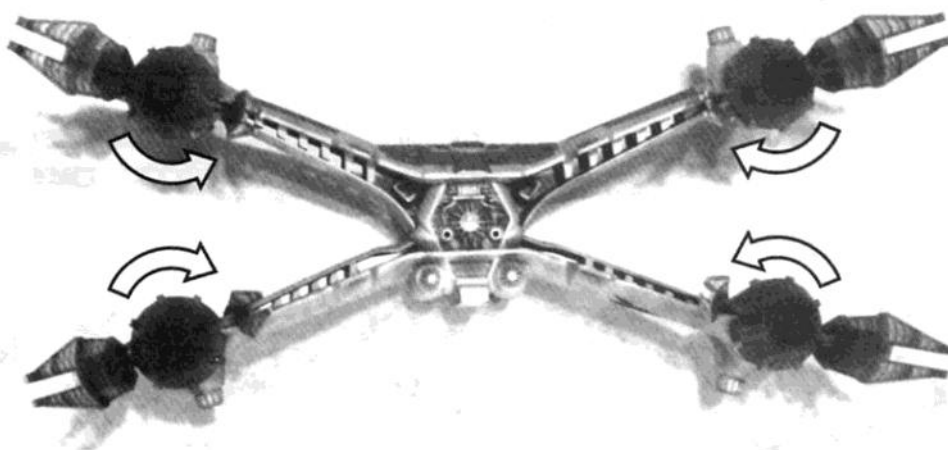

ALIGN THE AFT THRUSTERS WITH THE AFT END OF EACH ENGINE. USE THE TWO THRUSTERS WITH INBOARD SMALL TINES #25 ON THE UPPER LEFT AND LOWER RIGHT ENGINES. AFTER APPLYING CEMENT TO THE JOINT, TURN THE THRUSTER ASSEMBLY IN THE DIRECTION AS INDICATED UNTIL THE BASE OF THE INBOARD TINE STOPS AGAINST THE SMALL WING PROTRUSION.



PAINTING TIP: THIS STEP IS OPTIONAL. HOWEVER, YOU MAY WEATHER YOUR STARFURY AS DESCRIBED HERE FOR AN AUTHENTIC APPEARANCE. FOLLOW THIS STEP CAREFULLY, AND WITH SOME PRACTICE ON ANOTHER OBJECT OR FLAT SURFACE, YOUR STARFURY CAN BE BEAUTIFULLY DETAILED.

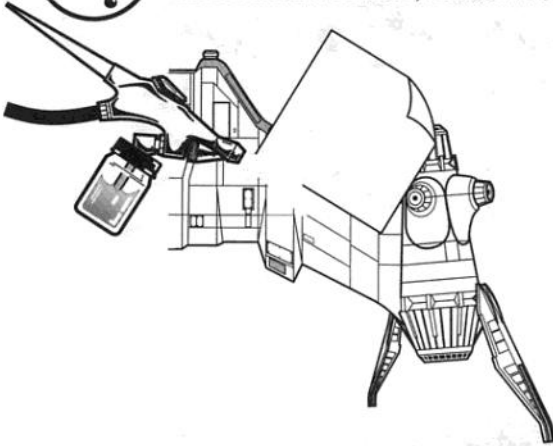

Unweathered

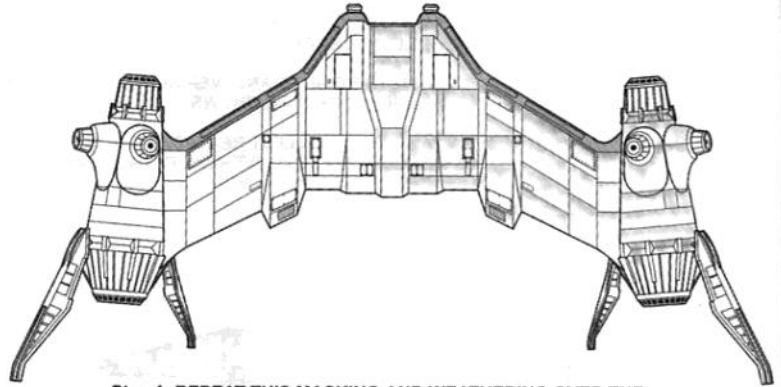

Weathered

Mask an area forward of any panel line with tape, or any removable note paper. LIGHTLY mist Dark Gray at the edge of the masking. Pull the masking up to reveal a sharp edge along the panel line and the weathering fading off aft of the line.

Step 1: REPEAT THIS MASKING AND WEATHERING OVER THE ENTIRE SURFACE ON THE TOP, INNER AND BOTTOM WINGS. START AT THE REAR OF THE MODEL AND MOVE FORWARD WITH THE WEATHERING.

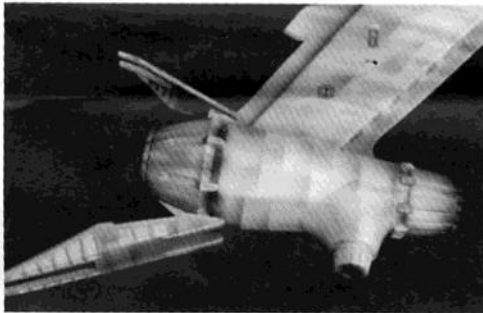

With your airbrush set for a fine line, paint 'streaks' onto the entire hull and canopy. Start at the front of the model and spray towards the back. The amount of the weathering applied is up to you. Use the photos and illustrations here for detailing reference.

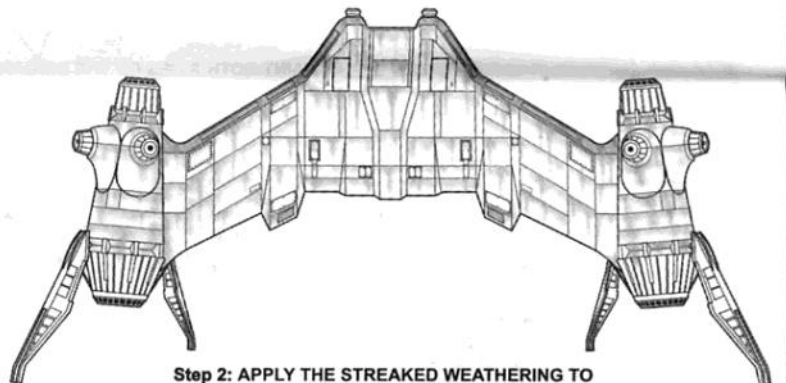

Step 2: APPLY THE STREAKED WEATHERING TO THE ENTIRE TOP, BOTTOM, AND INNER WINGS.



WITH ALL MASKING STILL ATTACHED, WEATHER CANOPY AS SHOWN. DO NOT REMOVE MASKING UNTIL THE FINAL STEP OF THESE INSTRUCTIONS.

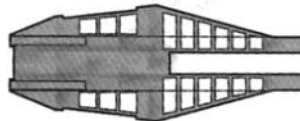

APPLY WEATHERING TO THE TINES AS DESCRIBED ABOVE.

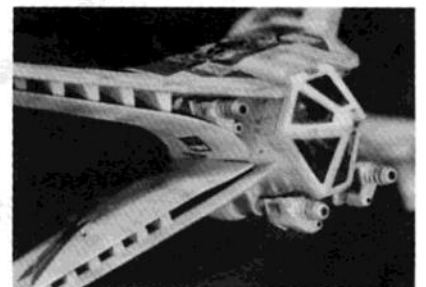
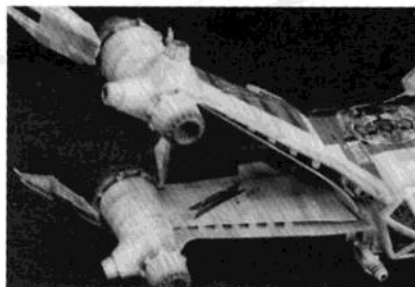
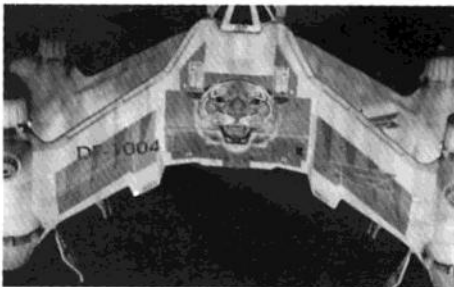

17

COCKPIT AND PILOT PAINTING

5 - PAINT THE 7 RAISED PANELS ON EACH SIDE OF THE COCKPIT WALLS, THE BACK WALL AND ON THE CEILING JET EXHAUST.

1 - PAINT THE LIGHT SHADED AREA OF THE COCKPIT GRAY GREEN.

2 - MIX A SMALL AMOUNT OF BLACK INTO THE GRAY GREEN PAINT. PAINT THE CHAIR AND ARM RESTS WITH THIS COLOR.

3 - PAINT THE RAISED PADDING ON THE CHAIR TAN.

4 - PAINT THIS TANK YELLOW.

6 - MIX A SMALL AMOUNT OF WHITE INTO THE GRAY GREEN PAINT UNTIL IT IS A SLIGHTLY LIGHTER SHADE. PAINT THE 2 DIAGONAL 'BEAMS' ON EITHER SIDE OF THE CHAIR WITH THIS COLOR.

DECAL 45

(DECAL 46 OTHER SIDE)

DECAL 47

(DECAL 48 OTHER SIDE)



7 - PAINT THE 'HEADREST PADS' DARK GRAY.

8 - PAINT THIS TANK BLUE.

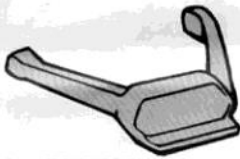
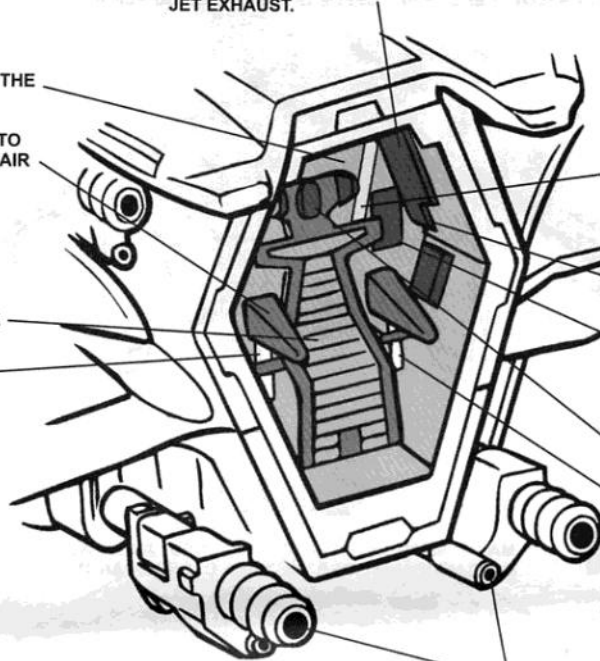

10 - PAINT THE DRILLED HOLES IN THE TIPS OF EACH GUN WITH FLAT BLACK. ALSO PAINT THE TWO GUN HOLES IN BACK OF THE FUSELAGE FLAT BLACK.

11 - PAINT THE INSTRUMENT PANEL GRAY GREEN.

5 - PAINT THE SHOULDER PAD JET EXHAUST.

6 - PAINT THE FLIGHT SUIT NEUTRAL GRAY.

7 - PAINT THE PILOT'S GLOVES AND BOOTS FLAT BLACK.

1 - PAINT THE PILOT'S HELMET JET EXHAUST.

2 - PAINT THE HELMET'S VISOR FLAT BLACK.

3 - PAINT THE COLLAR SILVER.

4 - PAINT THE PILOT'S LEFT AND RIGHT UPPER ARM PADS, SASH AND BELT DARK GRAY.



WHEN COMPLETED WITH THE PAINTING IN THIS STEP, SPRAY THE ENTIRE ASSEMBLED MODEL, CANOPY, PILOT AND INSTRUMENT PANEL WITH A CLEAR GLOSS. ALLOW TO COMPLETELY DRY. APPLY DECALS TO COCKPIT AS SHOWN BEFORE PROCEEDING TO NEXT STEP.

18

CUSTOM VERSION PAINTING



AT THIS POINT YOU MUST DECIDE ON WHICH VERSION YOU WOULD LIKE TO EXECUTE. IF YOU CHOOSE TO MAKE SHERIDAN'S FLYING TIGER, MITCHELL'S STARFURY, SINCLAIR'S RED CHEVRON OR LINE FIGHTER, PROCEED TO STEP 19 FOR DECALING THESE VERSIONS. FOR GARIBALDI'S OR THE DELTA 7 VERSION, FOLLOW THE ADDITIONAL PAINTING INSTRUCTIONS BELOW BEFORE PROCEEDING WITH DECAL APPLICATION.

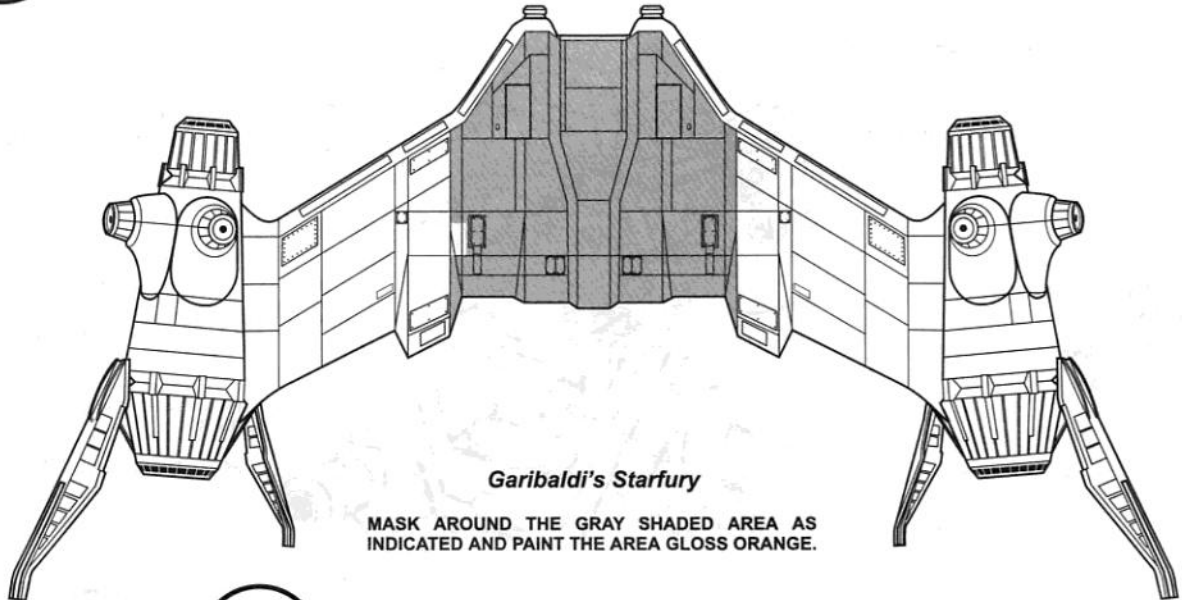

Garibaldi's Starfury

MASK AROUND THE GRAY SHADED AREA AS INDICATED AND PAINT THE AREA GLOSS ORANGE.



PAINTING TIP: YOU MAY WISH TO REAPPLY THE STREAKED WEATHERING WITH DARK GRAY ON TOP OF THE ORANGE.

PAINT THE DARK GRAY SHADED AREA FIELD GREEN.

MASK AND PAINT THE WHITE STRIPES ON EITHER SIDE OF THE GREEN WITH WHITE.

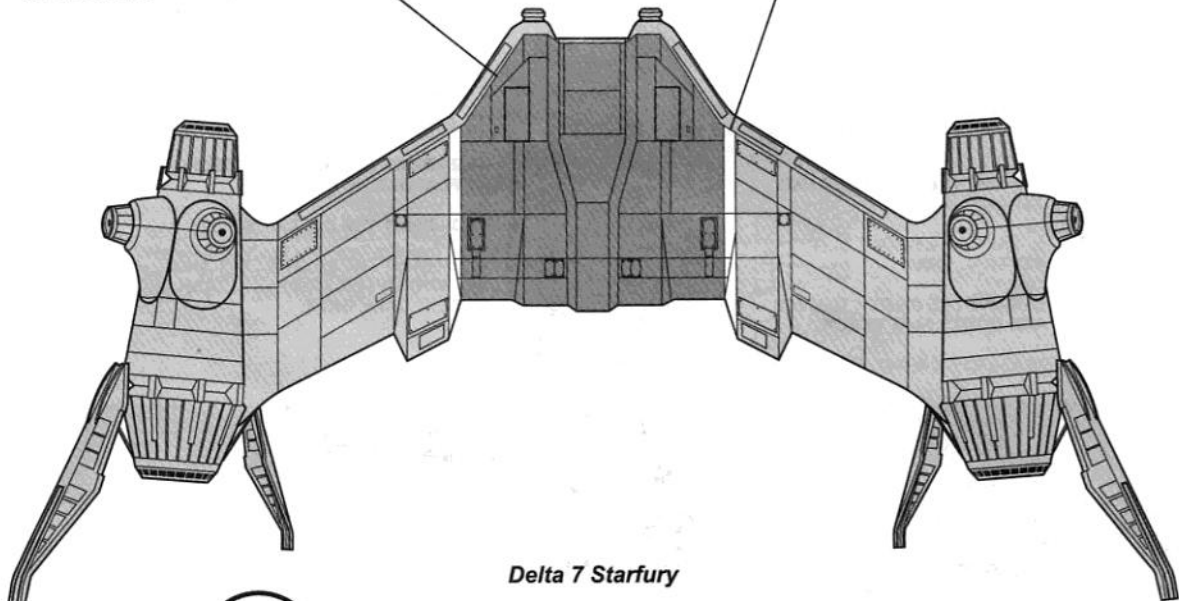

Delta 7 Starfury



PAINTING TIP: YOU MAY WISH TO REAPPLY THE STREAKED WEATHERING WITH DARK GRAY ON TOP OF THE ORANGE.

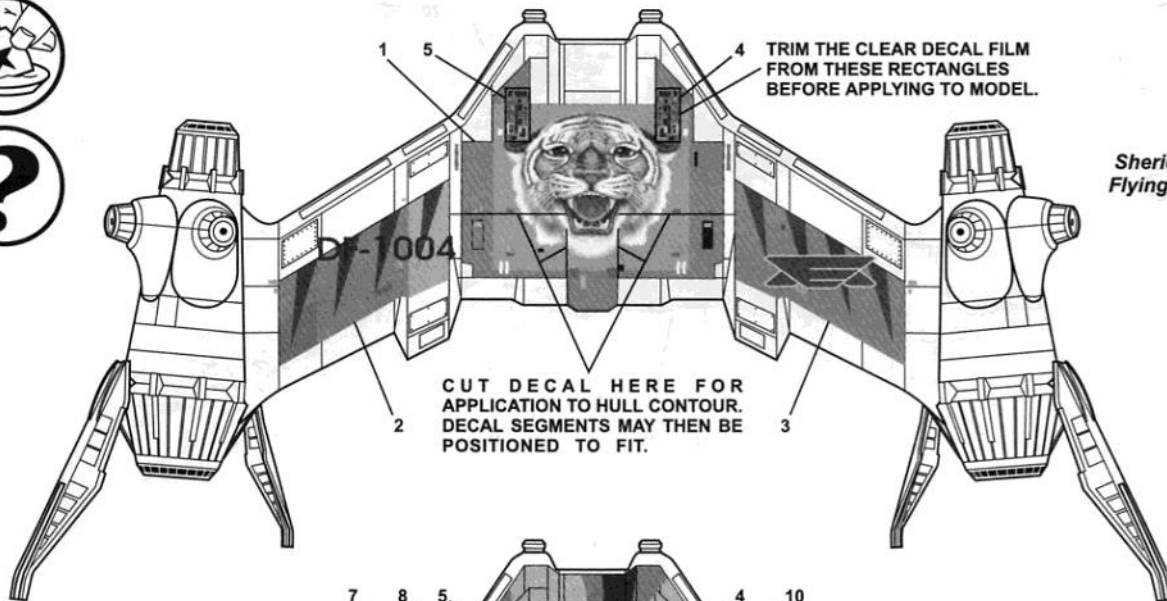

Sheridan's Flying Tiger

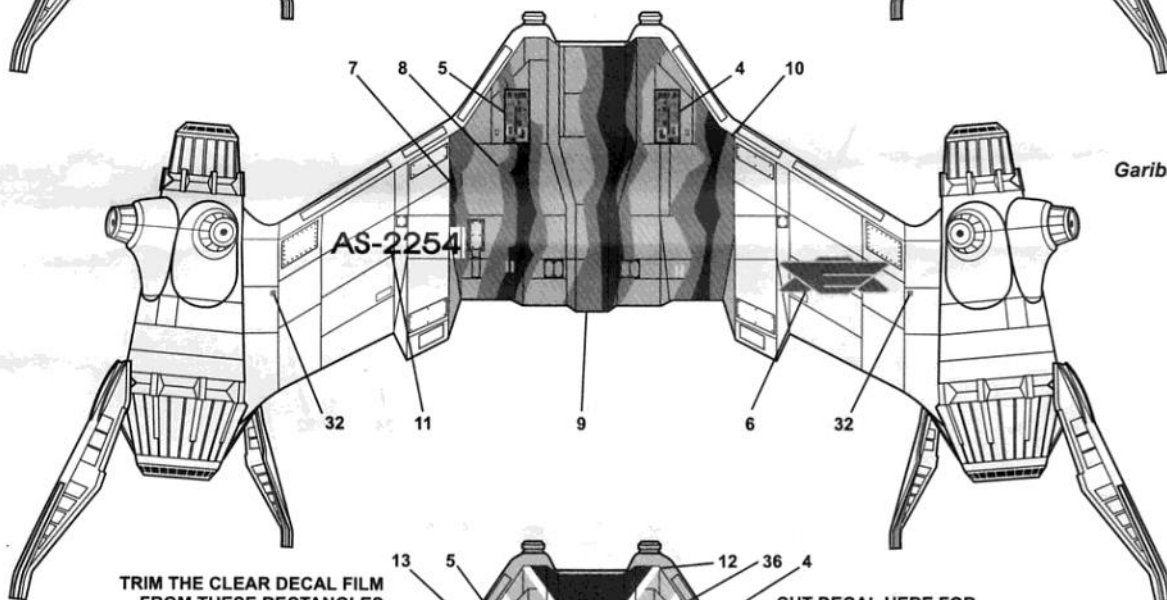

Garibaldi's

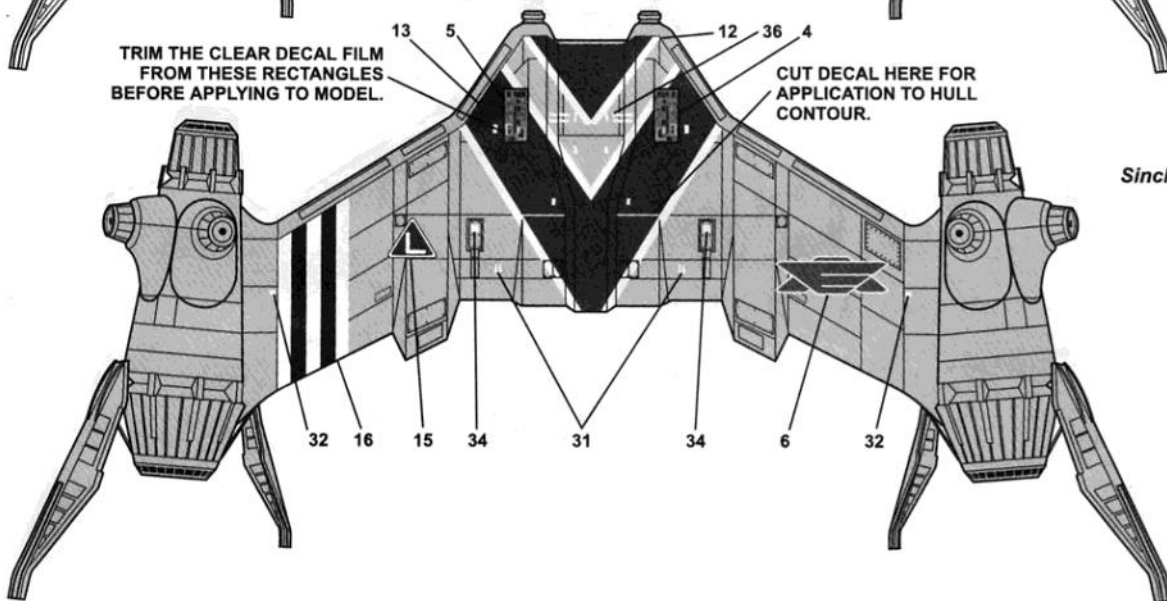

Sinclair's

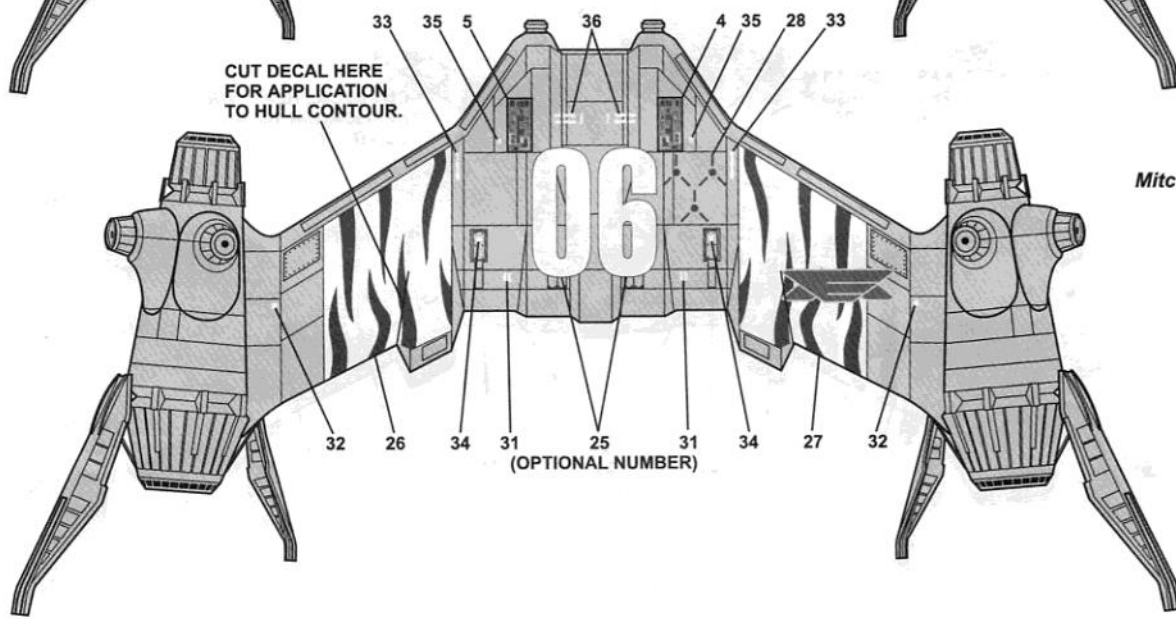
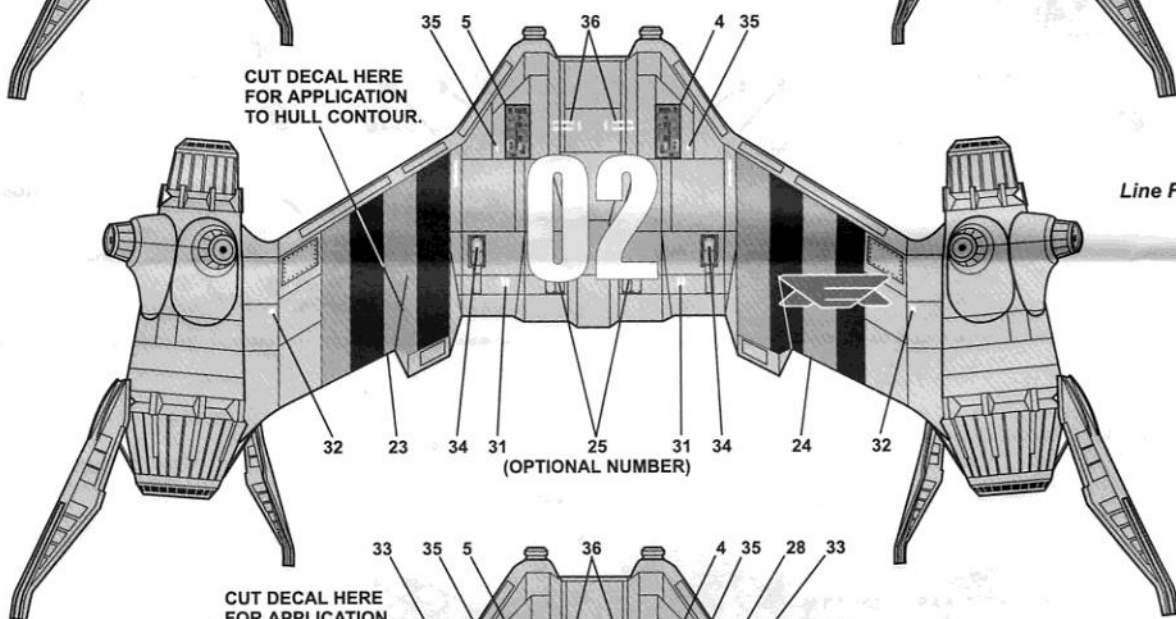
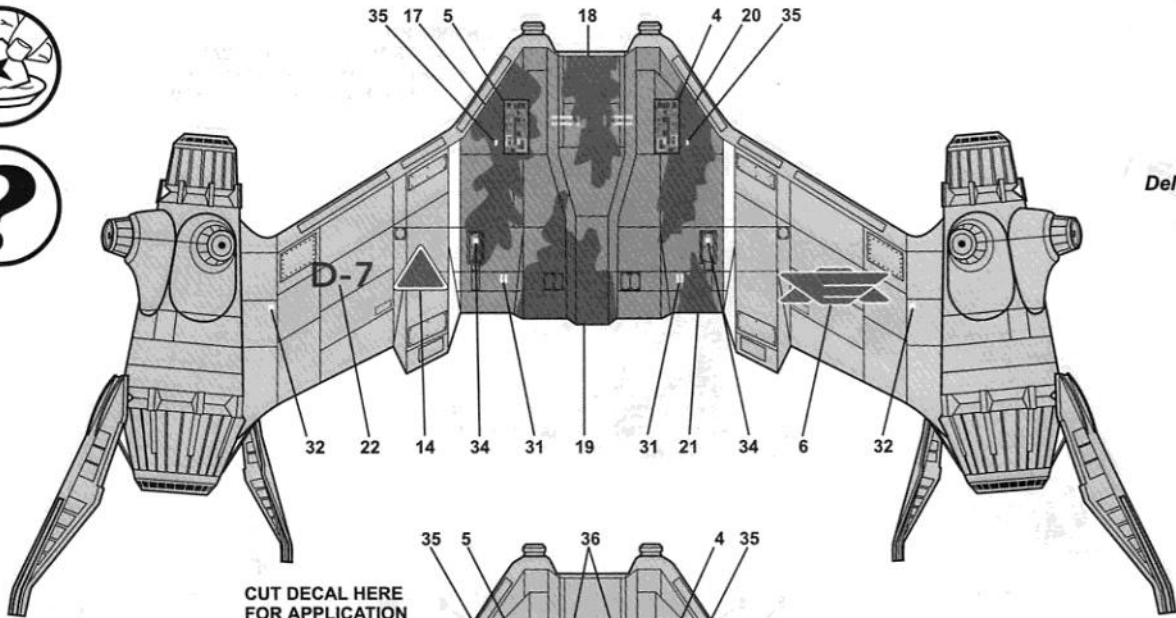

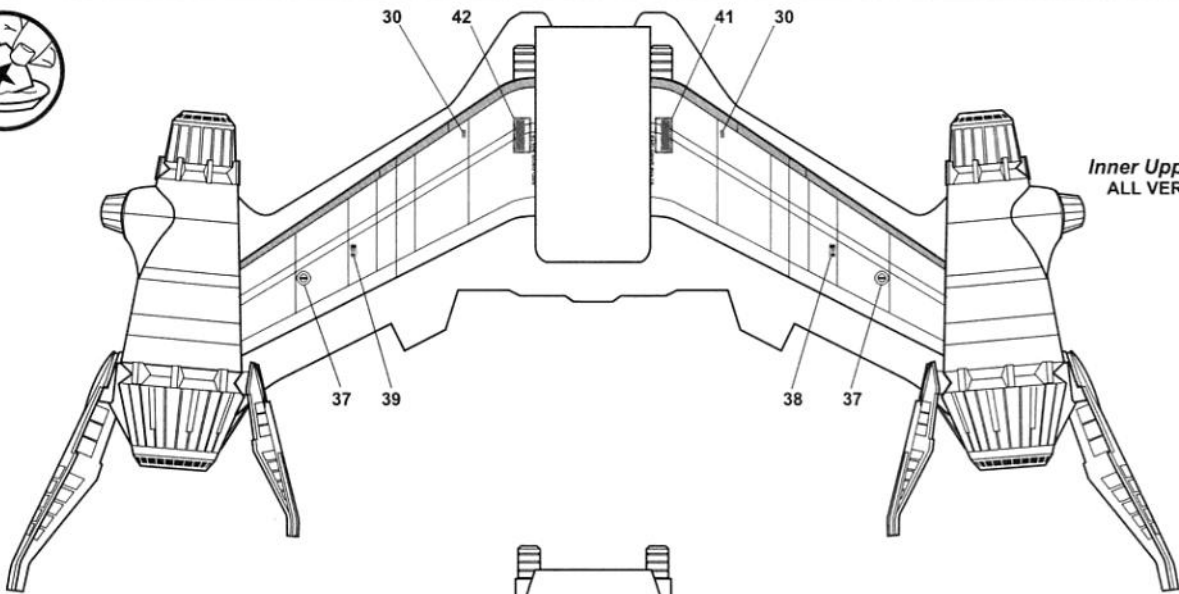

Inner Upper Wing
ALL VERSIONS

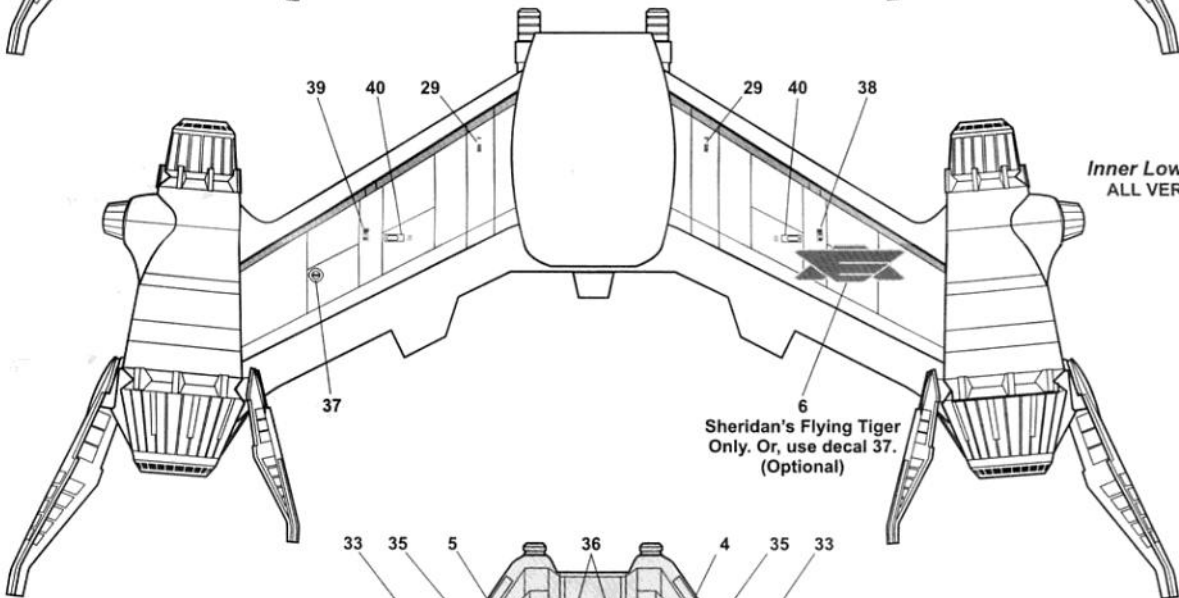

Inner Lower Wing
ALL VERSIONS

Sheridan's Flying Tiger
Only. Or, use decal 37.
(Optional)

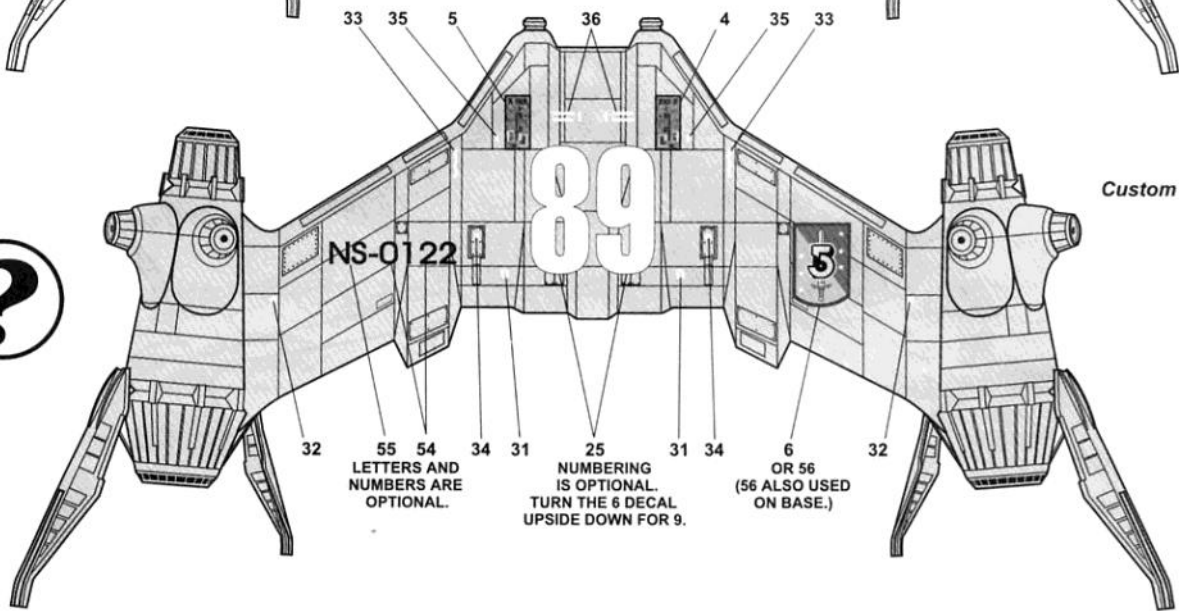

Custom Starfury



NS-0122

89

5

LETTERS AND
NUMBERS ARE
OPTIONAL.

NUMBERING
IS OPTIONAL.
TURN THE 6 DECAL
UPSIDE DOWN FOR 9.

OR 56
(56 ALSO USED
ON BASE.)

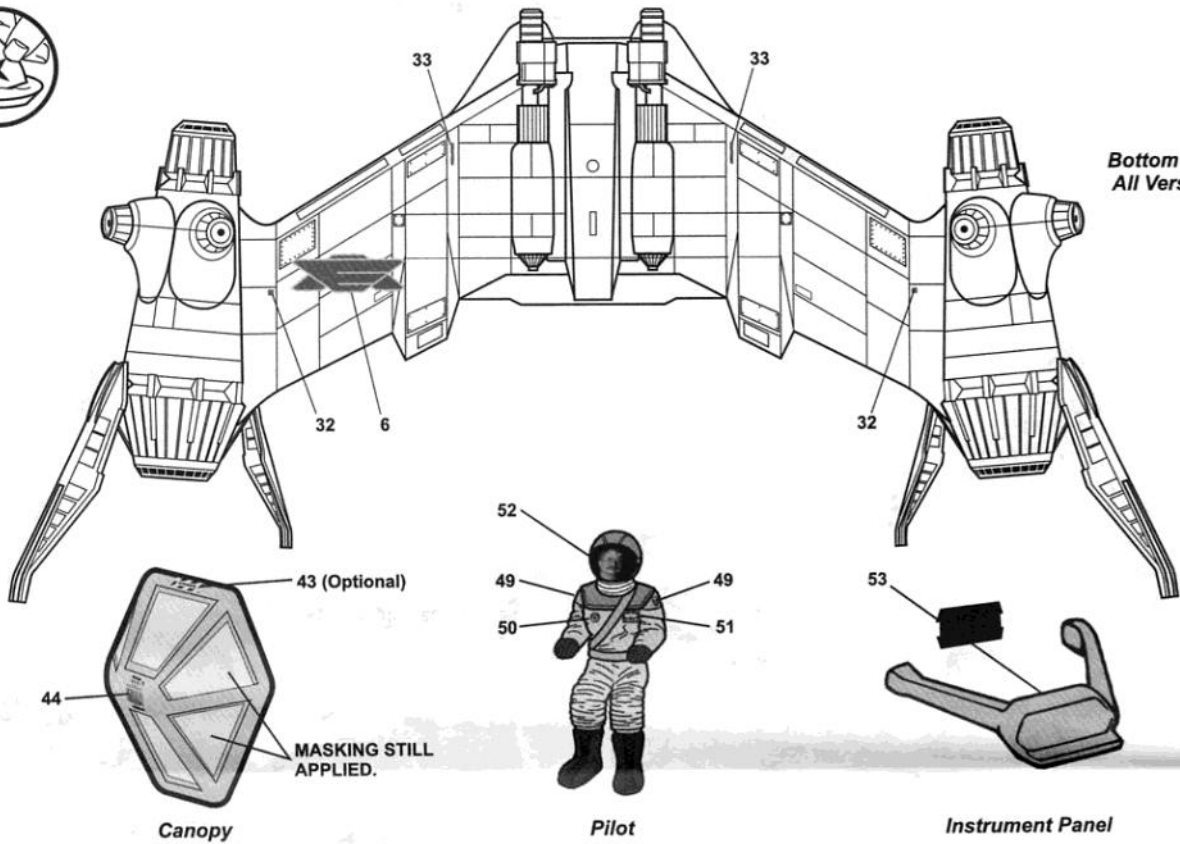

1 - ALLOW DECALS TO COMPLETELY DRY BEFORE PROCEEDING.

2 - SPRAY A FLAT FINISH ON COMPLETED STARFURY, CANOPY, PILOT AND INSTRUMENT PANEL.

3 - CEMENT PILOT INTO COCKPIT. CEMENT INSTRUMENT PANEL ACROSS COCKPIT AS SHOWN.

4 - CAREFULLY REMOVE MASKING FROM CANOPY.

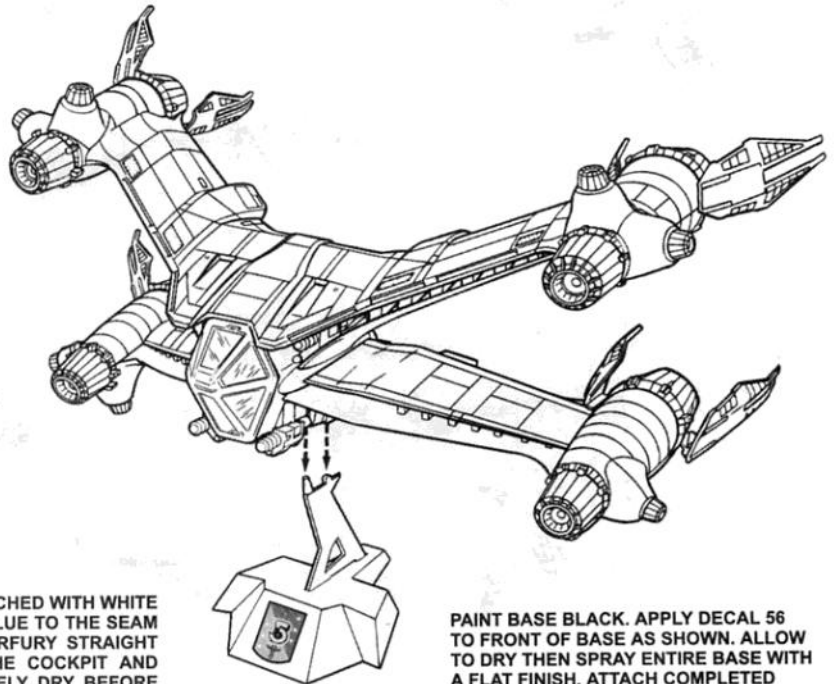
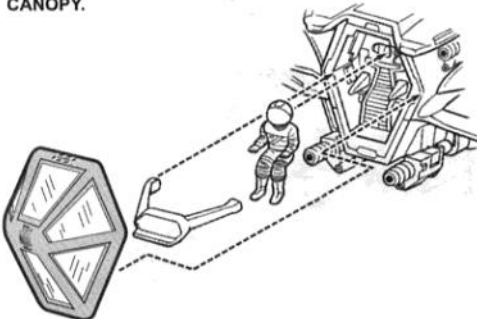

MODELING TIP: CANOPY CAN BE ATTACHED WITH WHITE GLUE. APPLY A SMALL AMOUNT OF GLUE TO THE SEAM AROUND THE COCKPIT. TIP THE STARFURY STRAIGHT UP AND ALIGN THE CANOPY TO THE COCKPIT AND SET IN PLACE. ALLOW TO COMPLETELY DRY BEFORE HANDLING.

PAINT BASE BLACK. APPLY DECAL 56 TO FRONT OF BASE AS SHOWN. ALLOW TO DRY THEN SPRAY ENTIRE BASE WITH A FLAT FINISH. ATTACH COMPLETED STARFURY AS SHOWN.